

Arn View

Warminster, BA12 8TN

COOPER
AND
TANNER



£205,000 Freehold

🛏️ 2 🛋️ 1 🚿 1 EPC D

Description

A well presented two bedroom mid terrace property which would be an ideal first time buy or investment purchase. The property is a tucked away location with an allocated parking space and gardens to the front and rear. In brief the accommodation comprises entrance porch which leads into the sitting room with stairs rising to the first floor and a wood burning stove, kitchen/diner with a range of fitted wall and base units with integrated oven and hob and a door into the conservatory with access to the garden. To the first floor there are two bedrooms and a shower room. Internal viewing comes highly recommended.

Arn View, Warminster, BA12

Approximate Area = 722 sq ft / 67.1 sq m

For identification only - Not to scale

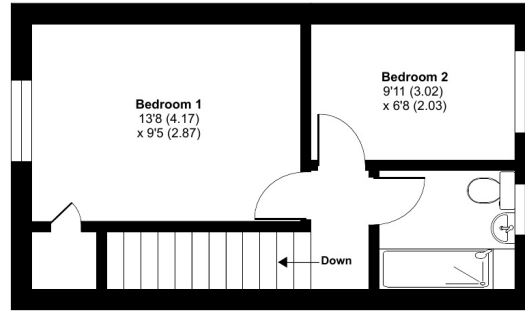

FIRST FLOOR

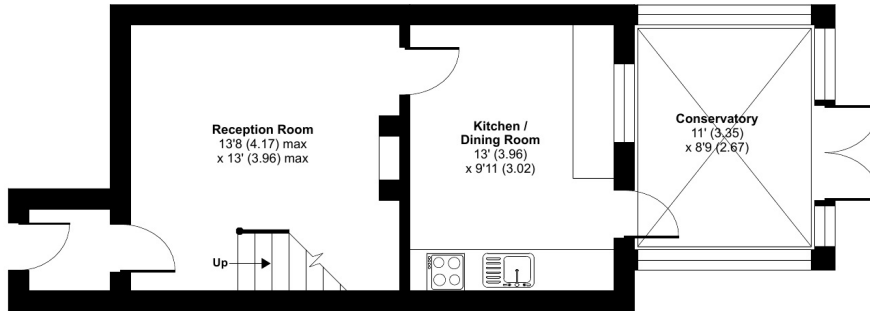

GROUND FLOOR



Floor plan produced in accordance with RICS Property Measurement Standards incorporating International Property Measurement Standards (IPMS2 Residential). © nichecom 2023. Produced for Cooper and Tanner. REF: 990785



Features

- Super first time buy or investment purchase
- Tucked away location
- Overlooking the green to the front
- Allocated parking
- Gardens to the front and rear
- Sitting room
- Kitchen/diner
- Conservatory
- Two bedrooms
- Shower room

Local Information

- Council Tax Band B
- Tenure Freehold
- EPC Rating D

WARMINSTER OFFICE

Telephone 01985 215579

48-50, Market Place, Warminster, Wiltshire BA12 9AN

warminster@cooperandtanner.co.uk

**COOPER
AND
TANNER**

Important Notice: These particulars are set out as a general outline only for the guidance of intended purchasers and do not constitute, nor constitute part of, an offer or contract. All descriptions, dimensions, reference to condition and necessary permissions for use and occupation, warranties and other details are given without responsibility and any intending purchasers should not rely on the m as statements or representations of fact but must satisfy themselves by inspection or otherwise as to the correctness of each of them.

