



Heath Drive



Heath Drive Worcester

£385,000

Situated within the popular residential location of St Peters is this well presented detached family home offering good access to local amenities as well as M5 motorway. The property comprises of hallway, sitting room, kitchen, ground floor study/bedroom as well as WC. To the first floor are three bedrooms as well as family bathroom. The property also benefits from an integral garage with up and over door, lighting and power. Outside there is a driveway with parking for two cars and a pleasant rear garden. A viewing is highly advised to appreciate the finish of the property.

We've Noticed

- Well presented detached family home
- Three bedrooms
- Driveway & garage
- Ground floor study/bedroom 4
- Must be viewed!



Entrance

Through front entrance door into hallway with stairs to first floor, radiator and doors into sitting room, kitchen/diner, WC, storage cupboards and study/bedroom 4.

Sitting Room

With column radiator and rear aspect double glazed double doors opening and overlooking the rear garden.

Kitchen

With rear aspect double glazed windows, matching wall and base units with work surfaces over, stainless steel double sink and drainer with mixer tap over, space for cooker as well as further space and plumbing for washing machine. Space for dining table and door into garage as well as further door leading outside.

WC

With front aspect double glazed window, heated towel rail, WC and wash hand basin.

Study/Bedroom 4

With front aspect double glazed window and radiator.

First Floor Landing

With front aspect double glazed window, doors into storage cupboard housing hot water cylinder, bedrooms one, two, three and bathroom.

Bedroom 1

With front aspect double glazed window, radiator and door into family bathroom.

Bedroom 2

With rear aspect double glazed window and radiator.

Bedroom 3

Currently used as a dressing room with front aspect double glazed and radiator.

Bathroom

With front aspect double glazed window, free standing bath, shower cubicle with shower, wash hand basin, heated towel rail and WC.

Garage

With up and over door, lighting and power.

Outside

The front of the property is approached via a driveway leading to up and garage with up and over door as well as secure gated side access. The rear garden is laid to a mixture of patio and lawn with herbaceous shrubs and plant bordering the garden with fenced boundaries to sides and rear.



Heath Drive, Worcester, WR5

Approximate Area = 1058 sq ft / 98.2 sq m

Garage = 103 sq ft / 9.5 sq m

Total = 1161 sq ft / 107.7 sq m

For identification only - Not to scale

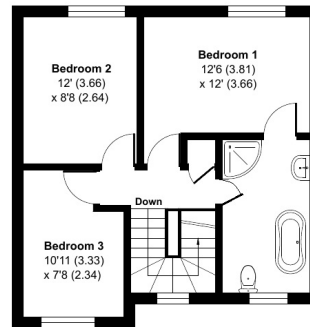

FIRST FLOOR

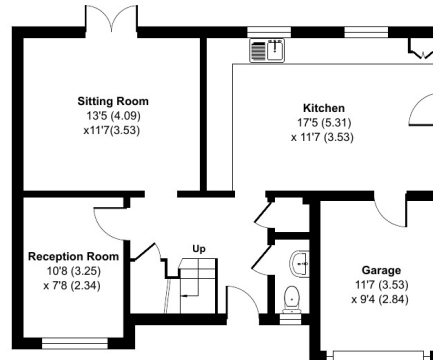
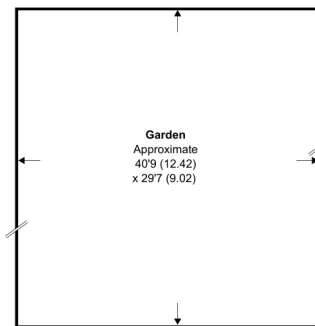

GROUND FLOOR



Floor plan produced in accordance with RICS Property Measurement Standards incorporating International Property Measurement Standards (IPMS2 Residential). © nchecom 2024. Produced for Hills Estate Agents. REF:1094617

46 Foregate Street, Worcester WR1 1EE

Tel: 01905 723545 info@hillsestateagents.co.uk

www.hillsestateagents.co.uk

These particulars, whilst believed to be accurate are set out as a general outline only for guidance and do not constitute any part of an offer or contract. Intending purchasers should not rely on them as statements or representation of fact, but must satisfy themselves by inspection or otherwise as to their accuracy. We have not carried out a detailed survey nor tested the services, appliances and specific fittings. Room sizes should not be relied upon for carpets and furnishings. The measurements given are approximate. No person in this firm's employment has the authority to make or give any representation or warranty in respect of the property.

