

Atlanta, Park Estate, La Marquanderie, St Brelade. JE3 8EQ

£1,650,000 Freehold

FOR SALE



PROPERTY DESCRIPTION

****Luxury Modern Bungalow in Park Estate, St. Brelade****

Nestled in the prestigious Park Estate, just moments from St. Brelade's vibrant shops, restaurants, and the stunning bay, this beautifully designed modern bungalow offers an exceptional standard of living in a prime coastal location. Boasting four spacious bedrooms, including two with en-suite bathrooms, this property perfectly balances style and comfort. The highlight is the expansive chef's kitchen, fitted with the latest high-end Siemens and Bosch appliances, ideal for culinary enthusiasts. The separate, elegant lounge provides a tranquil space to relax, while both the kitchen and lounge open effortlessly onto a generous entertaining area—perfect for hosting guests. Additional features include a study, a well-equipped utility room, and underfloor heating throughout for year-round comfort. The outdoor space is equally impressive, with a private, mature garden offering peace and seclusion, along with a sparkling swimming pool for those warm summer days. With parking for up to five cars, this property combines convenience with luxury.

This is a rare opportunity to secure a dream home in one of St. Brelade's most desirable areas.

LOW RUNNING COSTS. PART EXCHANGE (for lower value property) CONSIDERED.

FEATURES

- Luxurious 1,700ft² detached bungalow in prime location
- Modern construction, low running costs and maintenance
- 4 bedrooms 2 with en-suite facilities
- Enclosed garden with sunny aspect and swimming pool
- Moments from St Brelade's Bay
- Close to all the Les Quennevias amenities,



ROOM DESCRIPTIONS

Exterior

Zoned space provides a low maintenance environment, from raised borders with feature specimen planting, quality slabbing and decking, plus a heated swimming pool, all accentuated by strategic lighting.

Directions

Travelling down La Marquanderie, turn left into Park Estate. Take 1st right, at roundabout Atlanta is on LHS.







FLOORPLAN

GROUND FLOOR
1748 sq.ft. (162.4 sq.m.) approx.

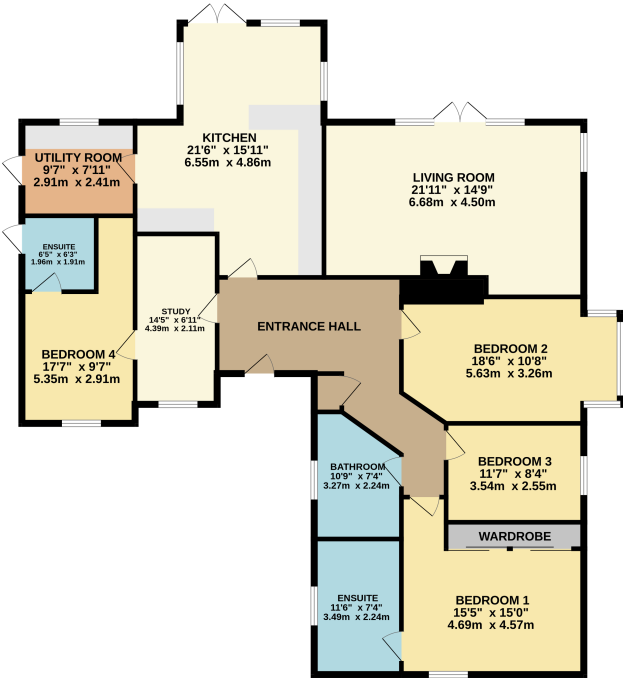

TOTAL FLOOR AREA: 1748 sq.ft. (162.4 sq.m.) approx.

Whilst every attempt has been made to ensure the accuracy of the floorplan contained herein, measurements of doors, windows, rooms and any other items are approximate and no responsibility is taken for any error, omission or mis-statement. This plan is for illustrative purposes only and should be used as such by any prospective purchaser. The fixtures, systems and appliances shown have not been tested and no guarantee as to their operability or efficiency can be given.
Made with Metropix ©2024