

FOR  
SALE



Stockbrook, Fownhope, Hereford HR1 4PS

£575,000 - Freehold

22, Broad Street, Hereford, HR4 9AP 01432 355455 [hereford@flintandcook.co.uk](mailto:hereford@flintandcook.co.uk)



## PROPERTY SUMMARY

An individually designed detached property, in a convenient and sought-after village location, 4 bedrooms, triple garage and attractive gardens.

This attractive modern detached house occupies a slightly elevated location within the heart of the highly favoured village of Fownhope, in a Conservation Area, and well placed for access to the cathedral city of Hereford (7 miles) and the market town of Ross-on-Wye (9 miles) and the M50 motorway link (jct 3).

Fownhope is a very well serviced village within which there is a shop/post office, butchers, doctors surgery, church, 2 public houses, an exclusive health and leisure complex (Wye Leisure), bus service, village hall and sports playing field, primary school and the property is also in the catchment area for Bishops secondary school.

Constructed in the mid 1970s, the property provides spacious and well planned accommodation (which extends to approximately 2025 sq ft), with oil central heating, replacement triple glazing, and is ideal for family purpose, having a large garage (with scope for conversion into a home office/studio/annexe etc - subject to planning), and there is a lovely garden, which is south facing to the rear.

## POINTS OF INTEREST

- *Individual detached house*
- *Convenient village location*
- *4 Bedrooms*
- *Close to amenities*
- *Triple garage*
- *Lovely garden*
- *Triple Glazing*
- *Viewing advised*



## ROOM DESCRIPTIONS

### **Recessed entrance porch**

Door leading to

### **Spacious reception hall**

Radiator, double glazed patio doors to a rear recessed canopy.

### **Large lounge**

Feature stonework, raised hearth, radiator, bow double glazed window, with sun canopy, to the rear, archway to

### **Dining room**

Radiator, window to side, double doors to the lean-to Garden Room and door to the

### **Kitchen**

Fitted with range of pine-style base and wall mounted units with worksurfaces and tiled splashbacks, radiator, 1 1/2 bowl sink unit, 3 windows, door to

### **Utility room**

Plumbing for washing machine, door to front.

**A staircase leads from the reception hall to the**

### **First floor landing**

Window to front, hatch to roof space, radiator, built-in airing cupboard with hot water cylinder.

### **Bedroom 1**

Range of built-in wardrobes with connecting dressing table, 2 radiators, 2 windows to rear, built-in wardrobe.

### **Bedroom 2**

Built-in wardrobes, radiator, windows to rear and side.

### **Bedroom 3**

Built-in wardrobe, radiator, windows to side and rear.

### **Bedroom 4**

Storage cupboard, radiator, window to rear.

### **Outside**

The property is approached via a splayed entrance with stone retaining wall, and double gates leading to a gravelled parking and turning area, and there is a triple Garage with 2 up-and-over doors, light and power - the garage has the possibility of conversion into a home office/studio/annexe (subject to the necessary planning permission).

There is an elevated front garden, lawned with retaining wall and a range of ornamental shrubs. There is access to either side of the property.

To one side there is an enclosed courtyard with storage shed and oil storage tank.

There is a lovely rear garden, which is south facing, and looks directly to St Andrew's Church, enclosed by brick wall and mature hedging for privacy. Mainly lawned, there is a large paved patio, a brick-built barbecue area, a range of shrubs and a further paved courtyard to the eastern side of the property.

### **Services**

Mains electricity, water and drainage are connected. It is understood mains gas is available in the village.

Oil-fired central heating.

### **Outgoings**

Council tax band F, payable 2024/25 £3375.13 Water and drainage rates are payable.

### **Directions**

From Hereford proceed initially towards Ledbury on the A438 and, just past Hereford Fire Station, turn right onto the B4224 towards Fownhope. Continue through Hampton Bishop and Mordiford into Fownhope, pass the Green Man on the right-hand side and at the crossroads, immediately before the church, turn left into Common Hill Lane. The entrance to the property is located on the right-hand side after about 50 yards.

### **Viewing**

Strictly by appointment through the Agent, Flint & Cook, 01432 355455.

### **Money laundering regulations**

Prospective purchasers are required to provide proof of funds, address verification and identification at the time of making an offer.

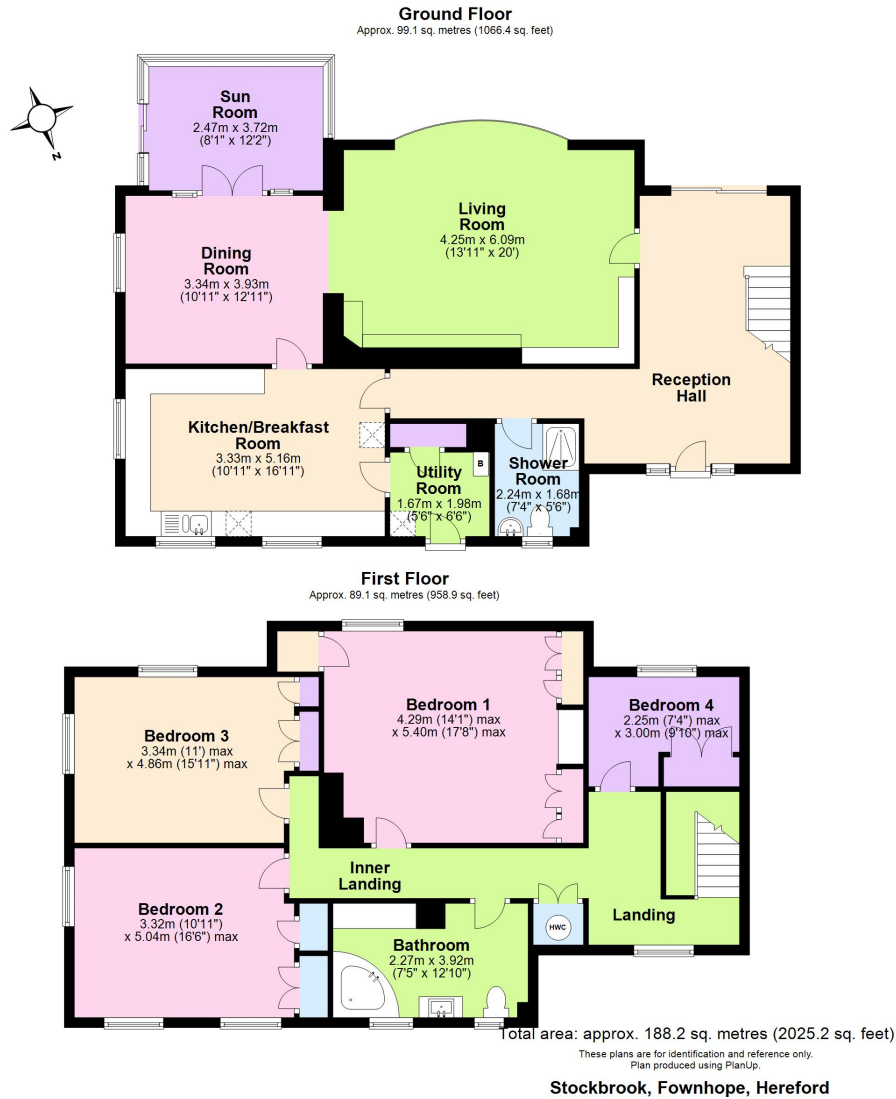

These particulars are prepared for the guidance only of prospective purchasers. They are intended to give a fair and overall description of the property and do not constitute the whole or any part of an offer or contract. Any information contained herein (whether in text, plans or photographs) is given in good faith but should not be relied upon as being a statement or representation of fact. Any plans provided by the agents and/or with the sales particulars are intended for guidance purposes only; we cannot guarantee the accuracy and scale of any plans, and they do not form any part of the sales contract. Nothing in these particulars shall be deemed to be a statement that the property is in good condition or otherwise nor that any services or facilities are in good working order. Any movable contents, fixtures and fittings, (whether wired or not) referred to in these property particulars (including any shown in the photographs) are, unless the particulars say otherwise, excluded from the sale. In the event that the buyer proposes to purchase any movable contents or include them in any offer for the property, the buyer cannot in any respect imply any such inclusion from the property particulars. Any areas, measurements or distances referred to herein are approximate only and may be subject to amendment. It should not be assumed that the property has all necessary planning, building regulation or other consents and these matters must be verified by an intending purchaser. The information in these particulars is given without responsibility on the part of the agents or their clients and neither the agents nor their employees have any authority to make or give any representations or warranties whatever in relation to this property.

**Flint & Cook Privacy Statement:** We take your privacy very seriously. Your data will not be shared with any other parties without your express permission. Our Data protection Policy can be read in full on the Flint & Cook website, [www.flintandcook.co.uk](http://www.flintandcook.co.uk)

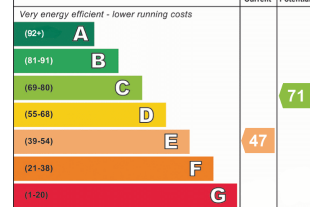
Energy Efficiency Rating				
	Current	Potential		
Very energy efficient - lower running costs				
(92+)	 71	47		
A				
(81-91)				
B				
(69-80)				
C				
(55-68)				
D				
(39-54)				
E				
(21-38)				
F				
(1-20)				
G				
Not energy efficient - higher running costs				
England, Scotland & Wales				
EU Directive 2002/91/EC				