

## 10 Brambledown

Folkestone  
CT19 5SL

**£170,000 FREEHOLD**

FOR SALE WITH BURNAP + ABEL... Welcome to Brambledown, a beautifully presented one-bedroom end-of-terrace home nestled in a quiet, well-connected area of Folkestone. Offering a seamless blend of comfort and convenience, this elegant property is an ideal first-time purchase or buy-to-let investment, with the added benefit of no onward chain. Step inside to discover a contemporary open-plan lounge/kitchen/diner, thoughtfully designed to maximise space and light—perfect for modern living. The double bedroom is generously sized, offering a peaceful retreat, while the well-appointed bathroom adds a place to unwind. Outside, enjoy your own private front garden, a rare and desirable feature offering outdoor space for relaxing, gardening, or alfresco dining. Set in a convenient location with excellent transport links, local amenities, and the coast nearby, this is a prime opportunity to secure a freehold home in a rising area of Kent.





**Entrance Hall**

**Open Plan Lounge/Kitchen/Diner**

18' 7" x 12' 1" (5.66m x 3.68m)

**First Floor Landing**

Loft access hatch and doors to;

**Bedroom**

12' 1" x 11' 11" (3.68m x 3.63m)

**Bathroom**

6' 5" x 5' 7" (1.96m x 1.70m)

**Front Garden**

**Ground Floor**

Approx. 21.3 sq. metres (229.1 sq. feet)

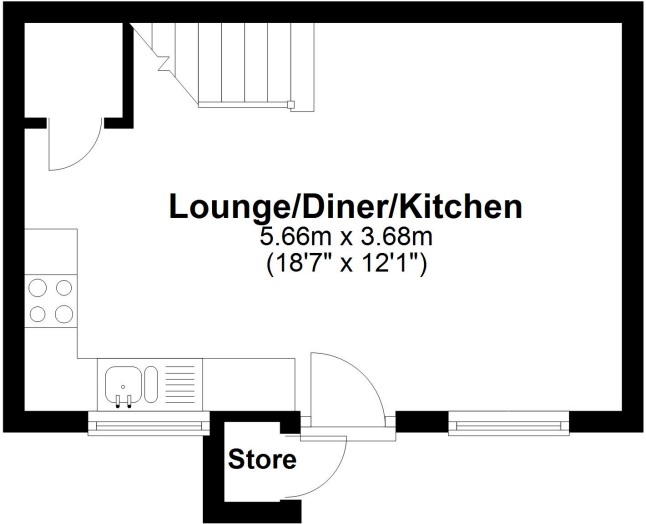

**First Floor**

Approx. 20.9 sq. metres (225.4 sq. feet)

