

# Truuli



## Aristo House, Lodge Road, Croydon, Surrey, CR0 2PH

£210,000 Leasehold

- Stunning & stylish finish throughout
- Open plan living
- Lovely communal garden
- Long lease
- Secure intercom entry system
- No onward chain

# Aristo House, Lodge Road, Croydon, Surrey, CR0 2PH

£210,000 Leasehold

This stunning modern flat, located in a prestigious detached building, is a true gem in West Croydon. Thoughtfully designed with light and style in mind, this contemporary home offers the perfect blend of elegance and comfort—one that anyone would be proud to own.

Lodge Road

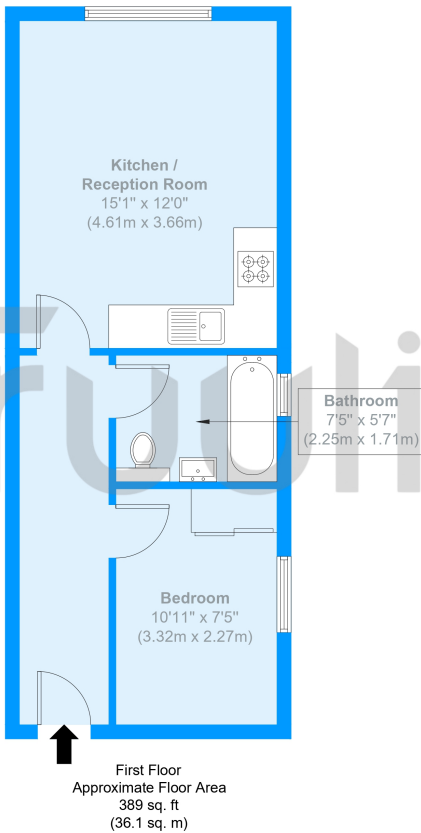

Approximate Gross Internal Area = 36.1 sq m / 389 sq ft

The Floor plan is not to scale and measurements and areas shown are approximate and therefore should be used for illustrative purposes only. The plan has been prepared in accordance with the RICS code of Measuring Practice and whilst we have confidence in the information produced it must not be relied on. Maximum lengths and widths are represented on the floor plan. If there is any aspect of particular importance, you should carry out or commission your own inspection of the property.  
Copyright © BleuPlan

Energy Efficiency Rating		
	Current	Potential
Very energy efficient - lower running costs		
(92+)	84	84
A		
(81-91)		
B		
(69-80)		
C		
(55-68)		
D		
(39-54)		
E		
(21-38)		
F		
(1-20)		
G		
Not energy efficient - higher running costs		
England, Scotland & Wales		
EU Directive 2002/91/EC		

