



110 Wilbury Road, Letchworth Garden City, Hertfordshire, SG6 4JQ

£660,000

A rare opportunity to purchase this fine 4 bedroomed family home in a wonderful location close to the town, station, sought after schools, the glorious Norton Common, fascinating Standalone farm and open countryside.

A modern home, presented to an exceptional standard by our vendors, and offering an outstanding open plan kitchen/diner space, with under floor heating, triple bi-fold doors, peninsula island and an array of fitted units and integral appliances.

Another noteworthy aspect is the sizeable 6.4 m sitting room with large windows allowing much natural lights and amazing space for family and friends to relax and enjoy. The entrance hall is wide and welcoming, and has a cloakroom off.



- WELL PROPORTIONED FOUR BEDROOM FAMILY HOME
- SOUGHT AFTER CENTRAL LETCHWORTH LOCATION
- CLOSE TO TOWN, STATION AND HIGHLY REGARDED SCHOOLS
- IMPRESSIVE LIGHT & AIRY 6.4m SITTING ROOM
- STANDOUT OPEN PLAN KITCHIN & DINING SPACE WITH BI-FOLD DOORS
- WELCOMING WIDE ENTRANCE HALL WITH CLOAKROOM
- WELL FITTED FOUR PIECE FAMILY BATHROOM WITH WHIRLPOOL BATH AND SEPARATE SHOWER
- DETACHED DOUBLE GARAGE WITH UTILITIES
- LONG FRONT GARDEN | PRIVATE REAR GARDEN WITH DECKED ENTERTAINING AREA'S
- TIMBER WORKSHOP WITH LIGHT & POWER
- COUNCIL TAX BAND E | EPC BAND E

110 Wilbury Road

Approximate Gross Internal Area
1571 sq ft - 146 sq m

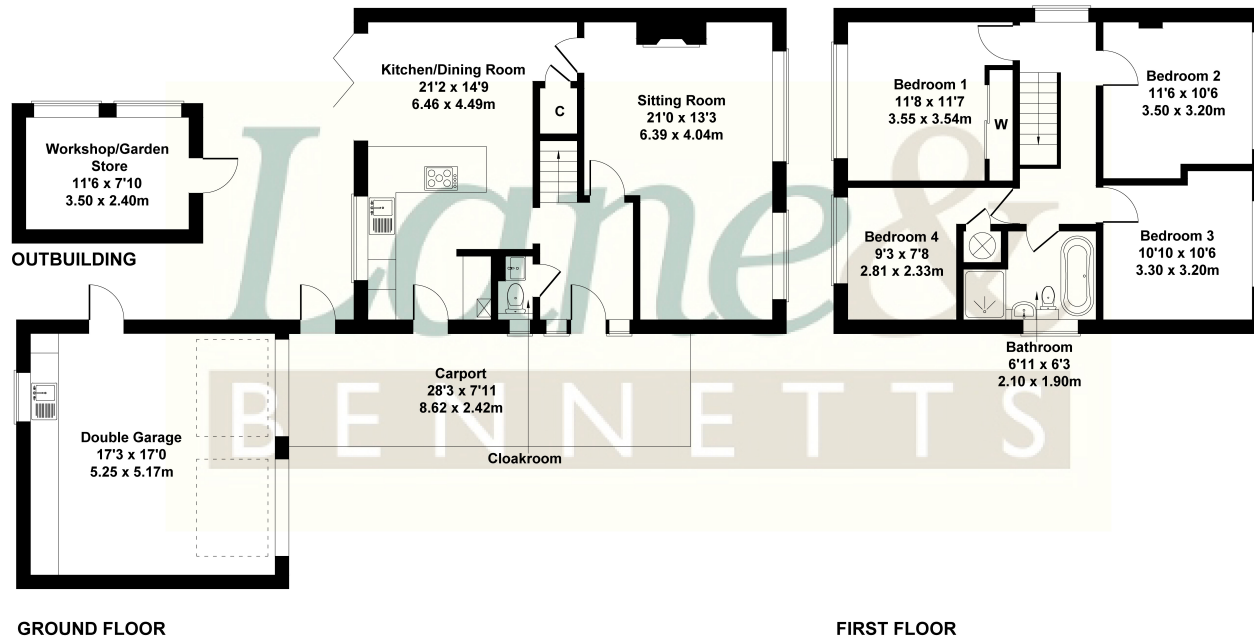

Not to Scale. Produced by The Plan Portal 2024
For Illustrative Purposes Only.

