

FOR SALE

15 Ingleby Road, New Ferry, Wirral. CH62 1BA

Offers in Excess of £130,000



Perfect first home! Tucked away on Ingleby Road in New Ferry is this beautifully presented, three bedroom, mid-terrace home. Placed in a central location with great transport links and local amenities on your door step, you also have easy access to reputable schools in the area. Ticking boxes for a growing family or a first-time buyer, this is not one to be missed.

Ground Floor

Lounge

10' 6" x 13' 1" (3.20m x 3.99m)

Dining Room

10' 6" x 12' 8" (3.20m x 3.86m)

Kitchen

5' 11" x 9' 0" (1.80m x 2.74m)

1st Floor

Bedroom

11' 1" x 11' 5" (3.38m x 3.48m)

Bedroom

10' 9" x 12' 5" (3.28m x 3.78m)

Bedroom

5' 1" x 6' 0" (1.55m x 1.83m)

Shower Room

6' 7" x 9' 1" (2.01m x 2.77m)

2nd Floor

Loft Space

16' 1" x 11' 9" (4.90m x 3.58m)





Ground Floor

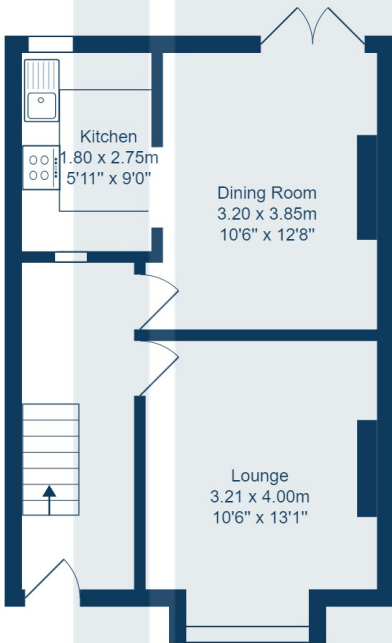

1st Floor

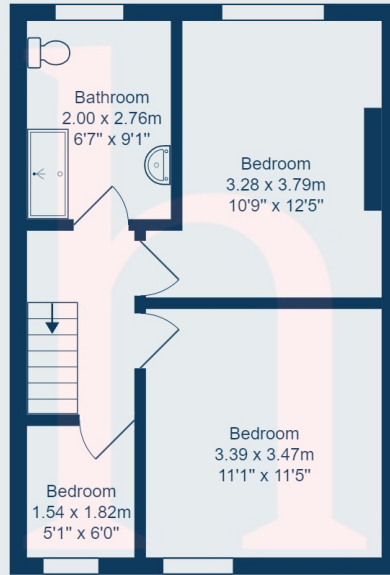

2nd Floor

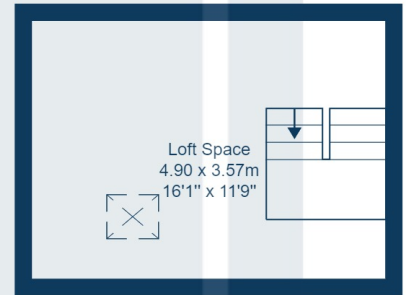

Total Area: 91.6 m² ... 986 ft²

All measurements are approximate and for display purposes only.