





- Extended Semi-Detached Family Home
- Three Reception Rooms
- Kitchen Breakfast Room
- Three Bedrooms
- Modern Bathroom
- Mature Garden
- Off Road Parking

Description

An immaculate semi-detached family home, that has been extended to both the side and to the rear. with modern fixtures and fittings, including a luxury kitchen and bathroom, the property comprises: Porch, entrance hall, cloakroom/WC, utility Room, lounge, dining room, family room, kitchen breakfast room, first floor landing, three bedrooms and bathroom. Outside there is parking to the front and a mature garden to the rear.



Location
Tenure

EPC Rating:



Ground Floor

Approx. 71.6 sq. metres (771.2 sq. feet)

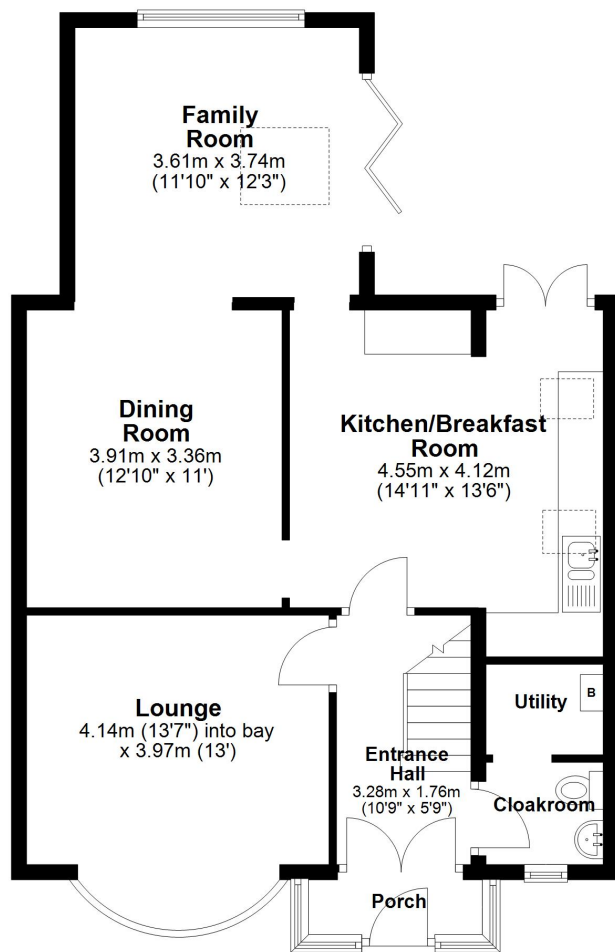

First Floor

Approx. 44.5 sq. metres (478.9 sq. feet)

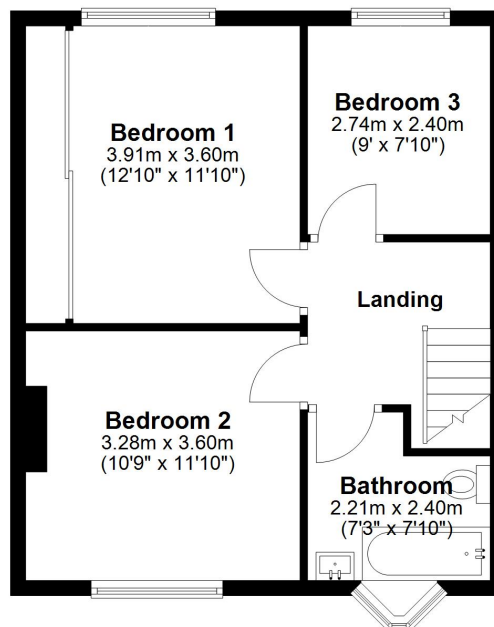

Total area: approx. 116.1 sq. metres (1250.1 sq. feet)



Williams Estates is the trading name of Williams Estates (Ltd). Registered address 33, The Green, Hartford, Northwich, Cheshire, CW8 1QA.

Reg number 07682683. Director Andrew P Williams