



Lenham Road
Thornton Heath
Surrey
CR7

Offers In Excess Of £475,000

bettermove

Lenham Road Thornton Heath

Bettermove are proud to present this 5 bedroom end of terrace house in Thornton Heath, available with no forward chain.

This is a tenanted property and will be sold with tenants in situ for immediate investment. Rental yields can be obtained through Bettermove.

The property benefits from mostly double glazing and gas central heating throughout, with on street parking available.

The council tax band is E.

The interior of this property comprises a spacious living room, fitted kitchen/diner, two shower rooms and three bedrooms on the ground floor. The first floor consists of a second living room, fitted kitchen/diner, family bathroom, WC and the additional two bedrooms. The exterior boasts a private rear garden, perfect for enjoying the summer months.

Located in the popular borough of Thornton Heath, the property is close to a range of amenities, including shops, supermarkets, restaurants and pubs. Excellent transport links can be found from Thornton Heath Railway Station, a variety of local bus and underground routes and close access to the A23.

This exciting opportunity should not be missed! All enquiries can be made through Bettermove on 0330 004 0050.



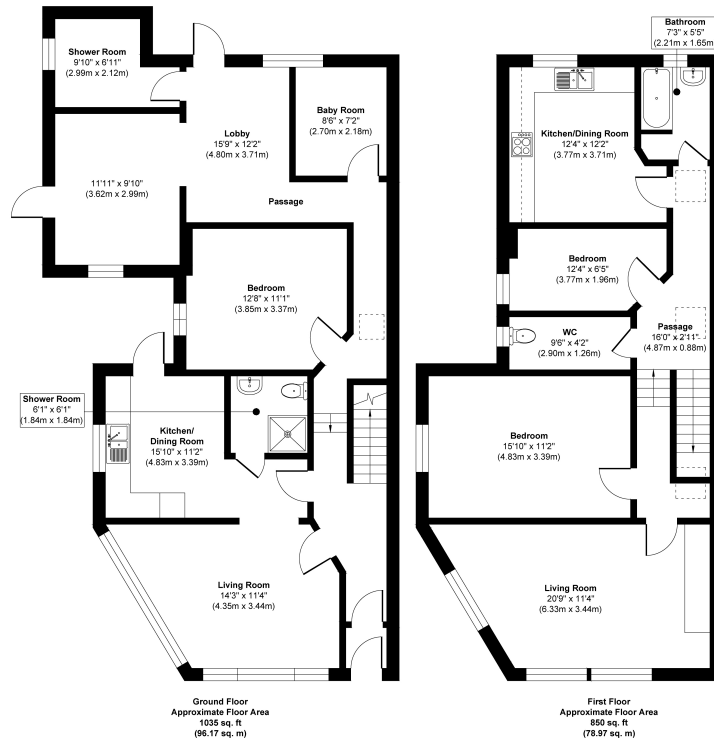

Approx. Gross Internal Floor Area 1885 sq. ft / 175.14 sq. m

Whilst every attempt has been made to ensure the accuracy of the floor plan contained here, measurements of doors, windows, rooms and any other items are approximate and no responsibility is taken for any error, omission, or mis-statement. The measurements should not be relied upon for valuation, transaction and/or funding purposes. This plan is for illustrative purposes only and should be used as such by any prospective purchaser or tenant.

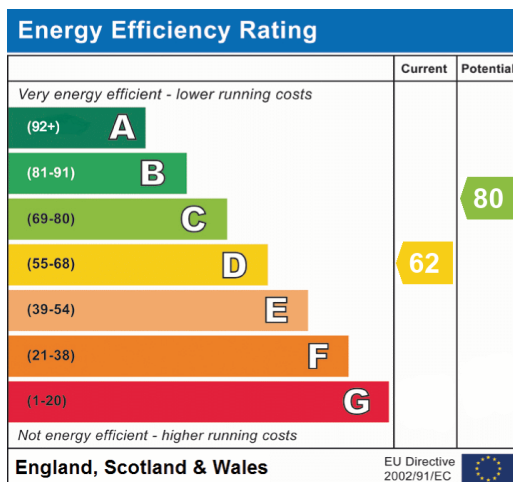



20-22 Bridge End, Leeds, LS1 4DJ
t: 0330 004 0050 e: hello@bettermove.co.uk
www.bettermove.co.uk