



Lime Street,
Stoke



OneAgency

01782 970222

hello@oneagencygroup.co.uk



£75,000

Mid terrace house situated within walking distance to Stoke town centre and also convenient for Staffordshire University, Royal Stoke University Hospital and the A500. The property is offered with no chain involvement and is considered an ideal first time buy or an excellent investment opportunity for landlords. The property benefits from a combi boiler with smart meter and UPVC double glazing. Viewing of this property is highly recommended.





GROUND FLOOR

DINING ROOM

3.54m x 3.43m (11' 7" x 11' 3") Double glazed window to front, radiator, laminate flooring.

LIVING ROOM

3.54m x 3.72m (11' 7" x 12' 2") Double glazed window to rear, radiator, under stairs storage area.

KITCHEN

2.02m x 3.71m (6' 8" x 12' 2") Fitted with a range of wall, base and drawer storage units, stainless steel sink and drainer unit with mixer tap, radiator, double glazed window to side.

REAR LOBBY

Wall mounted Baxi boiler, UPVC double glazed door to rear yard.

BATHROOM

Bathroom suite comprising of panelled bath with mixer taps and shower over., WC and pedestal wash hand basin, radiator, double glazed window to side.



FIRST FLOOR

BEDROOM ONE

3.53m x 3.72m (11' 7" x 12' 2") Double glazed window to rear, radiator, built in storage area.

BEDROOM TWO

3.53m x 3.43m (11' 7" x 11' 3") Double glazed window to front, radiator.

OUTSIDE

Rear yard.

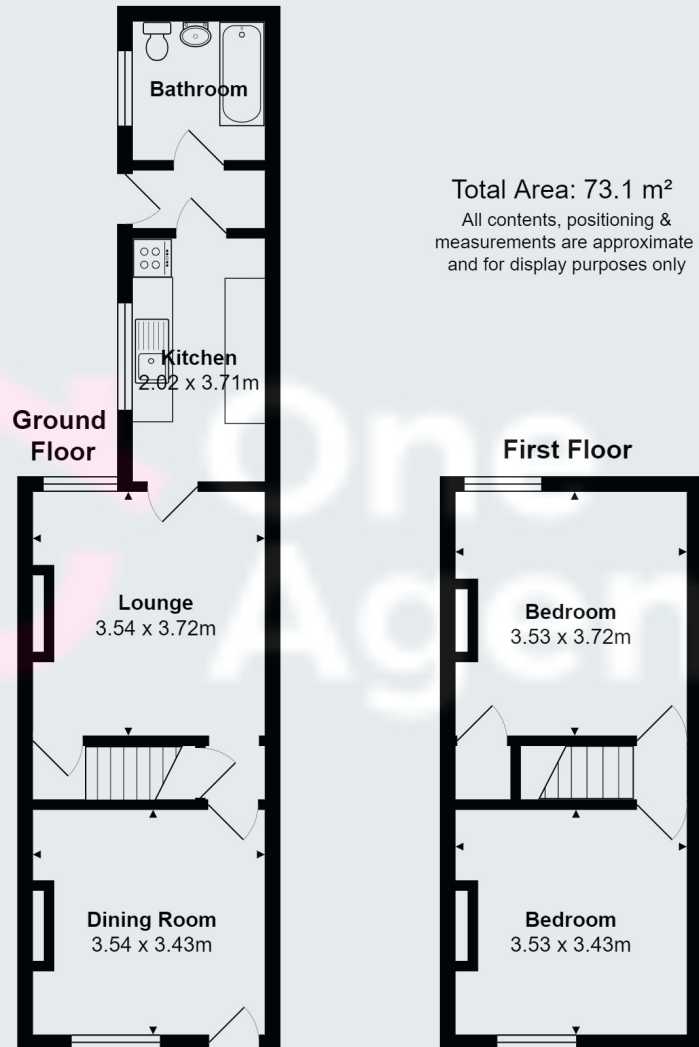

OneAgency, 9 & 10 Ridge House Drive, Festival Park, Stoke-on-Trent, ST1 5SJ

01782 970222

hello@oneagencygroup.co.uk

Every attempt has been made to ensure accuracy, however, all measurements are approximate and for illustrative purposes only. **Not to scale.**

In accordance with The Consumer Protection from Unfair Trading Regulations 2008 the following particulars have been prepared in good faith and they are not intended to constitute part of an offer or contract. We have not carried out a structural survey and the services, appliances and specific fittings have not been tested. All photographs, measurements, floor plans and distances referred to are given as a guide only and should not be relied upon for the purchase of carpets or any other fixtures and fittings. Lease details, service charges and ground rent (where applicable) are given as a guide only and should be checked and confirmed by your Solicitor prior to exchange of contracts.