



4 LODGE CLOSE

GRANGE PARK | NORTHAMPTON

£300,000 FREEHOLD



- sales
- lettings
- town & country

4 Lodge Close | Grange Park | Northampton | NN4 5AJ

Being offered for sale with NO CHAIN is this 3/4 bedroom semi town house situated within this sought after location being close to many amenities, good schools and the motorway. The accommodation is arranged over three floors and has been altered with the garage being converted into either a bedroom or a study/playroom. The accommodation now comprises entrance hall, two bedrooms, utility, shower room. On the first floor is the lounge/diner/kitchen and an additional utility room. On the second floor are two further bedrooms, en-suite shower room, and an additional shower room. Externally there are two parking spaces to the front of the property and a low maintenance rear garden. The property also offers gas central heating, double glazing and kitchen with a built in oven and hob. The property would make an ideal first time purchase or rental investment. An early viewing is highly recommended.

No chain | 3/4 bedroom town house | ideal first time buy or investment property |

~

Sought after location close to local amenities



- sales
- lettings
- town & country

Wootton Hope Drive, Northampton, NN4 6DY
MERRYS.CO.UK







GROUND FLOOR
379 sq.ft. (35.2 sq.m.) approx.

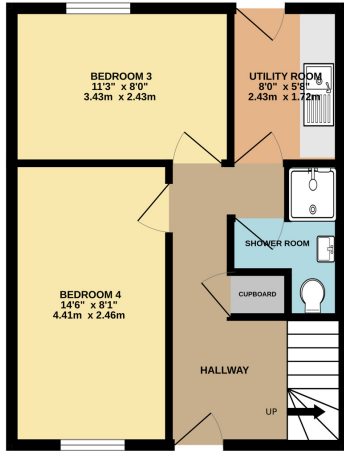

1ST FLOOR
379 sq.ft. (35.2 sq.m.) approx.

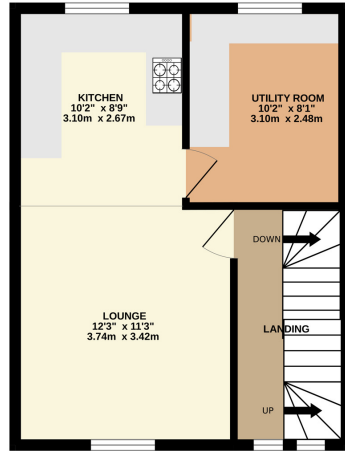

2ND FLOOR
379 sq.ft. (35.2 sq.m.) approx.

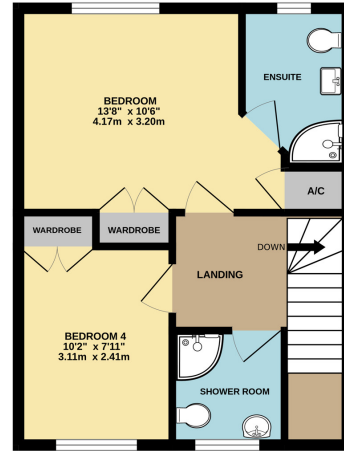

TOTAL FLOOR AREA : 1137 sq.ft. (105.6 sq.m.) approx.

Whilst every attempt has been made to ensure the accuracy of the floorplan contained here, measurements of doors, windows, rooms and any other items are approximate and no responsibility is taken for any error, omission or mis-statement. This plan is for illustrative purposes only and should be used as such by any prospective purchaser. The services, systems and appliances shown have not been tested and no guarantee as to their operability or efficiency can be given.
Made with Metropix ©2025

Note: Merrys for themselves and for the vendors of this property, whose agents they are, give notice that:

- 1.The particulars are intended to give a fair and substantially correct overall description for the guidance of intending purchasers and do not constitute, nor constitute part of an offer or contract. No responsibility is assumed for the accuracy of individual items.
- 2.All descriptions, dimensions, area, reference to condition and necessary permission for use and occupation and their details are given in good faith and are believed to be correct, but any intending purchasers should not rely on them as statements or representations of fact, but must satisfy themselves by inspection, or otherwise as to the correctness of each of them.
- 3.No person in the employment of Merrys has any authority to make or give and representations or warranty whatever in relation to this property or these particulars or enter into any contract relating to this property on behalf of the vendor.
- 4.No responsibility can be accepted for any expenses incurred by intending purchasers or in inspecting properties which have been sold, let or withdrawn.

