



37 Bidwell Close, Letchworth Garden City SG6 1QR





2 Bedroom Apartment

£235,000

Step into this beautifully presented two-bedroom apartment, with allocated parking, located in the heart of Letchworth. Designed for comfortable modern living, this home features a generous 15ft living room filled with natural light, offering a warm and welcoming space to relax or entertain.

The apartment offers two spacious double bedrooms, providing plenty of room for comfort and flexibility, whether you are working from home, hosting guests, or starting a family. The contemporary kitchen is both stylish and functional, ideal for everyday living. A well-maintained interior, and a move-in-ready condition—making this an excellent choice for first-time buyers or those looking to downsize with ease.

- Modern fitted kitchen
- Large 15 ft living room
- Allocated parking
- Bright and spacious throughout
- Chain free
- Two-bedroom apartment
- Perfect for first time buyers
- Lease 995 years remaining
- Service charge £955
- EPC rating E. Council tax band B



Ground Floor

Living Room:

Abt. 10' 4" x 15' 4" (3.15m x 4.67m) Carpet, electric storage heater, double glazed window.

Kitchen:

Abt. 7' 7" x 8' 6" (2.31m x 2.59m) Laminate flooring, double glazed window, induction fan, integrated oven and electric induction hob.

Bathroom:

Laminate flooring, tiled walls. Suite comprising bath, shower screen, toilet and wash basin with wall mounted mirror and a towel rail.

Bedroom One:

Abt. 9' 5" x 13' 7" (2.87m x 4.14m) Carpet, double glazed windows, electric storage heater.

Bedroom Two:

Abt. 7' 7" x 9' 5" (2.31m x 2.87m) Bay window, carpet, double glazed windows.

Outside

Agents Note:

Draft particulars yet to be approved by vendor and may be subject to change.



These particulars are a guide only and do not constitute an offer or a contract. The floor plan is for identification purposes only and not to scale. All measurements are approximate and should not be relied upon if ordering furniture, white goods and flooring etc. We have presented the property as we feel fairly describes it but before arranging a viewing or deciding to buy, should there be anything specific you would like to know about the property please enquire. Satchells have not tested any of the appliances or carried out any form of survey and advise you to carry out your own investigations on the state, condition, structure, services, title, tenure, and council tax band of the property. Some images may have been enhanced and the contents shown may not be included in the sale. Satchells routinely refer to 3rd party services for which we receive an income from their fee. If you would like us to refer you to one of these services please ask one of our staff who will pass your details on. We advise you check the availability of the property on the day of your viewing.



First Floor

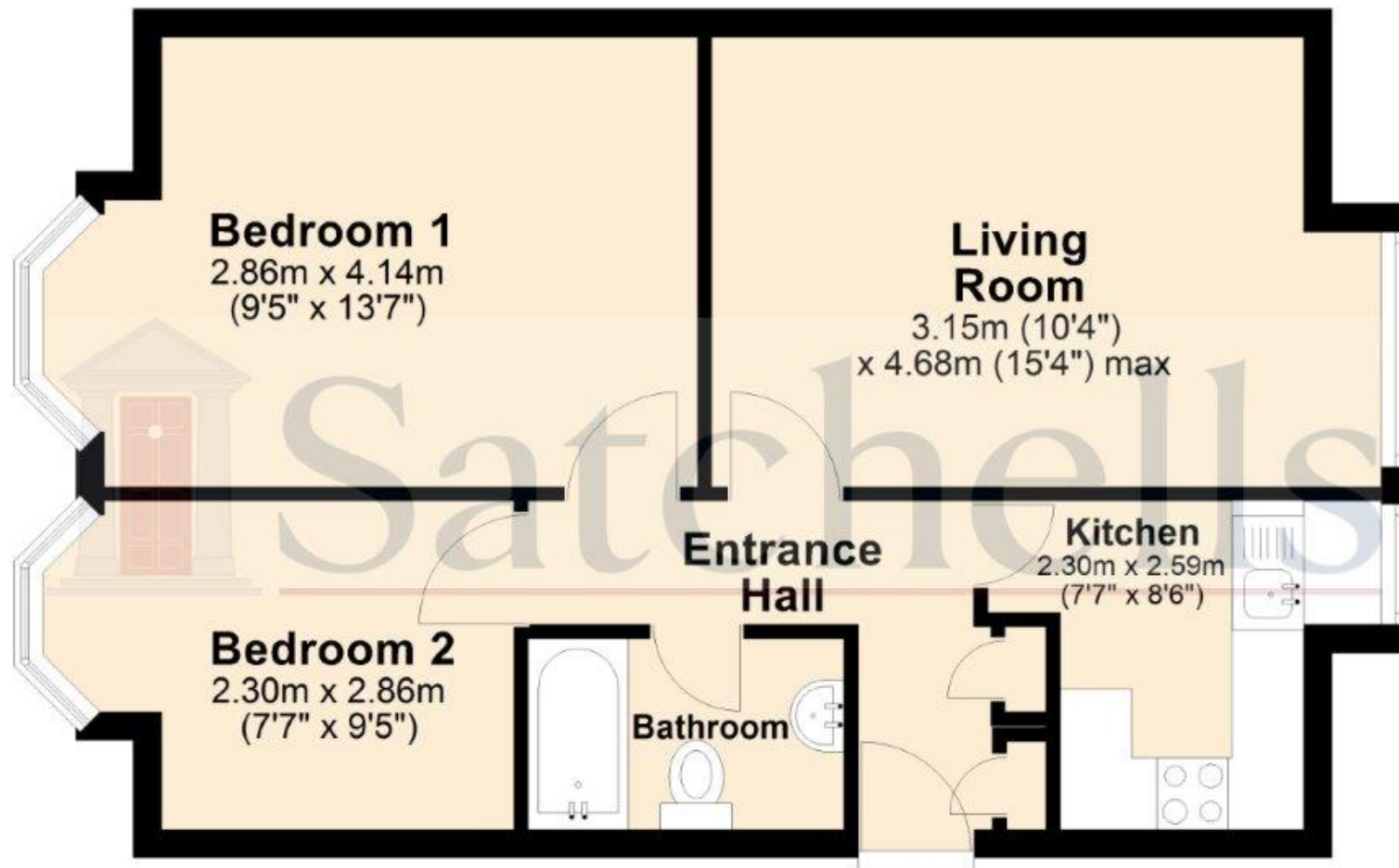

For illustration purposes only - NOT TO SCALE - Measurements shown are approximate. The size and position of doors, windows, appliances and other features are approximate.

Plan produced using PlanUp.