



11c High Street, Langford, Bedfordshire, SG18 9RP

£1,250 pcm

Superb 4 bedroom town house available for rental in the heart of the village. The property consists of three floors with the master bedroom and en-suite on the top floor. Outside there is a garden with a patio as well as off road parking provided by a garage.



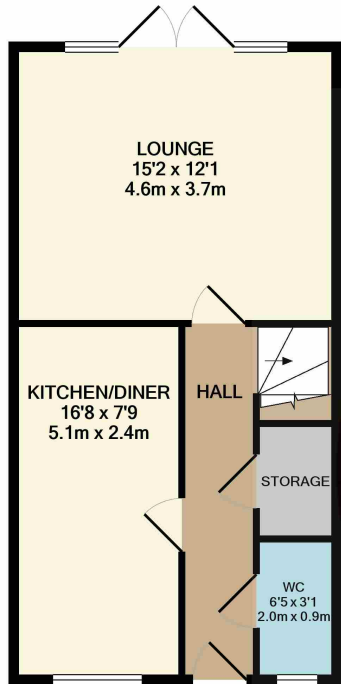

GROUND FLOOR
APPROX. FLOOR
AREA 444 SQ.FT.
(41.3 SQ.M.)

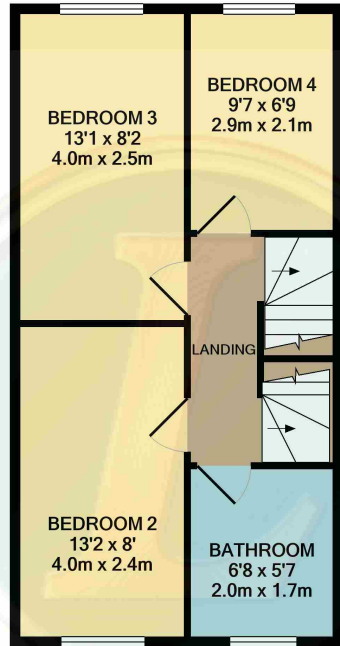

1ST FLOOR
APPROX. FLOOR
AREA 444 SQ.FT.
(41.3 SQ.M.)

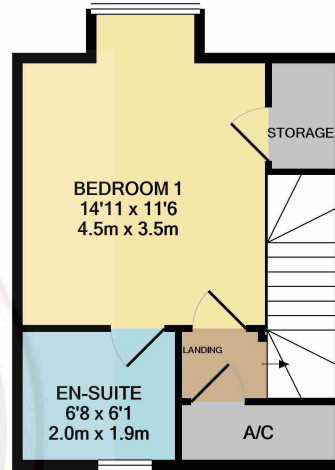

2ND FLOOR
APPROX. FLOOR
AREA 297 SQ.FT.
(27.6 SQ.M.)

TOTAL APPROX. FLOOR AREA 1186 SQ.FT. (110.1 SQ.M.)
Whilst every attempt has been made to ensure the accuracy of the floor plan contained here, measurements of doors, windows, rooms and any other items are approximate and no responsibility is taken for any error, omission, or mis-statement. This plan is for illustrative purposes only and should be used as such by any prospective purchaser. The services, systems and appliances shown have not been tested and no guarantee as to their operability or efficiency can be given
Made with Metropix ©2020

- FINE FOUR BED FAMILY HOME
- MODERN AND VERY WELL PRESENTED
- KITCHEN/DINER WITH BUILT IN APPLIANCES
- ENCLOSED REAR GARDEN
- LARGE LOUNGE
- EN SUITE BATHROOM TO MASTER
- GROUND FLOOR CLOAKROOM
- LOCATED IN THE HEART OF THE VILLAGE
- WALK TO SCHOOL AND BEAUTIFUL RIVERSIDE COMMON
- AVAILABLE 1ST DEC MEDIUM TO LONG TERM RENT

