



Edbrooke Road, London, W9 2DG

Cow & Co
LONDON



A larger than average, Share of Freehold, one double bedroom first floor apartment overlooking the park with bright and spacious accommodation throughout.

The property is located within easy distance of Maida Vale and Warwick Avenue Tube Stations and restaurants and cafes of little Venice. Available fully furnished.



- Bright and spacious one double bedroom period conversion
- Modern open plan kitchen
- Remodelled bathroom
- Close to local shops and amenities
- Overlooking the park
- Close proximity to local transport links and amenities
- Raised ground floor
- Share of Freehold

Edbrooke Road, London, W9

Approximate Area = 526 sq ft / 48.8 sq m

For identification only - Not to scale

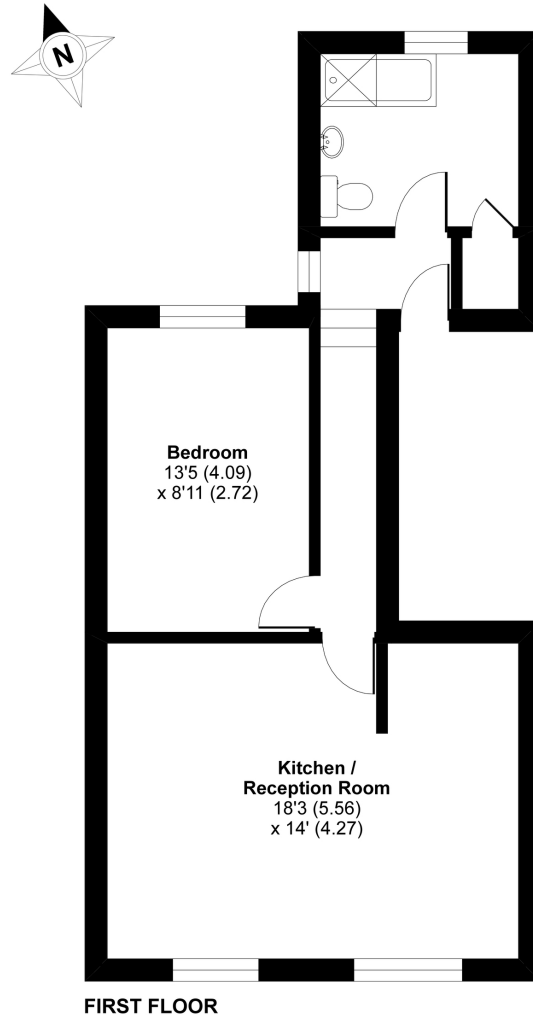

Floor plan produced in accordance with RICS Property Measurement Standards incorporating International Property Measurement Standards (IPMS2 Residential). © nichecom 2020. Produced for Cow & Co Properties Ltd. REF: 609357

Tel: 0208 065 0010
Email: thehub@cowandco-london.com
Web: cowandco-london.com

Agents note: All measurements are approximate and whilst every attempt has been made to ensure accuracy they are for general guidance only and must not be relied on. The fixture and fittings referred to have not been tested and therefore no guarantee can be given that they are in working order. Internal photographs are reproduced for general information and it must not be inferred that any item shown is included with the property.

Cow & Co
LONDON