



PILOT WALK, GREENWICH, LONDON SE10 ONW

**£2,400
PCM**

Stunning 9th floor two bedroom, two bathroom apartment situated in the incredibly popular Greenwich Peninsula. Accommodation boasts nearly 900 sq. ft. of internal floor space and comprises of a spacious dual aspect lounge with a sleek and stylish open plan kitchen, two large double bedrooms, a modern bathroom and ensuite shower room. Further benefits include a large sunny balcony with far reaching views.

Further benefits for residents include access to the services provided by the Aperture Building which include concierge services, a triplex gym, nursery and café/deli.

The development is located minutes from North Greenwich tube station (Jubilee Line), the Emirates Cable Cars and the O2 with the many attractions within, including bars and restaurants and shops. Other notable amenities within walking distance include, schools, the river bus, local retail park and supermarkets.

VIEWING BY APPOINTMENT WITH 1ST AVENUE. CALL: 020 8293 8600

**88 PILOT WALK,
GREENWICH, LONDON
SE10 0NW**

£2,400 PCM

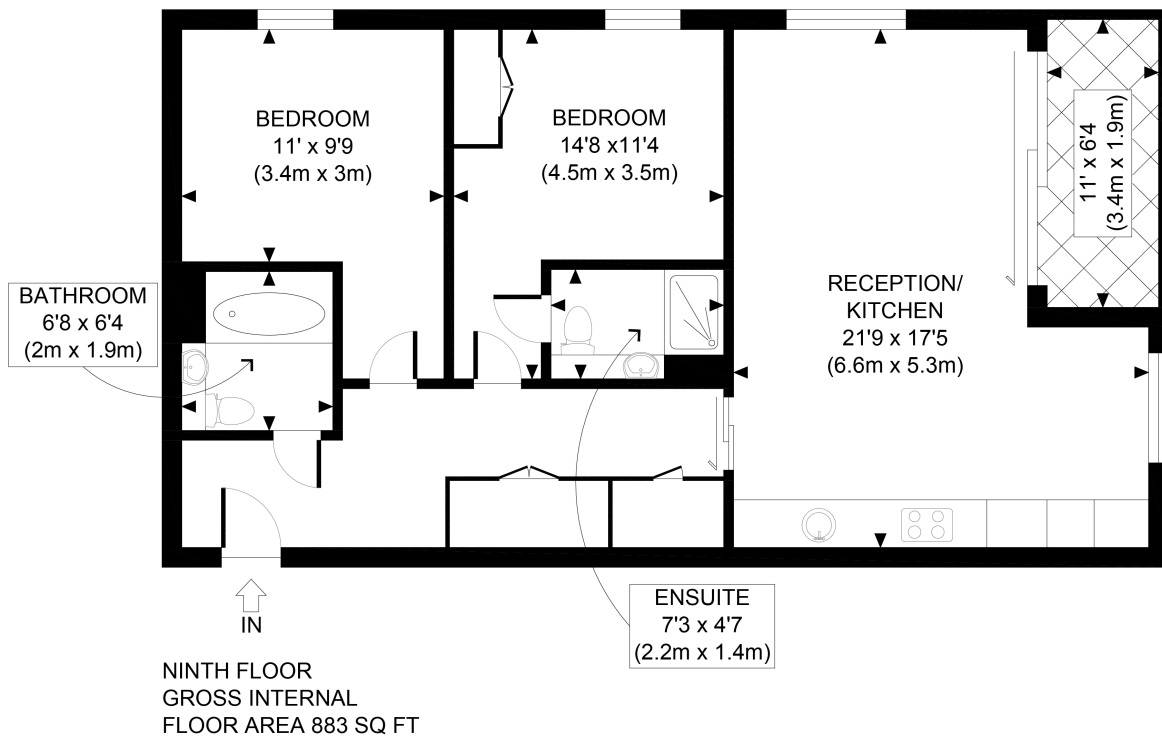

APPROX. GROSS INTERNAL FLOOR AREA 883 SQ FT / 82 SQM

Ref:

Copyright **photoplan**

Disclaimer: Floor plan measurements are approximate and are for illustrative purposes only.

While we do not doubt the floor plan accuracy and completeness, you or your advisors should conduct a careful, independent investigation of the property in respect of monetary valuation

**VIEWING BY APPOINTMENT
WITH 1ST AVENUE.**

CALL: 020 8293 8600

1stavenue
Real Estate Services