

# Truuli



## Bigginwood Road, London, SW16

£750,000 Freehold

- Semi detached family home
- Downstairs shower room and upstairs bathroom
- Ensuite to primary bedroom
- Off street parking for multiple cars
- Easy access into Streatham or Crystal Palace
- Guide price £750,000 - £775,000

Southbridge Place, Surrey, CR0 4HA

Tel: 0330 043 0002

Email: [save@truuli.co.uk](mailto:save@truuli.co.uk) Web: [www.truuli.co.uk](http://www.truuli.co.uk)

# Bigginwood Road, London, SW16

£750,000 Freehold

\*\*\* Guide price £750,000–£775,000 A superb double-fronted, four-bedroom period family home located on Bigginwood Road, Streatham. The property is presented, in our opinion, in good condition and is within easy reach of Norbury Park.

Ground Floor  
873 sq.ft. (81.1 sq.m.) approx.

1st Floor  
640 sq.ft. (59.4 sq.m.) approx.

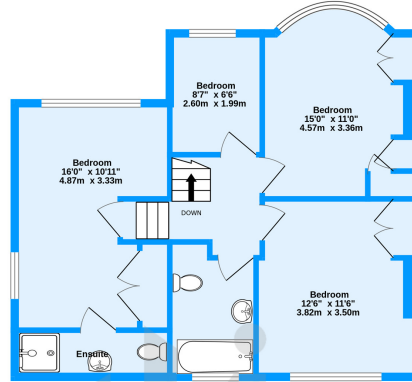
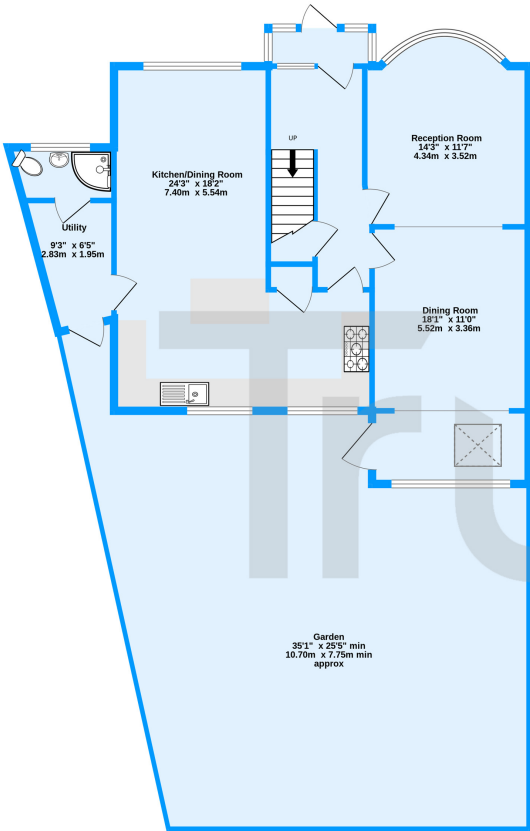

Bigginwood Road, Norbury, SW16  
TOTAL FLOOR AREA: 1513 sq.ft. (140.5 sq.m.) approx.  
Measurements are approximate. Not to scale. Illustrative purposes only  
Made with Metropix ©2023

Energy Efficiency Rating		Current	Potential
Very energy efficient - lower running costs			
(92+)	<b>A</b>		
(81-91)	<b>B</b>		
(69-80)	<b>C</b>		
(55-68)	<b>D</b>		
(39-54)	<b>E</b>		
(21-38)	<b>F</b>		
(1-20)	<b>G</b>		
Not energy efficient - higher running costs			
		69	82
England, Scotland & Wales		EU Directive 2002/91/EC	

