

FOR SALE

£300,000

Lambeth Court, Queens Road, Hoylake, Wirral. CH47 2AG



This beautifully-presented penthouse apartment has been wonderfully maintained by our current sellers and offers modern and contemporary living accommodation throughout. Boasting over 1300 square feet, the property is generously sized and comes with off road parking and a garage.





Ground Floor

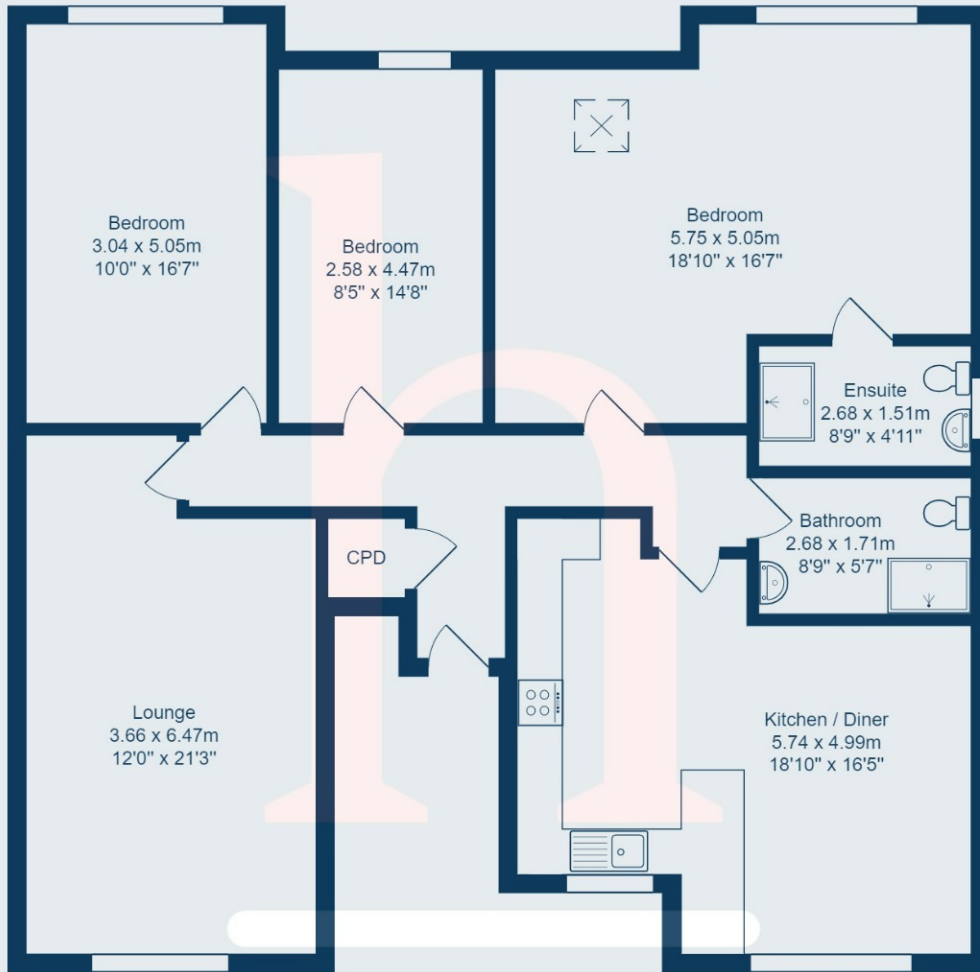

Total Area: 124.9 m² ... 1344 ft²

All measurements are approximate and for display purposes only.

Energy Efficiency Rating

	Current	Potential
<i>Very energy efficient - lower running costs</i>		
(92+) A		
(81-91) B		
(69-80) C	75	77
(55-68) D		
(39-54) E		
(21-38) F		
(1-20) G		
<i>Not energy efficient - higher running costs</i>		
England, Scotland & Wales	EU Directive 2002/91/EC	