



Alderley Rise,
Burslem



OneAgency

01782 970222

hello@oneagencygroup.co.uk



Offers in Region of £120,000

A three bedroom mid town house in the popular location of Burslem. The property benefits from a ground floor W/C, three bedrooms and low maintenance rear garden. Ideal for buy to let investors! Located close to Burslem Town Centre with amenities, access to commuter links and close to schools. Viewing is highly advised!





Ground Floor

Hallway

Front door, under stairs storage, radiator and vinyl flooring.

Lounge

5.87m x 3.74m (19' 3" x 12' 3") French doors to the garden, double glazed windows, radiators and vinyl flooring.

Kitchen

4.66m x 2.96m (15' 3" x 9' 9") A range of wall and base units with worktops, stainless steel sink basin, integral oven, fridge/freezer, double glazed window, radiator and vinyl flooring.

First Floor

Bedroom One

3.80m x 3.76m (12' 6" x 12' 4") A double glazed window, radiator and carpet flooring.

Bedroom Two

3.80m x 3.74m (12' 6" x 12' 3") A double glazed window, radiator and carpet flooring.

Bedroom Three

2.61m x 1.94m (8' 7" x 6' 4") A double glazed window, radiator and carpet flooring.



Bathroom

2.13m x 1.96m (7' 0" x 6' 5") A white suite with bath, pedestal hand wash basin, low level W/C, radiator, double glazed window and vinyl flooring.

External

Rear - A paved path with lawned garden and gated access

AGENTS NOTES

We understand there is currently an approximate charge of around £200 every six months relating to the management company of the development. We recommend buyers make further enquiries with their solicitor.

The council tax band is B. The local authority is Stoke-on-Trent.

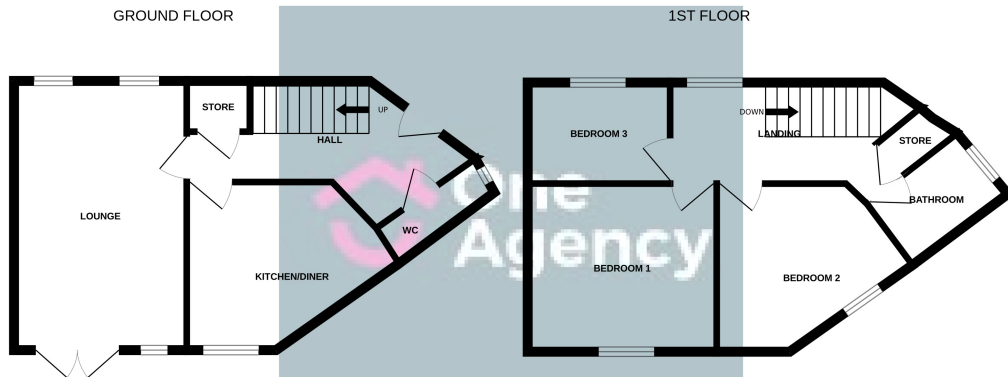

Whilst every attempt has been made to ensure the accuracy of the floorplan contained here, measurements of doors, windows, rooms and any other items are approximate and no responsibility is taken for any error, omission or mis-statement. This plan is for illustrative purposes only and should be used as such by any prospective purchaser. The services, systems and appliances shown have not been tested and no guarantee as to their operability or efficiency can be given.
Made with Metropix ©2024

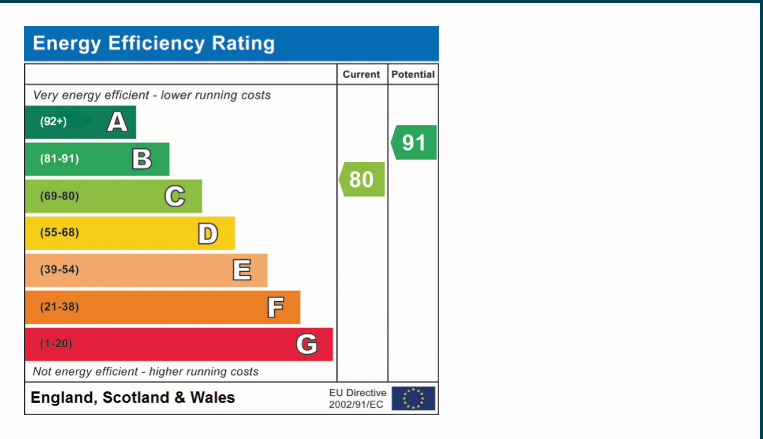

OneAgency, 9 & 10 Ridge House Drive, Festival Park, Stoke-on-Trent, ST1 5SJ

01782 970222

hello@oneagencygroup.co.uk

Every attempt has been made to ensure accuracy, however, all measurements are approximate and for illustrative purposes only. **Not to scale.**
In accordance with The Consumer Protection from Unfair Trading Regulations 2008 the following particulars have been prepared in good faith and they are not intended to constitute part of an offer or contract. We have not carried out a structural survey and the services, appliances and specific fittings have not been tested. All photographs, measurements, floor plans and distances referred to are given as a guide only and should not be relied upon for the purchase of carpets or any other fixtures and fittings. Lease details, service charges and ground rent (where applicable) are given as a guide only and should be checked and confirmed by your Solicitor prior to exchange of contracts.