



Aspen Gardens, Stotfold, Hitchin, Hertfordshire. SG5 4RS





2 Bedroom Apartment

Shared Ownership £115,000 Leasehold

50% SHARED OWNERSHIP Located on the popular Beauchamp Mill development is this spacious first floor apartment that is presented in excellent order throughout.

Internally the accommodation comprises a welcoming entrance hall, contemporary open plan kitchen/dining/living room, the kitchen with integrated appliances, two double bedrooms and a modern bathroom. Externally is an allocated parking space, additional visitors parking and a communal garden.

- Spacious first floor apartment
- Contemporary open plan living space
- Fitted kitchen with integrated appliances
- Two double bedrooms
- Modern bathroom
- Gas central heating
- Double glazing
- Allocated parking
- Communal garden
- EPC rating B. Council tax band B

Ground Floor

Communal Entrance:

Enter at the ground floor and take the stairs to the first floor.

First Floor

Front Door:

Timber front door.

Entrance Hall:

A good size hallway with two large storage cupboards. Loft access. Radiator. Laminate flooring.

Open Plan Kitchen/Dining/Living Room:

Abt. 27' 3" x 9' 5" < 12' 0" (8.31m x 2.87m < 3.66m) A spacious light and airy open plan kitchen/dining/living room with double glazed window to rear. Two radiators. Television point.

The kitchen area comprises a comprehensive range of eye and base level units with ample roll edge worksurfaces and under cupboard lighting. Single drainer stainless steel sink unit. Built-in four ring gas hob, electric oven and extractor hood with stainless steel splashback. Integrated fridge/freezer and washer dryer. Extractor fan. Laminate flooring.

Bedroom One:

Abt. 12' 7" x 9' 4" (3.84m x 2.84m) Double glazed window to rear. Radiator. Carpet as fitted.

Bedroom Two:

Abt. 10' 0" x 8' 8" (3.05m x 2.64m) Double glazed window to front. Radiator. Carpet as fitted.

Bathroom:

A white suite comprising panelled bath with shower over and glass shower screen, pedestal wash hand basin and low level wc. Tiled splashback area. Heated towel rail. Double glazed window to rear. Storage cupboard that also houses the gas boiler. Extractor fan. Vinyl flooring.

External Parking:

There is an allocated parking space plus additional visitors parking.

Outside:

Paved pathway with steps to front door. Outside light. Communal rear garden with shed and bike storage.

Additional Information:

Shared Ownership:

The property is currently owned on a 50% Shared ownership basis. The 100% value is £230,000. Purchasers are able to buy a minimum 50% share up to the full 100%.

50% share: £115,000

Lease Term: 99 years from 25th March 2014

Rent PCM: £276.24

Service Charge: £114.14





These particulars are a guide only and do not constitute an offer or a contract. The floor plan is for identification purposes only and not to scale. All measurements are approximate and should not be relied upon if ordering furniture, white goods and flooring etc. We have presented the property as we feel fairly describes it but before arranging a viewing or deciding to buy, should there be anything specific you would like to know about the property please enquire. Satchells have not tested any of the appliances or carried out any form of survey and advise you to carry out your own investigations on the state, condition, structure, services, title, tenure, and council tax band of the property. Some images may have been enhanced and the contents shown may not be included in the sale. Satchells routinely refer to 3rd party services for which we receive an income from their fee. If you would like us to refer you to one of these services please ask one of our staff who will pass your details on. We advise you check the availability of the property on the day of your viewing.



First Floor

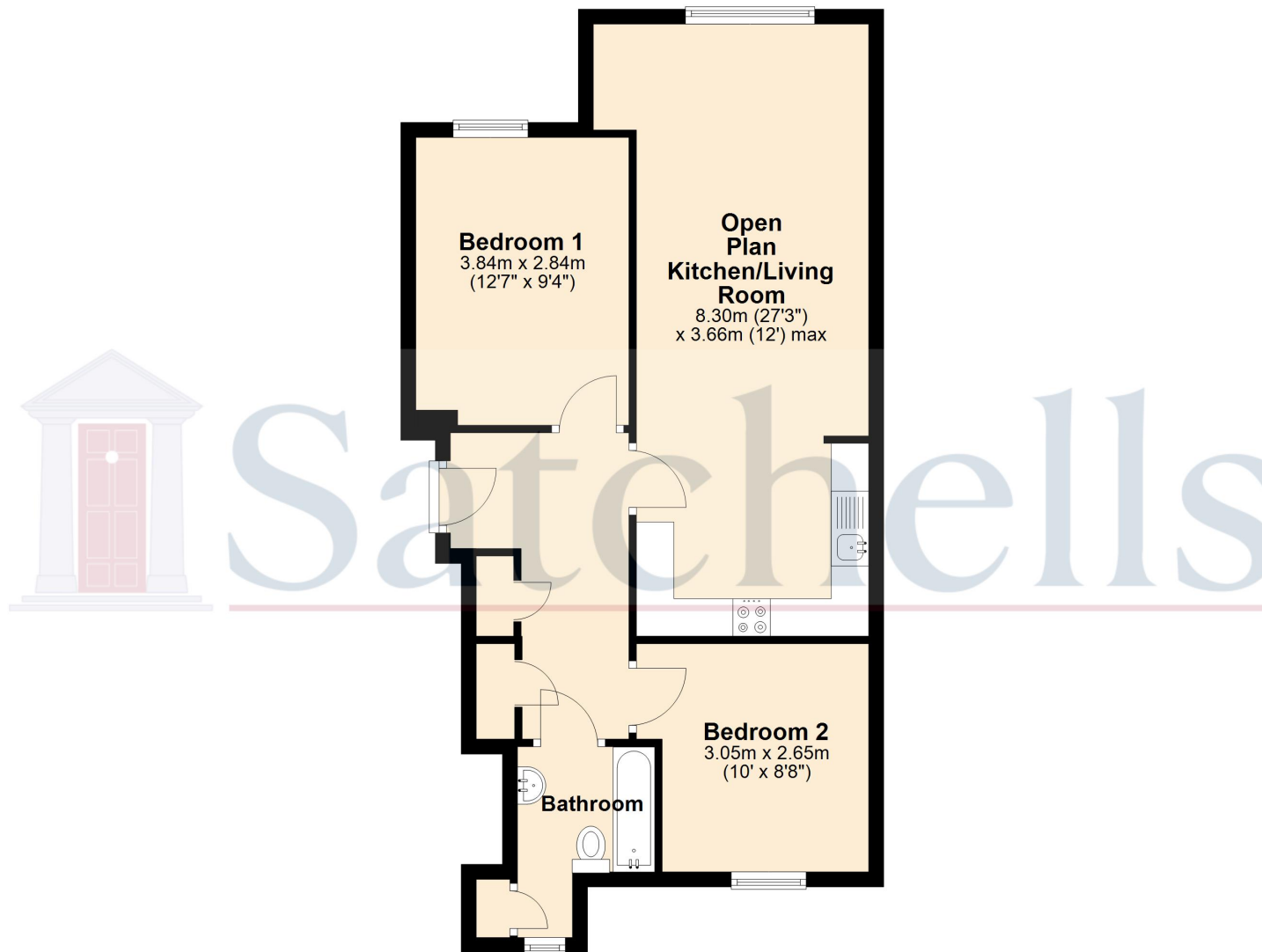

For illustrative purposes only - NOT TO SCALE - Measurements shown are approximate.
The size and position of doors, windows, appliances and other features are approximate.

Plan produced using PlanUp.