



2 Haysman Close, Letchworth Garden City, Hertfordshire, SG6 1UB

Offers in excess of £300,000

Lane & Bennetts are pleased to present this well presented three bedroom end terrace home, which is available CHAIN FREE. Located in the corner of a pleasant cul-de-sac, situated under a mile from the station, town, leisure facilities and out of town retail park, the property offers a large dual aspect lounge & dining room, a fitted kitchen with some appliances and lovely garden views, two double bedrooms and one single with a white three-piece family bathroom.

The property benefits from a detached garage to the rear with light, power and storage space. In addition, there is also an allocated off road parking space. The front & rear gardens are well kept, with the rear approximately 30 m (95 ft). Please note that there are steps leading to the front of the property.

Lane &
BENNETTS

2 Haysman Close SG6 1UB

Approximate Gross Internal Area
689 sq ft - 64 sq m

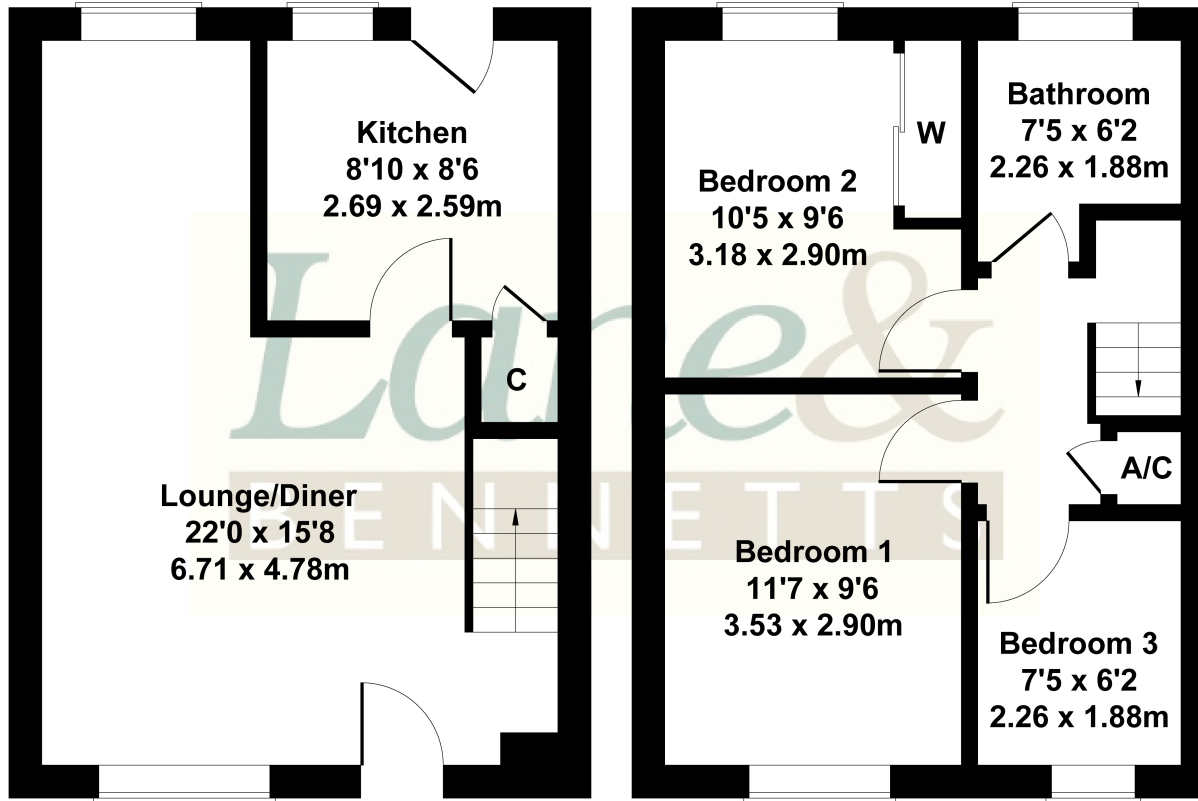

GROUND FLOOR

FIRST FLOOR

Not to Scale. Produced by The Plan Portal 2025
For Illustrative Purposes Only.

- THREE BEDROOM END OF TERRACE HOME
- UNDER 1M FROM TOWN | TUCKED AWAY IN THE CORNER OF A CUL-DE-SAC |
- DETACHED GARAGE WITH LIGHT & POWER
- DUAL ASPECT LOUNGE & DINING AREA
- FITTED KITCHEN WITH SOME APPLIANCES
- ADDITIONAL OFF ROAD ALLOCATED PARKING
- CLOSE TO SHOPPING AND LEISURE FACILITIES
- LONG PRIVATE REAR GARDEN
- COUNCIL TAX BAND C | EPC BAND C
- FANTASTIC VALUE - VIEWING ESSENTIAL

