

Gaston Bridge Road, Shepperton, TW17 8HA

Guide Price £475,000



- Detached Bungalow
- Ample Off Street Parking
- Quartz Worktops
- Large Bedroom With Wardrobes
- Garage
- Modern Fitted Kitchen
- Modern Bathroom
- Excellent Condition Throughout

Gaston Bridge Road, Shepperton, TW17

Approximate Gross Internal Area
Main House 700 sq ft - 65 sq m
Garage 108 sq ft - 10 sq m
Outbuilding 108 sq ft - 10 sq m
Total 916 sq ft - 85 sq m

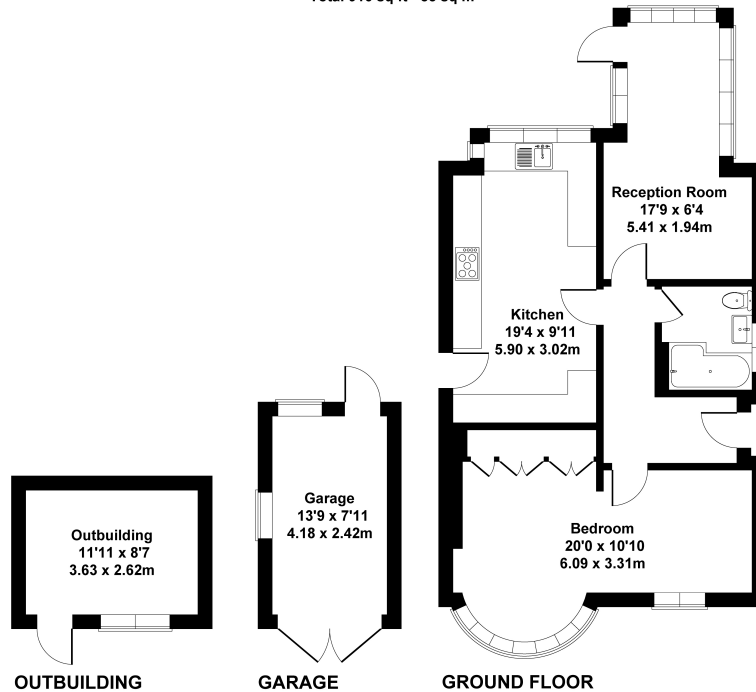

This floorplan is for guidance only and does not form part of an offer or contract.
Buyers or tenants should verify all details through inspection, searches, and surveys.
Measurements are approximate and should not be relied upon for valuation or transactions.
Produced by Plan Portal.
www.evolve.london.co.uk

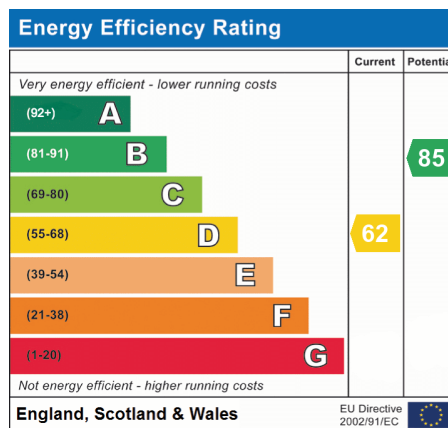

We have not tested the services or domestic appliances so we cannot verify that they are in working order. The buyer is advised to obtain verification from their solicitor or surveyor. These particulars form no part of any offer or contract and their accuracy cannot be guaranteed.