

## Trentham Court, Victoria Road, W3

Approximate Floor Area = 59.4 sq m / 639 sq ft

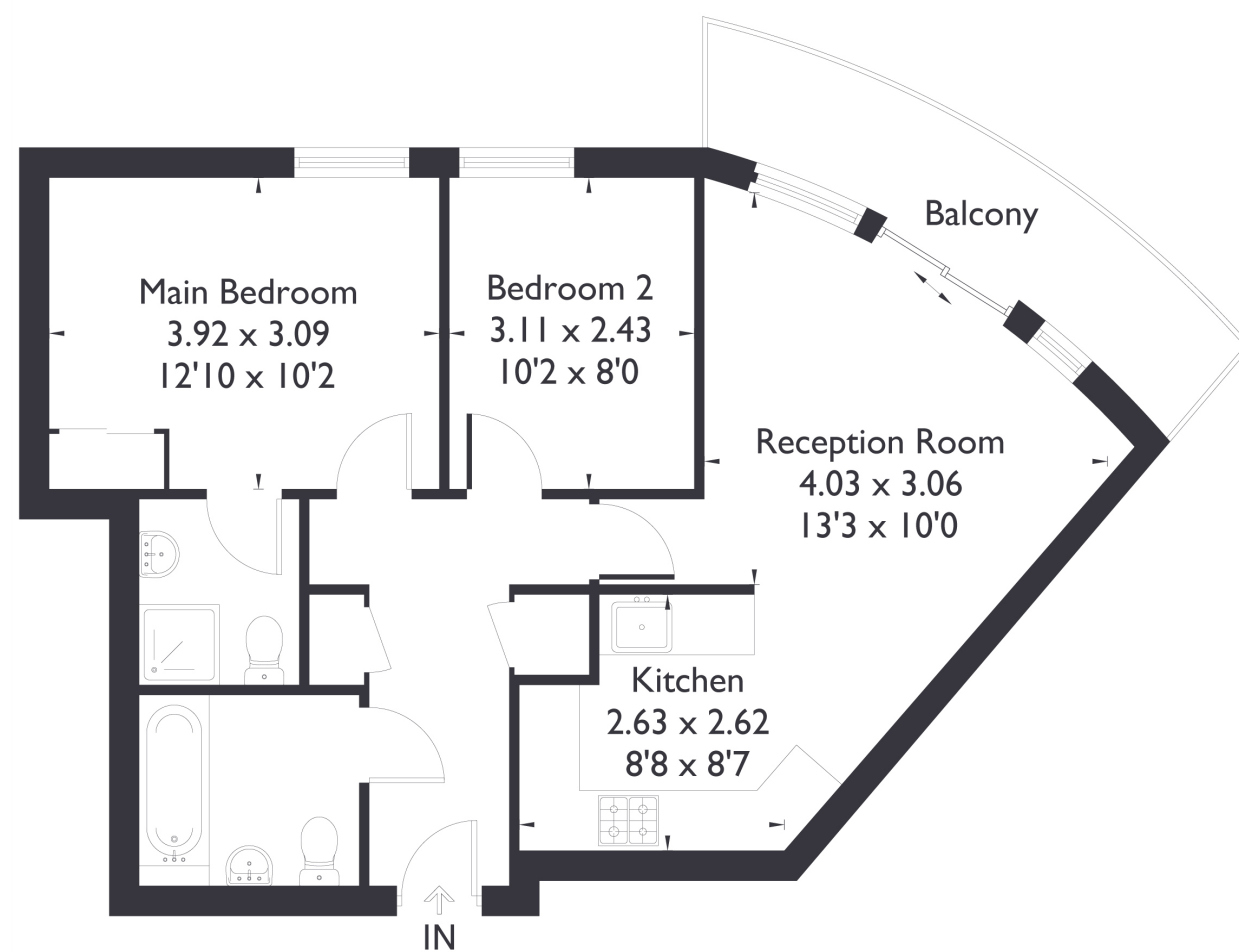

## Second Floor



### 2 BEDROOM FLAT

## Victoria Road, W3

£375,000

Welcome to this well presented two bedroom, two bathroom apartment, ideally located in the heart of North Acton.

Just moments—literally 60 seconds—from North Acton Tube Station (Central Line), this property offers exceptional access to transport links, including the A40, making it perfect for commuters.

### FEATURES

- Two Bedrooms
- Two Bathrooms
- Integrated Kitchen Appliances
- North Acton Station
- Local Amenities Nearby
- Easy Access To A40
- EPC Rating B





## 2 BEDROOM FLAT

# Victoria Road, W3

The apartment features two generously sized double bedrooms, one with a modern en-suite, and a separate family bathroom.

The spacious open-plan living and dining area opens out onto a private balcony, perfect for relaxing or entertaining.

Residential parking is also available, and the property is surrounded by a great selection of local amenities, shops, and cafés.

Whether you're a first-time buyer, professional couple, or investor, this apartment combines comfort, convenience, and connectivity in one of West London's most up-and-coming locations.

EPC rating B.

