



- Two Double Bedrooms
- Turn Key Condition
- Modern Kitchen
- Family Bathroom
- Living/Dining Room With French Doors Leading To Rear Garden
- Downstairs Cloakroom
- Low Maintenance Rear Garden
- Drive Way For Two Vehicles

**21 Nightingale Drive, Halstead, Essex.  
CO9 2FQ.**

Situated on a sought-after and well-maintained estate, this stylish two-bedroom semi-detached home offers contemporary living with practical features throughout. Boasting a private driveway with space for two vehicles and convenient side access, the property combines comfort and convenience.





# Property Details.

## ROOM MEASUREMENTS

Entrance Hall

Living/Dining Room



17' 5" x 14' 10"  
(5.31m x 4.52m)

## Kitchen



9' 10" x 7' 1" (3.00m  
x 2.16m)

W.C

# Property Details.

## First Floor

### Bedroom One



14' 2" x 10' 8" (4.32m x 3.25m)

### Bedroom Two



12' 8" x 8' 3" (3.86m x 2.51m)

## Bathroom



7' 3" x 7' 0" (2.21m x 2.13m)

## Rear Garden



# Property Details.

## Floorplans

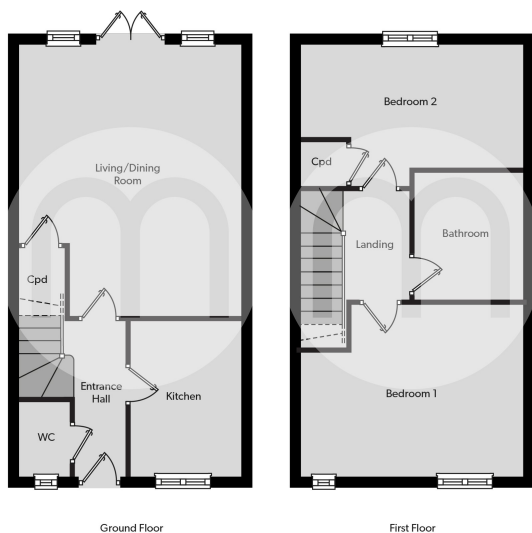

## Location

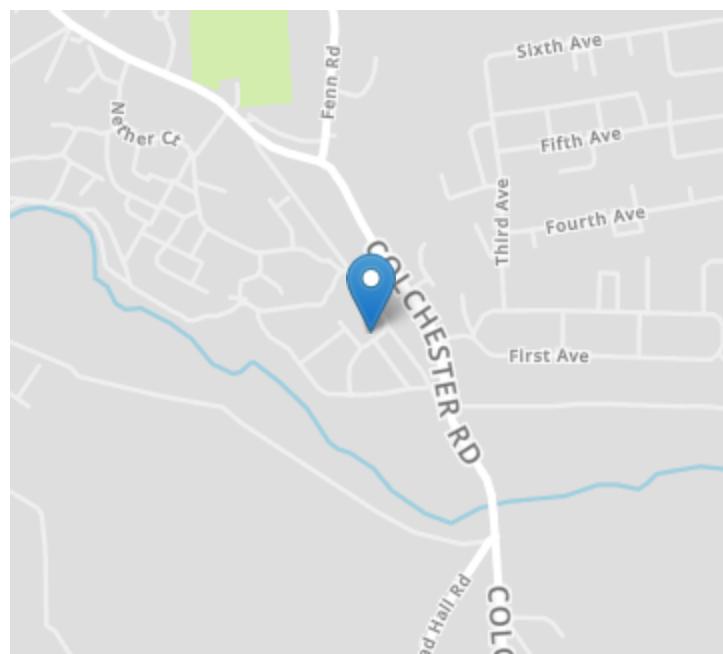

## Energy Ratings

We have not carried out a structural survey and the services, appliances and specific fittings have not been tested. All photographs, measurements, floor plans and distances referred to are given as a guide only and should not be relied upon for the purchase of carpets or any other fixtures or fittings. Gardens, roof terraces, balconies and communal gardens as well as tenure and lease details cannot have their accuracy guaranteed for intending purchasers. Lease details, service ground rent (where applicable) are given as a guide only and should be checked and confirmed by your solicitor prior to exchange of contracts.