



Old Kent Road

£400,000

## Old Kent Road, London SE1 5XG

A beautifully presented fourth floor, two bedroom flat having undergone recent refurbishment, designed and carefully curated by a team of interior designers providing a unique, stylish interior. Located within The Kingsley Flats, this popular development is located close to Tower Bridge Road, enjoying proximity to Bermondsey Street, London Bridge and the City via Tower Bridge. Elephant & Castle, Borough and London Bridge stations are all a walk away.

This superb flat comprises entrance area, opening to reception room with dining area, open plan fitted kitchen with work tops and integrated appliances, master bedroom, guest bedroom two and bathroom with modern suite. The apartment has a number of period features including high ceilings and bay window. Communal facilities include basketball court, outdoor gym area and communal roof terrace. The Kingsley Flats are conveniently located on The Old Kent Road which provides a number of bus routes linking to central London, Tower Bridge Road, Bermondsey Street and London Bridge are all close by.

- The Kingsley Flats SE1
- Fourth Floor
- Well Designed Accommodation
- Excellant Location
- Two Bedroom Flat
- Immaculate Condition
- Stylish Interior
- Chain Free

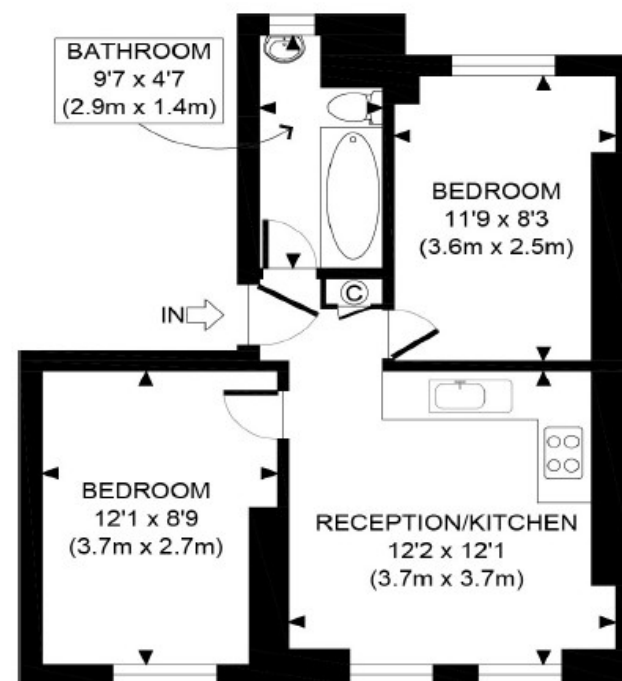

GROSS INTERNAL FLOOR AREA 515 SQ FT

FOURTH FLOOR







