

COURT

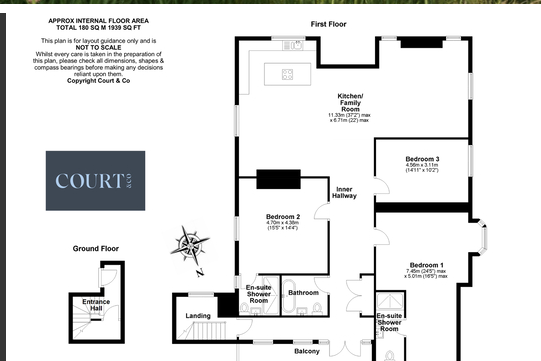

Birley Grange First Floor Apartment, Hall Lane, Shenfield, Brentwood, Essex, CM15 9AL, GUIDE PRICE £1,000,000

*** COMING SOON *** A stunning three-bedroom apartment that spans an entire floor of a magnificent period building, and is nestled within an exclusive gated development of just ten properties. Ideally situated within walking distance of Shenfield's mainline railway station and bustling shopping Broadway, this newly converted residence has been finished to an exceptionally high standard. Boasting nearly 2,000 square feet of elegant living space, the apartment features three generous double bedrooms and a vast open-plan kitchen, dining, and living area. The stunning shaker-style kitchen is equipped with premium Siemens appliances, while the master en-suite and family bathroom showcase exquisite Porcelanosa tiling, Duravit sanitary ware, and luxurious Dornbracht brassware. A perfect blend of contemporary refinement and timeless period charm, this exceptional home offers a truly unique living experience.