



Lesbourne Road, Reigate, RH2

HOUND & PORTER
FIND A HOUSE. MAKE IT HOME

Lesbourne Road, Reigate, RH2



- Three great bedrooms, luxury family bathroom
- Beautiful period features throughout
- Luxury fitted kitchen/family room with skylights
- Flexible accommodation over three floors
- Fantastic living room with open fireplace
- Private parking for one car
- Half a mile to Reigate High Street

Lesbourne Road, Reigate, RH2

Approximate Area = 893 sq ft / 82.9 sq m
For identification only - Not to scale

Denotes restricted
head height

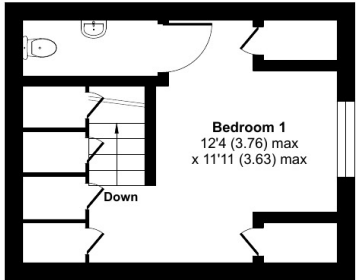

FIRST FLOOR

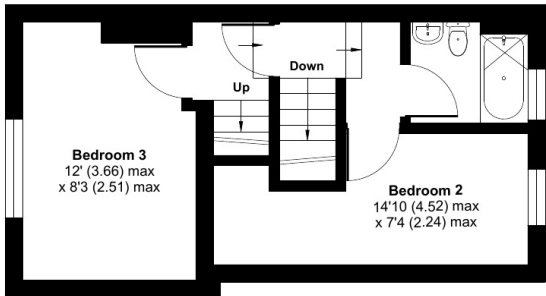

SECOND FLOOR

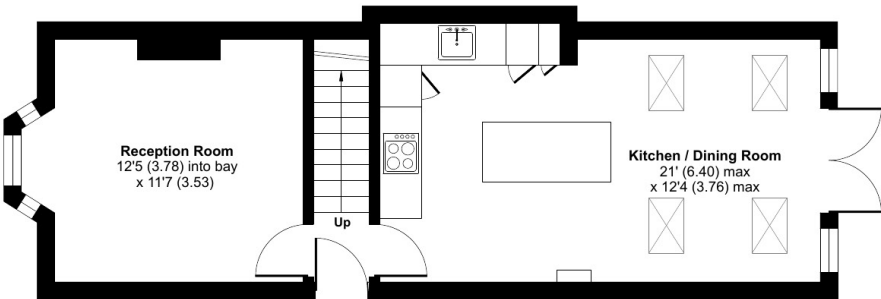

GROUND FLOOR

This fantastic period home is one not to be missed, having been extensively and lovingly modernised by our current owners. The luxurious kitchen/family room is the true hub of this home with ample Corian worksurface, beautiful central monolith island with plenty of seating, high end integrated appliances and a wonderful Belfast sink with copper fittings. The large family table sits with fantastic views over the rear garden through Crittal French doors basking in sunlight through four Velux skylights. Karndean Herringbone flooring flows effortlessly through into a bright and airy living room with central open feature fireplace and a completely renovated bay window with wooden shutters.

Off the first floor landing are two double bedrooms and a contemporary fitted white family bathroom. The master suite is on the second floor with ensuite WC and fabulous views up to Reigate Hill. An enclosed, low maintenance rear garden with entertaining space and private parking conclude this unique period home. To get the perfect feel for the quality of this home why don't you take a peek inside.



Floor plan produced in accordance with RICS Property Measurement Standards incorporating International Property Measurement Standards (IPMS2 Residential). © ncheom 2023. Produced for Hound and Porter Limited. REF: 961796

Lesbourne Road, Reigate, RH2

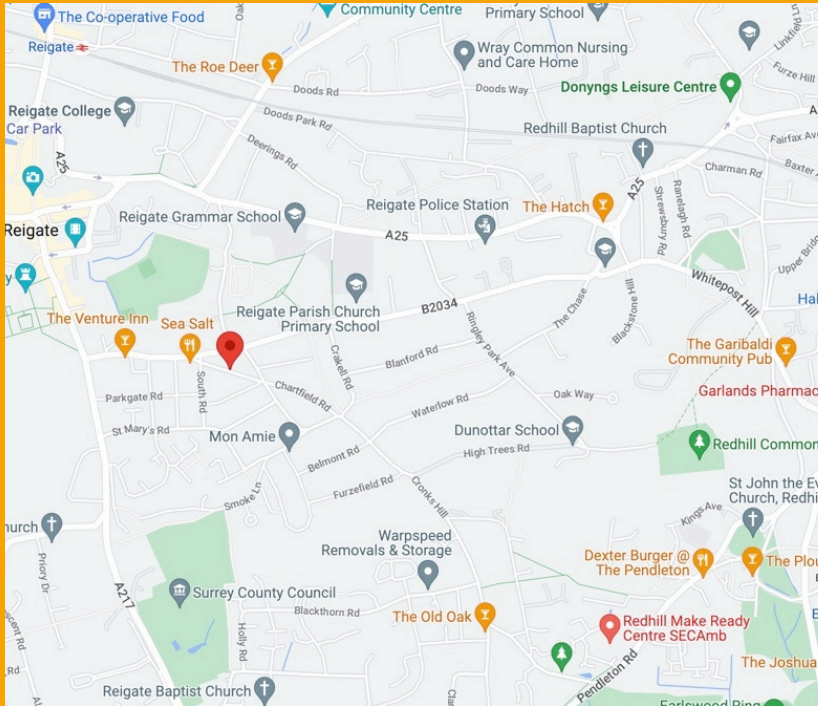

LOCATION

This fabulous home is located just outside Reigate town centre in the very popular Lesbourne village. The town centre is less than 0.5 miles away so a brisk walk will get you there in under ten minutes. The market town of Reigate is brimming with boutique shops, cafes and restaurants, Priory Park offers lovely dog walks and a central children's play area is accompanied by a central cafe. Reigate main line station is under a mile away and offers great links to London and the South Coast. If you are looking for a period home, beautifully presented, this is the property for you.

TRANSPORT

Within easy reach of the A25, M23, M25 and Gatwick Airport with a bus service providing access to Redhill, Reigate and north of the M25

DISTANCE TO STATIONS FROM PROPERTY BY ROAD

• 0.7miles to Reigate Station • 2.0 miles to Redhill Station



DID YOU LIKE WHAT YOU'VE JUST SEEN?

Get in touch. We are more than happy to arrange a viewing, assist you with the complicated paperwork and find you the best local businesses to help during and after your move. We look forward to hearing from you.

58 Castle Walk
Reigate, Surrey
RH2 9PX

01737 317880
hello@houndandporter.co.uk