



George Lane, Royston, Hertfordshire. SG8 9AR

Satchells



1 Bedroom Apartment

£875 pcm

Additional charges may apply

A spacious and well-presented first floor one bedroom apartment situated in the heart of Royston town centre, a short walk from the mainline station shops and local amenities. This property benefits from open plan living with a fitted kitchen, a double bedroom and three piece bathroom suite. Available now on an unfurnished basis. Contact us to arrange a viewing today to avoid disappointment!

- One bedroom apartment
- One double bedroom
- Fitted kitchen with appliances
- Spacious living accommodation throughout
- Three piece bathroom suite
- Gas central heating
- Walking distance to town centre and station
- Available now
- No pets
- EPC rating D. Council tax band A

A spacious and well-presented first floor one bedroom apartment situated in the heart of Royston town centre, a short walk from the mainline station shops and local amenities. This property benefits from open plan living with a fitted kitchen, a double bedroom and three piece bathroom suite. Available now on an unfurnished basis. Contact us to arrange a viewing today to avoid disappointment!

A security deposit is payable at the time of your offer being accepted by the landlord/s. This is equivalent to one weeks rent and for this property is £201.36. This does then form part of your five week holding deposit meaning once all satisfactory references are passed you will then be required to pay £805.47. For more information please contact the office.

Agents Note:

Draft particulars yet to be approved by the vendor and may be subject to change.

Anti-Money Laundering (AML):

It is a legal requirement that all purchasers comply with Anti-Money Laundering regulations. As such, once a purchase has been agreed subject to contract, the purchaser/s will be required to undertake an AML and financial sanctions check carried out by our third party provider at a cost of £66 inclusive of VAT per property, payable by the applicant/s.



These particulars are a guide only and do not constitute an offer or a contract. The floor plan is for identification purposes only and not to scale. All measurements are approximate and should not be relied upon if ordering furniture, white goods and flooring etc. We have presented the property as we feel fairly describes it but before arranging a viewing or deciding to let, should there be anything specific you would like to know about the property please enquire. Satchells have not tested any of the appliances or carried out any form of survey and advise you to carry out your own investigations on the state, condition, structure, services, title, tenure, and council tax band of the property or the tenancy terms. Some images may have been enhanced and the contents shown may not be included in the letting. Satchells routinely refer to 3rd party services for which we receive an income from their fee. If you would like us to refer you to one of these services please ask one of our staff who will pass your details on. We advise you check the availability of the property on the day of your viewing.

Satchells

First Floor

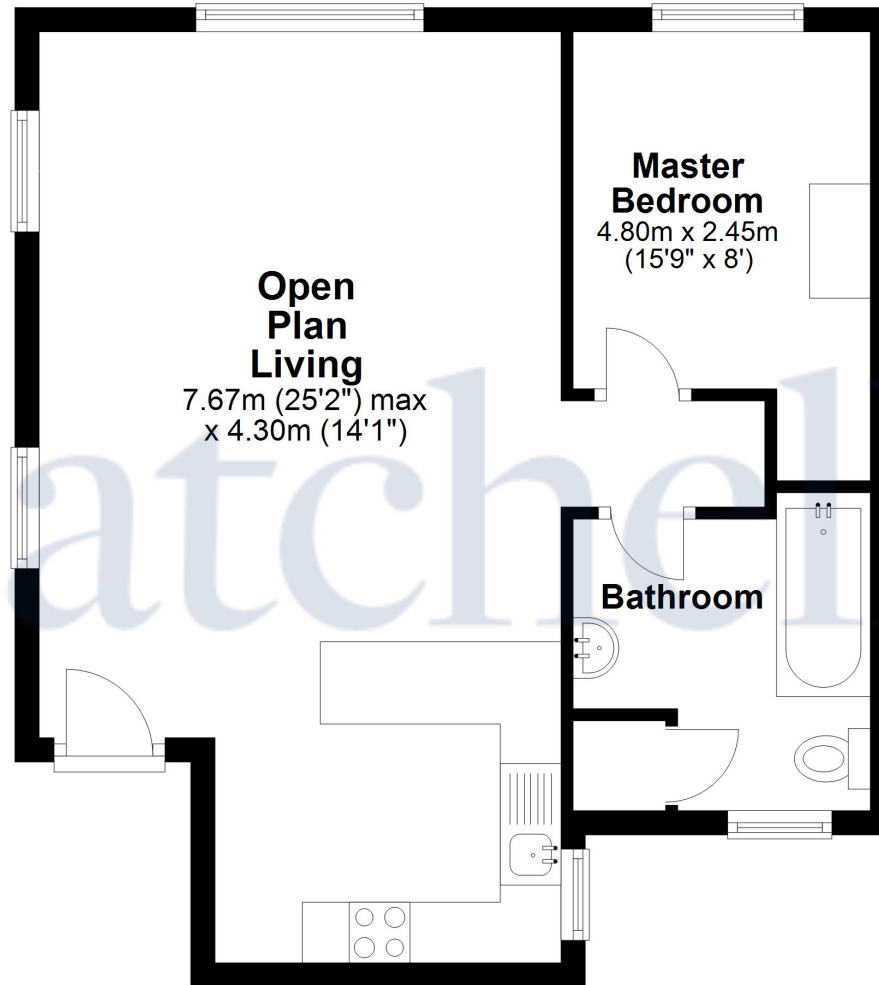

For illustration purposes only - NOT TO SCALE - Measurements shown are approximate. The size and position of doors, windows, appliances and other features are approximate. Plan produced using PlanUp.
Plan produced using PlanUp.