

Truuli



Parchmore Road, Thornton Heath, Surrey, CR7 8LU

£250,000 Leasehold

- Private balcony and communal garden
- Larger than average one bedroom flat
- High ceilings and good natural lighting throughout
- Over 100 year lease
- Well maintained and presented throughout
- Close to all local transport and amenities

Southbridge Place, Surrey, CR0 4HA

Tel: 0330 043 0002

Email: save@truuli.co.uk Web: www.truuli.co.uk

Parchmore Road, Thornton Heath, Surrey, CR7 8LU

£250,000 Leasehold

We are pleased to offer to the open market this larger-than-average one-bedroom flat with a private balcony and access to communal gardens on Parchmore Road, Thornton Heath.

The property is situated on one of the area's most popular roads near a range of local amenities, including Thornton Heath station.

Communal Garden
0 sq.ft. (0.0 sq.m.) approx.

First Floor
637 sq.ft. (59.2 sq.m.) approx.

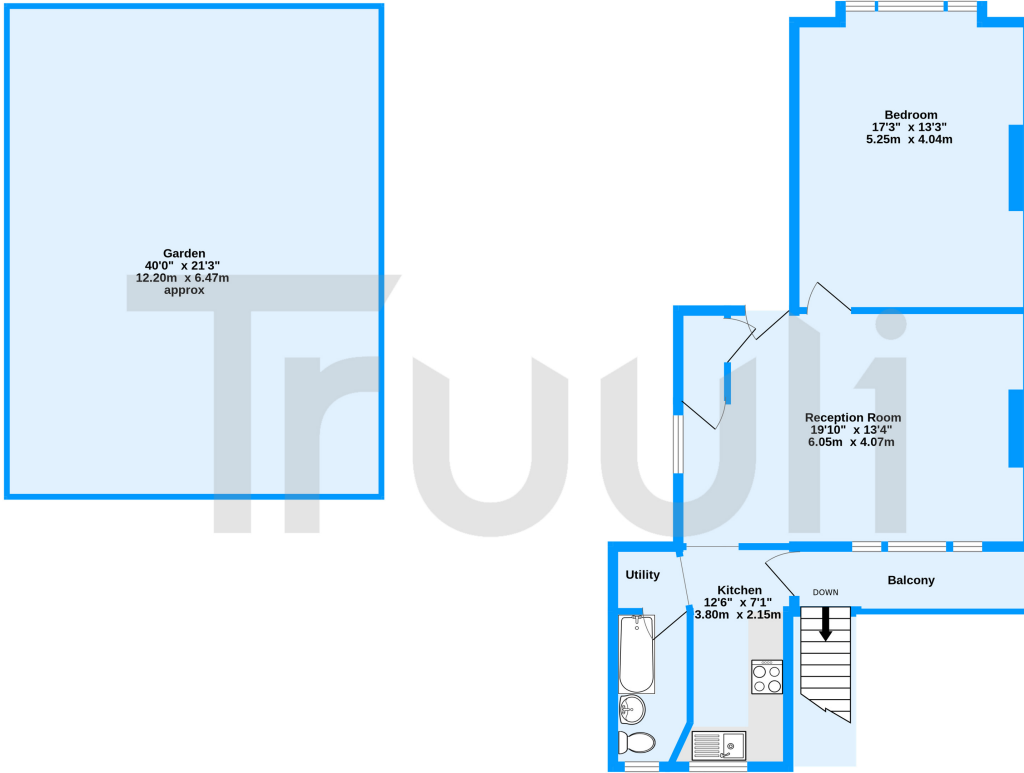

Parchmore Road, Thornton Heath, CR7

TOTAL FLOOR AREA: 637 sq.ft. (59.2 sq.m.) approx.
Measurements are approximate. Not to scale. Illustrative purposes only
Made with MetroPro ©2024

Energy Efficiency Rating		Current	Potential
Very energy efficient - lower running costs			
(92+)	A		
(81-91)	B		
(69-80)	C		
(55-68)	D	70	80
(39-54)	E		
(21-38)	F		
(1-20)	G		
Not energy efficient - higher running costs			
England, Scotland & Wales		EU Directive 2002/91/EC	

