



christopheredwards
estate agents

324 Rayners Lane
Pinner
Middlesex
HA5 5ED



MINEHEAD COURT, HARROW

£1,700 pcm

**** AVAILABLE IMMEDIATELY **** A two double bedroom first floor flat, conveniently located for shops, schools and transport links. The property briefly comprises entrance hallway, spacious lounge, modern fitted kitchen with appliances, two double bedrooms and a modern fitted family bathroom. Other benefits include gas central heating, double glazing, well maintained communal garden and secure entry phone system.

- AVAILABLE IMMEDIATELY
- TWO DOUBLE BEDROOM FIRST FLOOR FLAT
- SPACIOUS AND WELL MAINTAINED THROUGHOUT
- SPACIOUS LIVING ROOM
- MODERN FITTED KITCHEN
- DOUBLE GLAZING AND GAS CENTRAL HEATING
- CONVENIENTLY LOCATED FOR SHOPS, SCHOOLS AND TRANSPORT LINKS
- SECURE ENTRY PHONE SYSTEM

Entrance Hall

Living Room

18' 1" x 12' 1" (5.51m x 3.68m)

Kitchen

12' 8" x 9' 4" (3.86m x 2.84m)

Bedroom 1

12' 8" x 8' 8" (3.86m x 2.64m)

Bedroom 2

10' 2" x 8' 11" (3.10m x 2.72m)

Bathroom

9' 3" x 5' 3" (2.82m x 1.60m)

Communal Garden



DISCLAIMER: These particulars, whilst believed to be accurate are set out as a general outline only for guidance and do not constitute any part of an offer or contract. Intending purchasers should not rely on them as statements or representation of fact, but must satisfy themselves by inspection or otherwise as to their accuracy. We have not carried out a detailed survey nor tested the services, appliances and specific fittings. Room sizes should not be relied upon for carpets and furnishings. The measurements given are approximate. No person in this firms employment has the authority to make or give any representation or warranty in respect of the property.

GROUND FLOOR
622 sq.ft. (57.8 sq.m.) approx.

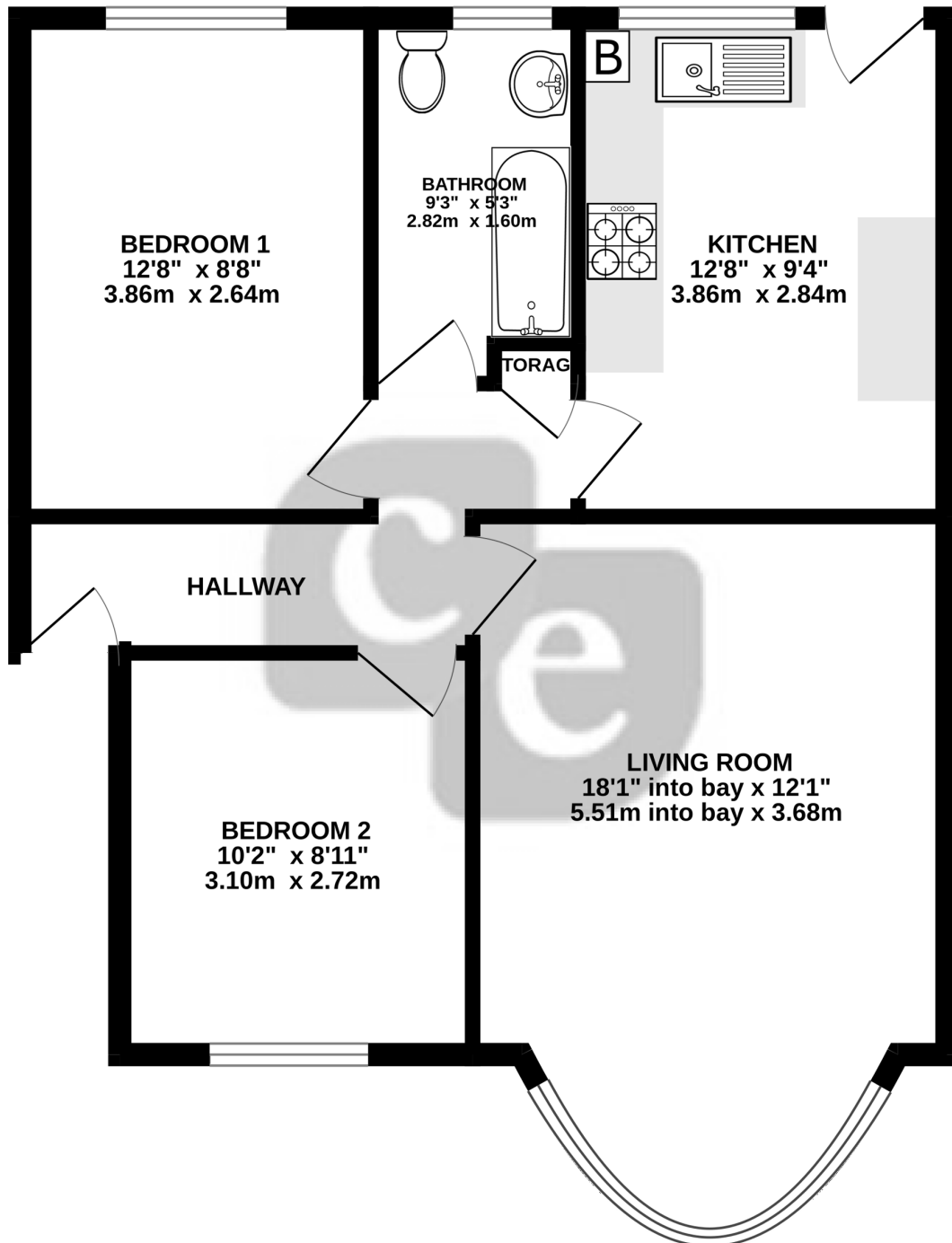

TOTAL FLOOR AREA : 622 sq.ft. (57.8 sq.m.) approx.

Whilst every attempt has been made to ensure the accuracy of the floorplan contained here, measurements of doors, windows, rooms and any other items are approximate and no responsibility is taken for any error, omission or mis-statement. This plan is for illustrative purposes only and should be used as such by any prospective purchaser. The services, systems and appliances shown have not been tested and no guarantee as to their operability or efficiency can be given.

Made with Metropix ©2026