



**Lowestoft Court Apartments**  
**146, London Road South**  
**Lowestoft**  
**Suffolk**  
**NR33 0FE**

**Offers in Excess of £105,000**

**bettermove**

# 146, London Road South Suffolk

Bettermove are proud to present this modern 1 bedroom flat in Lowestoft available with no forward chain.

The property benefits from double glazing, electric heating throughout and has ample parking nearby for permit holders only. The council tax band is to be confirmed.

This is a leasehold property with 990 years remaining on the lease; there is no ground rent and the service charge is £600 per annum.

The interior of this beautifully presented property comprises a spacious and open plan living room with fitted kitchen and dining area, one double bedroom and the bathroom on the first floor of the building.

Located in the popular residential area of Lowestoft, the property is close to a range of amenities, including shops, supermarkets, restaurants and pubs. Excellent transport connections can be found from Lowestoft Train Station, the A12 and many local bus routes.

This exciting opportunity should not be missed! All enquiries can be made through Bettermove on 0330 004 0050.



# FLAT 6

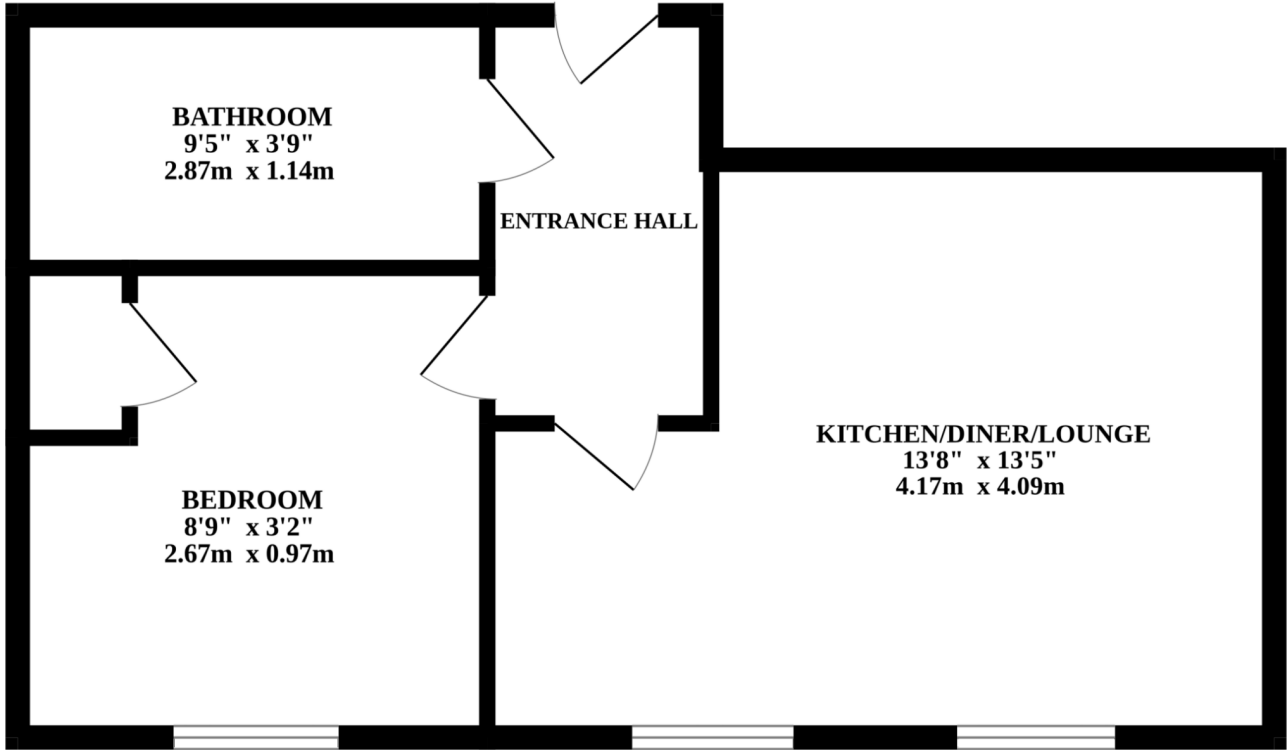

Whilst every attempt has been made to ensure the accuracy of the floorplan contained here, measurements of doors, windows, rooms and any other items are approximate and no responsibility is taken for any error, omission or mis-statement. This plan is for illustrative purposes only and should be used as such by any prospective purchaser. The services, systems and appliances shown have not been tested and no guarantee as to their operability or efficiency can be given.  
 Made with Metropix ©2023

Energy Efficiency Rating		
	Current	Potential
Very energy efficient - lower running costs		
(92+) <b>A</b>		
(81-91) <b>B</b>		
(69-80) <b>C</b>	80	80
(55-68) <b>D</b>		
(39-54) <b>E</b>		
(21-38) <b>F</b>		
(1-20) <b>G</b>		
Not energy efficient - higher running costs		
<b>England, Scotland &amp; Wales</b>	EU Directive 2002/91/EC	



20-22 Bridge End, Leeds, LS1 4DJ  
t: 0330 004 0050 e: hello@bettermove.co.uk  
[www.bettermove.co.uk](http://www.bettermove.co.uk)