

FOR  
SALE



Vernon Close, West Ewell, Surrey KT19 9AL

£250,000 - Leasehold

252, Chessington Road, Ewell, Epsom, KT19 9XF 0208 394 2555 [sales@jacksonnoon.com](mailto:sales@jacksonnoon.com)





## PROPERTY SUMMARY

JACKSON NOON ESTATE AGENTS are pleased to offer this MODERN ONE BEDROOM GROUND FLOOR APARTMENT with MODERN KITCHEN AND BATHROOM, double glazing, ALLOCATED PARKING, communal gardens.....LOCATED IN A CUL DE SAC.....CALL NOW TO VIEW.

## POINTS OF INTEREST

- *Ground Floor Flat*
- *One Bedroom*
- *Modern Kitchen & Bathroom*
- *Double Glazing*
- *Communal Gardens*
- *Allocated Parking*



## ROOM DESCRIPTIONS

### Front Door to

#### Communal Entrance

Door to

#### Entrance Hall

Cloaks Hanging space, wood floor, electric radiator

#### Lounge

12' 0" x 11' 10" (3.66m x 3.61m) Electric radiator, wood floor, double glazed window, double glazed doors to garden

#### Modern Kitchen

8' 8" x 7' 8" (2.64m x 2.34m) Single drainer stainless steel sink unit inset in roll top work surface, range of cupboards and units, space for fridge, plumbing for autowash, fitted oven and hob, extractor, double glazed window

#### Bedroom 1

11' 3" x 9' 5" (3.43m x 2.87m) Electric radiator, airing cupboard, fitted wardrobes, double glazed window

#### Modern Bathroom

Comprising panel enclosed bath with mixer tap and shower attachment, low level wc, wash hand basin, heated towel rail, tiled walls

### Outside

#### Communal Gardens

Mainly laid to lawn

#### Allocated Parking

## Servalan Court

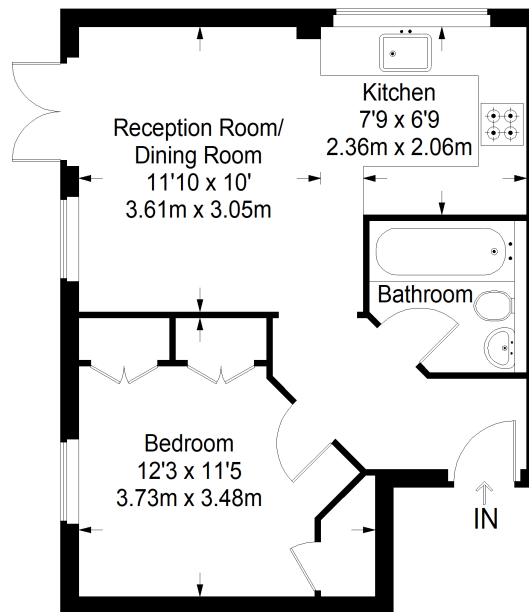

**Ground Floor = 406 sq ft**

Approximate Gross Internal Area  
GROUND FLOOR = 406 sq ft / 37.72 sq m  
Total = 406 sq ft / 37.72 sq m

This plan is for layout guidance only. Not drawn to scale unless stated. Windows and door openings are approximate. Whilst every care is taken in the preparation of this plan, please check all dimensions, shapes and compass bearings before making any decisions reliant upon them. (ID357409)