

**FOR SALE**

£530,000 Share of Freehold



## Flat 23, 77 Woodside Grange, Holden Road, London, N12 7DP

- Twp Bedrooms
- Reception
- Kitchen
- Two Bathrooms
- Large Loft for Storage
- Underground Parking
- Extensive Communal Gardens
- Council Tax Band F
- Share of Freehold





## PROPERTY DESCRIPTION

---

A top floor two bedroom, two bathroom apartment with share of freehold. Benefits include fitted kitchen, underground parking, extensive communal gardens and large loft for storage. Conveniently located for North Finchley's shopping and transport amenities and within only 322 feet of Woodside Park tube station. Council Tax Band F



## ROOM DESCRIPTIONS

---



# FLOORPLAN & EPC

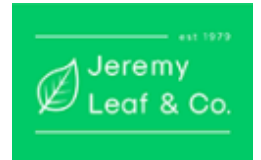

Approx Gross Internal Area  
63 sq m / 679 sq ft

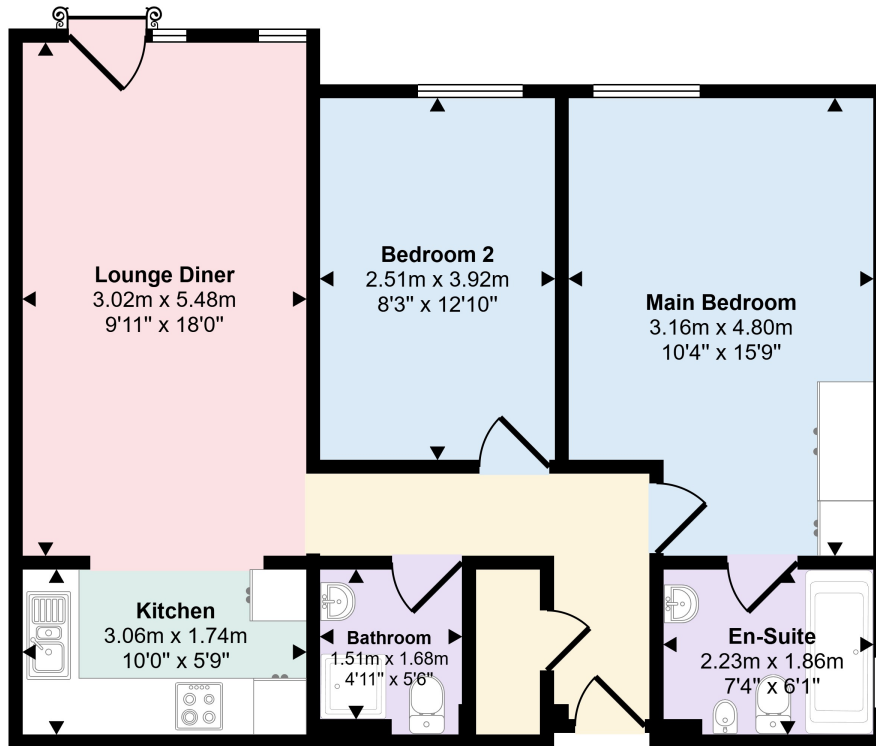

Floorplan

This floorplan is only for illustrative purposes and is not to scale. Measurements of rooms, doors, windows, and any items are approximate and no responsibility is taken for any error, omission or mis-statement. Icons of items such as bathroom suites are representations only and may not look like the real items. Made with Made Snappy 360.

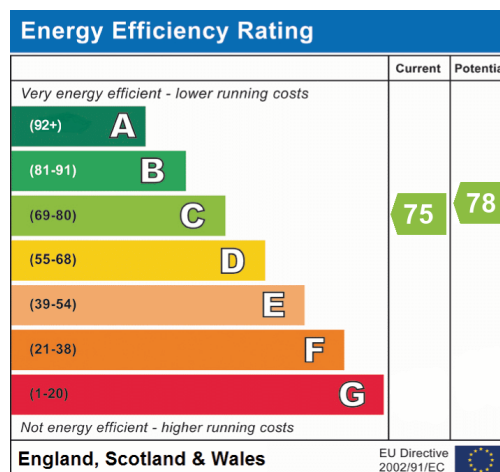

North Finchley  
863, High Road, London, N12 8PT  
020 8446 4295  
property@jeremyleaf.co.uk