



Two Bedroom End of Terrace House
Heritage Road, Walderslade, Chatham, Kent, ME5 7ST

£260,000
Freehold

Heritage Road, Walderslade, Chatham, Kent, ME5 7ST

£260,000

Freehold

Description

This two bedroom End Of Terrace home is being offered with no forward chain and is an ideal purchase for first time buyers or investors.

The property offers open plan living space with dining area and kitchen with fitted units and work surfaces.

Upstairs are two double bedrooms and bathroom.

There is an enclosed rear garden which sits on a corner plot, an opportunity to extend subject to relevant planning permission, with raised decking area ideal for chilling and unwinding.

There is allocated parking space to the front of the property.

Please call the sales team for further details.

Key Features

- No Onward Chain
- Two Bedroom House
- Ideal First Time Buy
- Allocated Parking Space To The Front
- Popular Location
- Cul-De-Sac Position
- Corner Plot Garden

Local Area

Walderslade is within reach of local primary and secondary schools, shopping parades, doctors surgery and dentist. Being close to Chatham and Maidstone town centres, Capstone Valley Ski and Snowboard Centre, Historic Rochester and Docksider centre plus Bluewater Shopping Centre being approximately 20 minutes away by car. The area offers good transport links to the A2/M2, M20 and M25 plus Ebbsfleet International and Ashford.

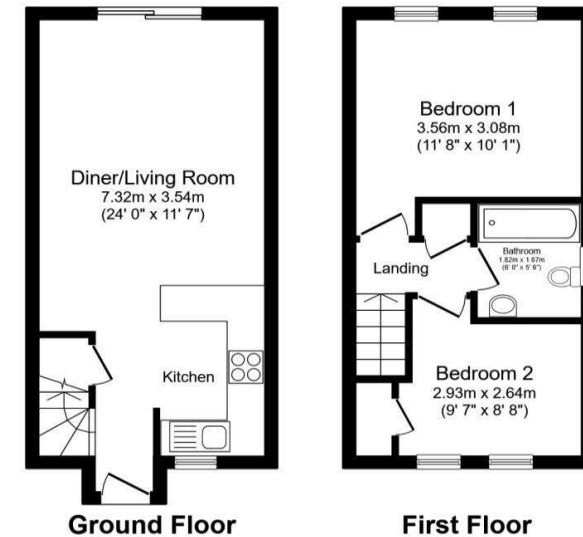

Total floor area 53.4 sq.m. (575 sq.ft.) approx

This floor plan is for illustrative purposes only. It is not drawn to scale. Any measurements, floor areas (including any total floor area), openings and orientation are approximate. No details are guaranteed, they cannot be relied upon for any purpose and they do not form part of any agreement. No liability is taken for any error, omission or misstatement. A party must rely upon its own inspection(s).
Plan produced for Your Move. Powered by www.focalagent.com

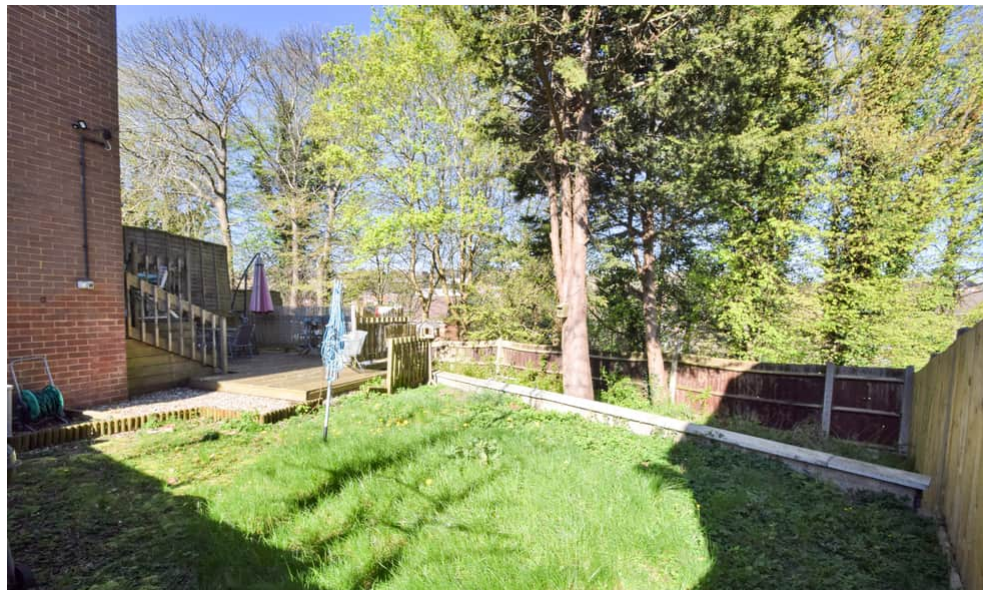

Property Location

Heritage Road, Walderslade, Chatham, Kent, ME5 7ST

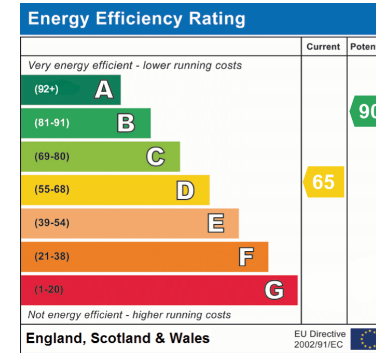

| | |
|------------------------|----------|
| Tenure | Freehold |
| Lease Term | n/a |
| Ground Rent | n/a |
| Service Charge | n/a |
| Local Authority | Medway |
| Council Tax | Band B |

Greyfox Walderslade

Unit 2, Thetford House
Walderslade Village Centre
Walderslade Road
Chatham
Kent
ME5 9LR
Tel: 01634 672227 Email:
walderslade@greyfox.co.uk

Greyfox Rainham

67C High Street
Rainham
Kent
ME8 7HS
Tel: 01634 377737 Email:
rainham@greyfox.co.uk

Agent Notes

These particulars are prepared as a general guide to a broad description of the property and should not be relied upon as a statement or representation of fact and do not constitute part of an offer or contract. The seller does not make or give nor do our employees or Greyfox have authority to make or give any representation or warranty to the property. We have not carried out a structural survey and the services, appliances and specific fittings have not been tested. All photographs, measurements, floorplans and distances referred to are given as a guide only and should not be relied upon for the purchase of carpets or any other fixtures or fittings. Lease details, service charges and ground rent (where applicable) and council tax are given as a guide only and should be checked and confirmed by you on inspection and your solicitor prior to exchange of contracts. If there are any points of particular importance to you we will be pleased to check the information for you and to confirm that the property remains available. This is particularly important should you be travelling some distance to view and where statements have been made by us to the effect that the information has not been verified. The copyright of all details, photographs and floorplans remain exclusive to Greyfox. For details of our privacy policy and referral fee arrangements with any of our selected partner companies please visit <https://www.greyfox.co.uk/legal/privacy> and <https://www.greyfox.co.uk/referral-fees>.