



NEWSON & BUCK
ESTATE AGENTS



25 Barsham Drive, South Wootton, King's Lynn, Norfolk PE30 3TT £309,995

Newson & Buck are proud to offer to the market this very well presented two bedroom detached bungalow situated in the popular village of South Wootton. The accommodation comprises entrance hall, kitchen, utility, lounge, two bedrooms and a bathroom. The property further benefits from off road parking for numerous vehicles, double glazing, gas central heating and a garage. Local amenities can be found within walking distance in the village including a chemist and primary school, with more extensive facilities found in King's Lynn Town Centre including a main line rail link into Cambridge and London King's Cross.

UPVC front door opening to entrance hallway, fitted carpets, two storage cupboards, one radiator

11' 10" x 18' 8" (3.61m x 5.69m) Fitted carpet, one radiator, two double glazed windows

10' 02" x 28' 8" (3.10m x 8.74m) Three double glazed windows, fitted kitchen units, stainless steel sink drainer, space for dishwasher, gas oven and hob with over head extractor, door leading to rear garden

14' 1" x 11' 0" (4.29m x 3.35m) Fitted carpets, one double glazed window, one radiator, two fitted wardrobes

10' 6" x 9' 2" (3.20m x 2.79m) Fitted carpets, one radiator, one double glazed window

6' 09" x 6' 0" (2.06m x 1.83m) Tiled flooring, low flush W/C, bathtub, shower, pedestal sink, towel radiator, one double glazed window

Tiled flooring, one double glazed window, low flush W/C, pedestal sink, one radiator

Tiled flooring, space for washing machine and tumble dryer, low flush w/c and hand basin.

10' 8" x 18' 1" (3.25m x 5.51m) Electric up and over door, lighting, door to rear garden, work shop bench and unit to rear

Council Tax Band C



GROUND FLOOR

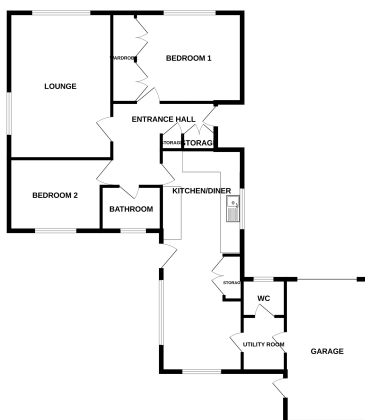

While every attempt has been made to ensure the accuracy of the figures contained here, measurements of doors, windows, rooms and any other items are approximate and no responsibility is taken for any error, omission or mis-statement. This plan is for illustrative purposes only and should be used as such by any prospective purchaser. The structures, systems and appliances shown have not been tested and no guarantee as to their capacity or efficiency can be given.