

Truuli



Fairview Road, London, SW16 5PX

£575,000 Freehold

- Freehold house
- Demised as two (no planning)
- High ceiling and wide rooms
- Close to Norbury mainline station
- Easy access of a local 24 Hour Gym
- In need of some cosmetic updating

Southbridge Place, Surrey, CR0 4HA

Tel: 0330 043 0002

Email: save@truuli.co.uk Web: www.truuli.co.uk

Fairview Road, London, SW16 5PX

£575,000 Freehold

A rare opportunity to acquire this handsome 3-bedroom period property located on the ever-popular Fairview Road in the heart of Norbury.

Full of character and original features, this substantial home is currently arranged as two self-contained flats, without planning permission, offering the ideal project for those looking to restore a beautiful family residence or maximise investment potential.

The ground floor comprises a spacious two-bedroom flat, complete with a modern shower room and direct access to a private rear garden; perfect for outdoor dining or relaxing in the sun. The first floor offers a generous one-bedroom flat with a full bathroom and bright, airy living spaces.

While there is no garden access from the upper floor, the layout provides flexibility for reconfiguration or returning the property to its original single-dwelling format.

Fairview Road

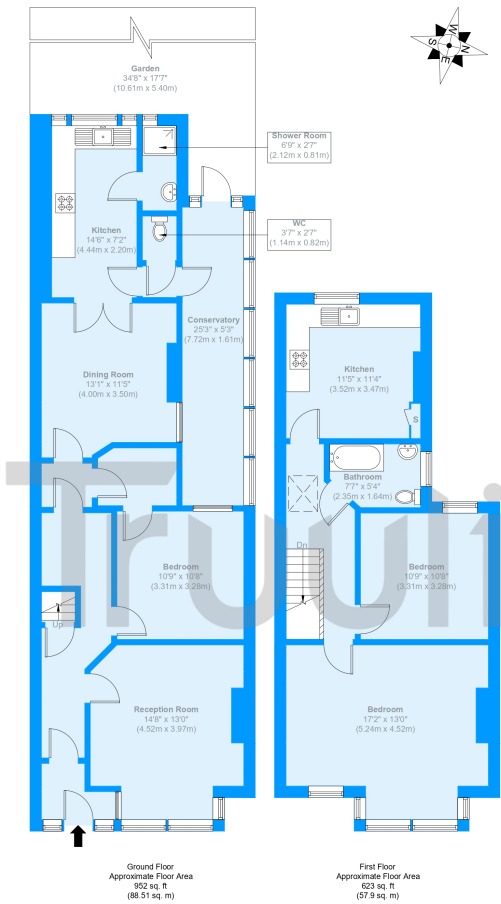

Approximate Gross Internal Area = 146.41 sq m / 1575 sq ft

The Floor plan is not to scale and measurements and areas shown are approximate and therefore should be used for illustrative purposes only. The plan has been prepared in accordance with the RICS code of Measuring Practice and whilst we have confidence in the information produced it must not be relied on. Maximum lengths and widths are represented on the floor plan. If there is any aspect of particular importance, you should carry out or commission your own inspection of the property.
Copyright © BleuPlan

