



Two Bedroom Bungalow
Severn Road, Lords wood , Kent, ME5 8JN

Offers Over £300,000
Freehold

Severn Road, Lords wood , Kent, ME5 8JN

Offers Over £300,000

Freehold

Description

This bungalow is all on one level and situated in a popular road. An ideal property for ease of maintenance. Accommodation comprises: Entrance porch of generous proportion with built in cupboards for storage. The Lounge/Dining room is of a good size with an attractive bay window to the front. A Sliding door leads into the modern kitchen. The main bedroom has a range of built in wardrobes. There is a light and airy bathroom. The conservatory opens onto the pretty garden which is laid to lawn with established shrubs, side gate access door units the garage. A paved driveway provides ample parking, Lovely bungalow, must be viewed.

Key Features

- Bungalow
- Semi-detached
- Conservatory
- Secluded garden
- Driveway for 2+ vehicles
- Garage
- Garden 'L' shape approx 50x31'8x14

Local Area

Lords Wood is a suburb of Chatham, located approximately 3 miles outside of Chatham Town Centre. With local amenities including local shops, schools and a sports leisure centre. With frequent bus services in to the main town centres and mainline railway stations. For those who need to commute, the property is close to Kings Ferry commuter coach pick up points and both the M2/M20 motorways servicing the coast and London.

GROUND FLOOR
795 sq.ft. (73.9 sq.m.) approx.

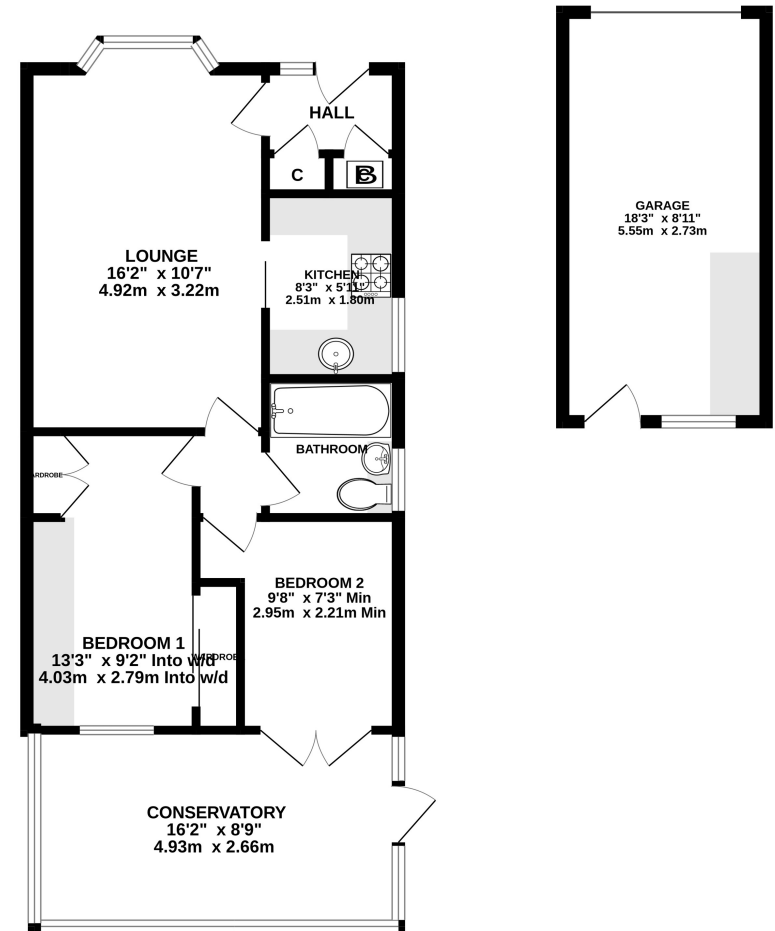

TOTAL FLOOR AREA : 795 sq.ft. (73.9 sq.m.) approx.

Whilst every attempt has been made to ensure the accuracy of the floorplan contained here, measurements of doors, windows, rooms and any other items are approximate and no responsibility is taken for any error, omission or mis-statement. This plan is for illustrative purposes only and should be used as such by any prospective purchaser. The services, systems and appliances shown have not been tested and no guarantee as to their operability or efficiency can be given.
Made with Metropix ©2023



Property Location

Severn Road, Lords wood , Kent, ME5 8JN

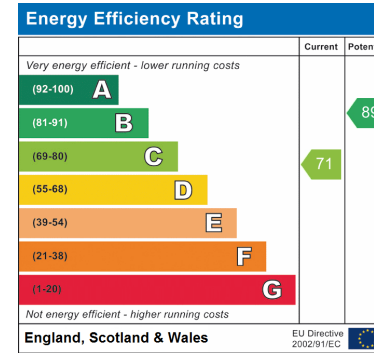
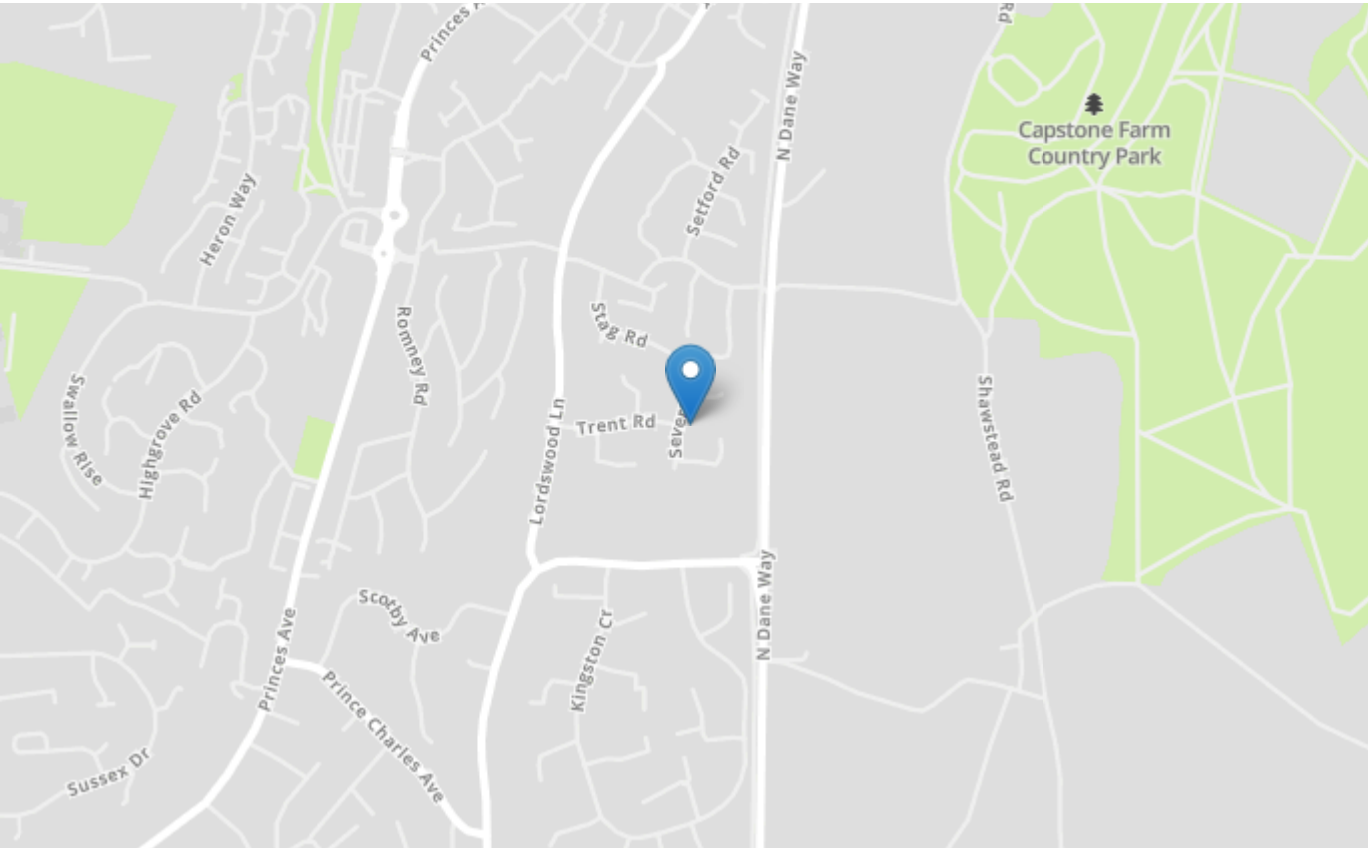

Tenure	Freehold
Lease Term	N/A
Ground Rent	N/A
Service Charge	N/A
Local Authority	Medway council
Council Tax	Band C

Greyfox Walderslade

Unit 2, Thetford House
Walderslade Village Centre
Walderslade Road
Chatham
Kent
ME5 9LR
Tel: 01634 672227 Email:
walderslade@greyfox.co.uk

Greyfox Rainham

67C High Street
Rainham
Kent
ME8 7HS
Tel: 01634 377737 Email:
rainham@greyfox.co.uk

Agent Notes

These particulars are prepared as a general guide to a broad description of the property and should not be relied upon as a statement or representation of fact and do not constitute part of an offer or contract. The seller does not make or give nor do our employees or Greyfox have authority to make or give any representation or warranty to the property. We have not carried out a structural survey and the services, appliances and specific fittings have not been tested. All photographs, measurements, floorplans and distances referred to are given as a guide only and should not be relied upon for the purchase of carpets or any other fixtures or fittings. Lease details, service charges and ground rent (where applicable) and council tax are given as a guide only and should be checked and confirmed by you on inspection and your solicitor prior to exchange of contracts. If there are any points of particular importance to you we will be pleased to check the information for you and to confirm that the property remains available. This is particularly important should you be travelling some distance to view and where statements have been made by us to the effect that the information has not been verified. The copyright of all details, photographs and floorplans remain exclusive to Greyfox. For details of our privacy policy and referral fee arrangements with any of our selected partner companies please visit <https://www.greyfox.co.uk/legal/privacy> and <https://www.greyfox.co.uk/referral-fees>.