



£600 pcm

- ONE BEDROOM HOUSE
- CENTRAL LOCATION
- 01/07/2020
- £600PCM





Thornville Street

45 Thornville Street, Hyde Park, LEEDS, LS6 1JL

£600 pcm

£600PCM - 1 Bedroom - Available 01/07/2020

With new carpets, decoration and furniture throughout this one bedroom house situated in the centre of Hyde Park is one to take note of! With easy access to local amenities and the city centre, it is great for both student and professionals. The property consists of a large lounge, modern kitchen, spacious double bedroom and house bathroom.

Lounge (Reception)

Bathroom

Bedroom

Kitchen

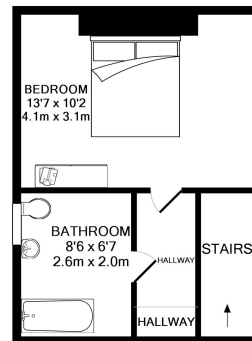
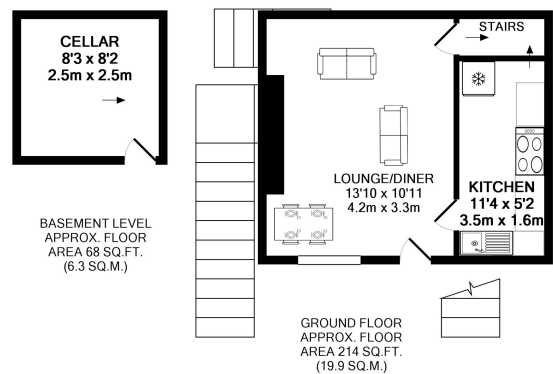

1ST FLOOR
APPROX. FLOOR
AREA 242 SQ. FT.
(22.5 SQ. M.)

TOTAL APPROX. FLOOR AREA 524 SQ. FT. (48.7 SQ. M.)

Whilst every attempt has been made to ensure the accuracy of the floor plan contained here, measurements of doors, windows, rooms and any other items are approximate and no responsibility is taken for any error, omission, or mis-statement. This plan is for illustrative purposes only and should be used as such by any prospective purchaser. The services, systems and appliances shown have not been tested and no guarantee as to their operability or efficiency can be given.
Made with Metropix ©2019