



Two Bedroom Semi-Detached House
Headcorn Road, Twydall, Gillingham, Kent, ME8 6QA

Guide Price £250,000
Freehold

Headcorn Road, Twydall, Gillingham, Kent, ME8 6QA

Guide Price £250,000

Freehold

Description

Guide Price £250,000 - £270,000. Charming & Spacious Two Bedroom Semi-Detached Home in Twydall!

This fantastic chain-free property is brimming with potential! Featuring two generous double bedrooms, a bright lounge, well-appointed kitchen, and a separate dining room, it's the perfect canvas for your creative vision. The wrap-around garden offers plenty of space for outdoor living, with exciting scope for further development, perhaps a stylish extension or off-road parking?

Located in a prime spot, you're just moments from a good selection of schools, convenient transport links, and a great selection of shops and amenities. Don't miss this incredible opportunity to transform this home into something truly special, call Greyfox in Rainham to book your viewing today!

Key Features

- Chain Fee
- Perfect Property To Add Your Own Creative Stamp
- Two Generous Double Bedrooms
- Two Reception Rooms
- Popular Twydall Location
- Semi Detached Family Home
- Close Proximity To A Good Selection Of Primary & Secondary Schools
- South West Facing Wrap Around Garden

Local Area

Located between Rainham and Gillingham Twydall is within reach of Gillingham Business Park and has access to many amenities including the local Ice Rink, Hempstead Valley Shopping centre, a mainline station to London and good links to the A2/M2 and onto the M25, Ebbsfleet & Ashford international and the channel tunnel.

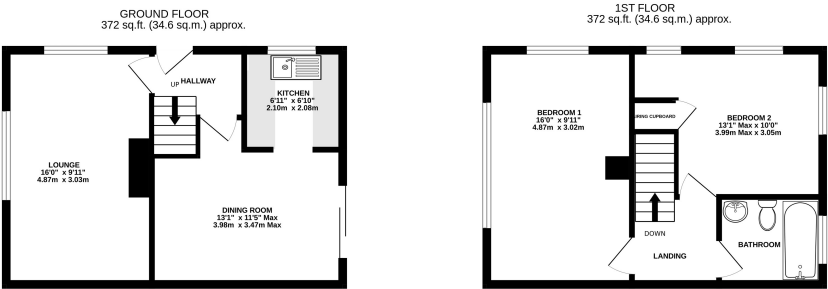

TOTAL FLOOR AREA : 745 sq.ft. (69.2 sq.m.) approx.

Whilst every effort has been made to ensure the accuracy of the floorplan contained here, measurements of doors, windows, rooms and any other items are approximate and no responsibility is taken for any error, omission or mis-statement. This plan is for illustrative purposes only and should be used as such by any prospective purchaser. The services, systems and appliances shown have not been tested and no guarantee as to their operability or efficiency can be given.
Made with Metropix ©2025



Property Location

Headcorn Road, Twydall, Gillingham, Kent, ME8 6QA

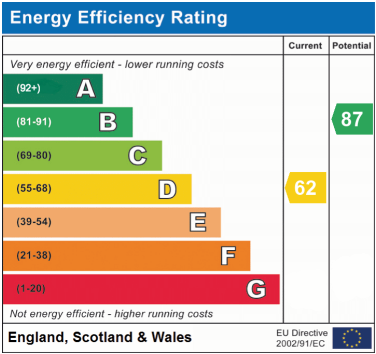
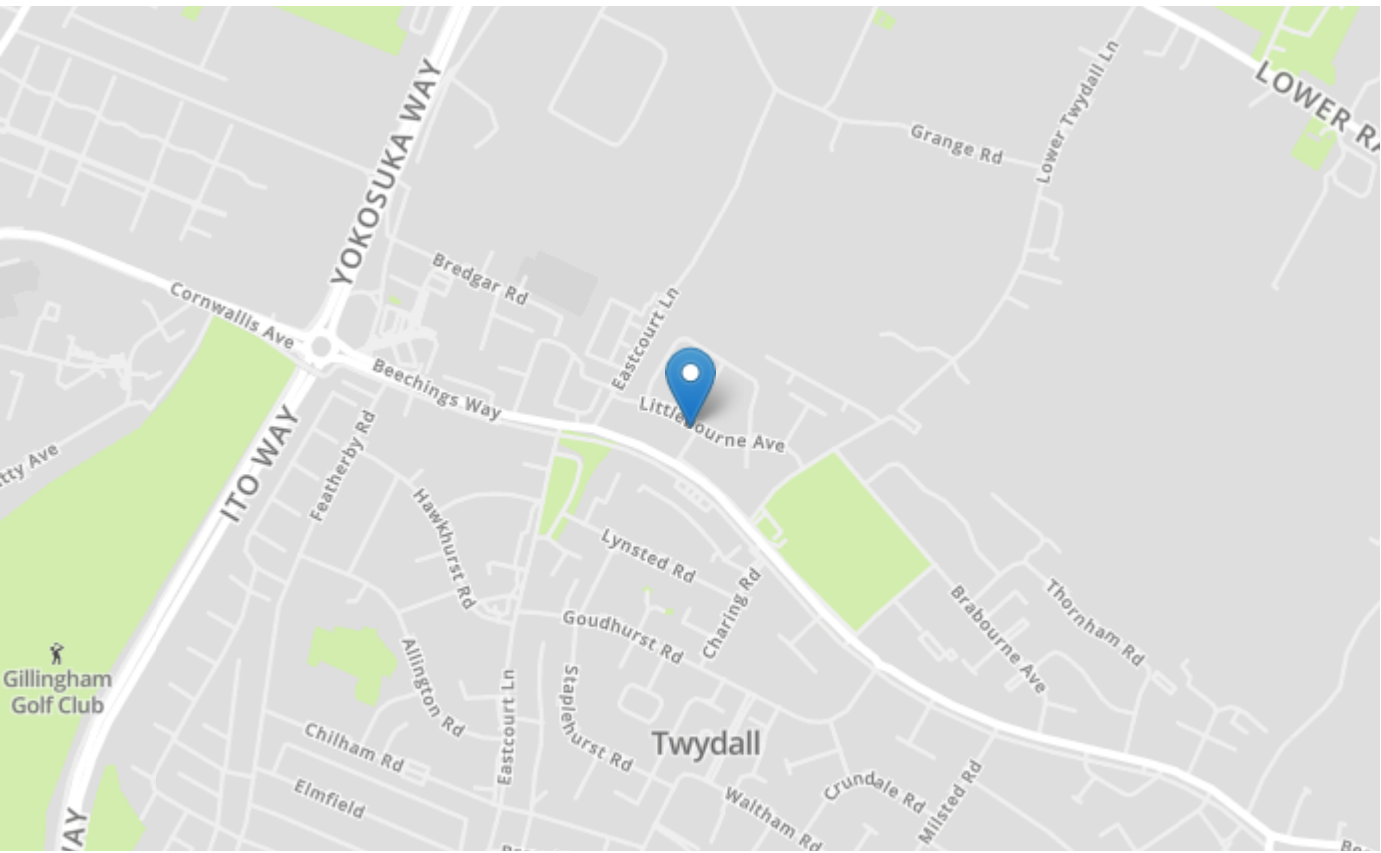

Tenure	Freehold
Lease Term	N/A
Ground Rent	N/A
Service Charge	N/A
Local Authority	Medway
Council Tax	Band B

Greyfox Walderslade

Unit 2, Thetford House
Walderslade Village Centre
Walderslade Road
Chatham
Kent
ME5 9LR
Tel: 01634 672227 Email:
walderslade@greyfox.co.uk

Greyfox Rainham

67C High Street
Rainham
Kent
ME8 7HS
Tel: 01634 377737 Email:
rainham@greyfox.co.uk

Agent Notes

These particulars are prepared as a general guide to a broad description of the property and should not be relied upon as a statement or representation of fact and do not constitute part of an offer or contract. The seller does not make or give nor do our employees or Greyfox have authority to make or give any representation or warranty to the property. We have not carried out a structural survey and the services, appliances and specific fittings have not been tested. All photographs, measurements, floorplans and distances referred to are given as a guide only and should not be relied upon for the purchase of carpets or any other fixtures or fittings. Lease details, service charges and ground rent (where applicable) and council tax are given as a guide only and should be checked and confirmed by you on inspection and your solicitor prior to exchange of contracts. If there are any points of particular importance to you we will be pleased to check the information for you and to confirm that the property remains available. This is particularly important should you be travelling some distance to view and where statements have been made by us to the effect that the information has not been verified. The copyright of all details, photographs and floorplans remain exclusive to Greyfox. For details of our privacy policy and referral fee arrangements with any of our selected partner companies please visit <https://www.greyfox.co.uk/legal/privacy> and <https://www.greyfox.co.uk/referral-fees>.