



**daniels**  
danielsestateagents.co.uk



**Metropolitan Court, High Road, Willesden Green, London NW10 2QD  
£389,000 - Leasehold**



## PROPERTY DESCRIPTION

Located within close proximity to Willesden Green Jubilee line station is this fantastic one bedroom third floor flat with private balcony. The property boasts secure entry phone system and offers over 500sq ft of internal living space which includes fully fitted kitchen, reception room, bedroom and fitted bathroom.

Metropolitan Court is a recently built private development offering fantastic bus services and popular shops, bars and restaurants on Walm Lane.

## POINTS OF INTEREST

- ONE BEDROOM APARTMENT
- THIRD FLOOR
- WELL PRESENTED THROUGHOUT
- PRIVATE BALCONY
- CLOSE TO AMENITIES
- CLOSE TO WILLESDEN GREEN STATION ZONE 2

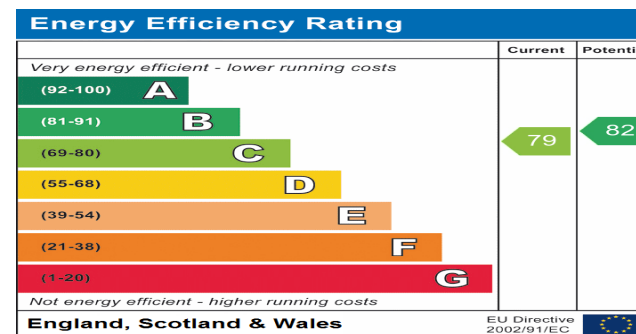

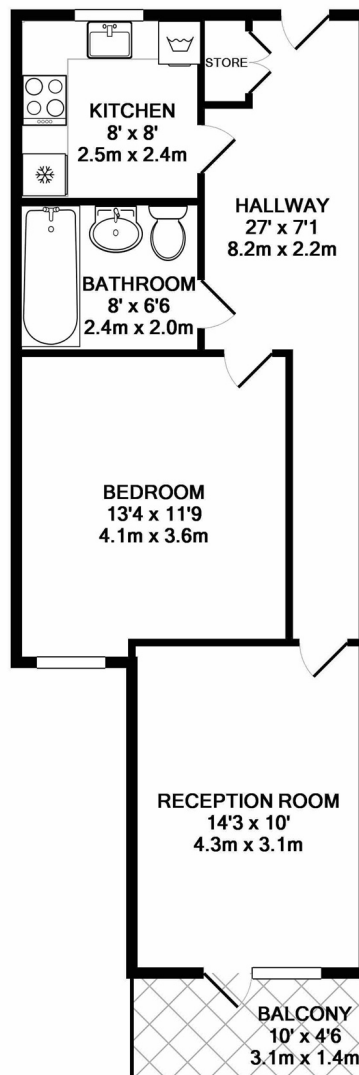

TOTAL APPROX. FLOOR AREA 553 SQ.FT. (51.4 SQ.M.)

Whilst every attempt has been made to ensure the accuracy of the floor plan contained here, measurements of doors, windows, rooms and any other items are approximate and no responsibility is taken for any error, omission, or mis-statement. This plan is for illustrative purposes only and should be used as such by any prospective purchaser. The services, systems and appliances shown have not been tested and no guarantee as to their operability or efficiency can be given