



Golden Willows

Ickleford | Hitchin | Hertfordshire | SG5 3TR

www.stonegate-estates.co.uk



GOLDEN WILLOWS

Property Description

We are delighted to offer for sale this spacious two bedroom detached property which has been modernised and improved throughout.

Benefits include a fitted kitchen, a spacious living room, a shower room and two bedrooms, double glazing and a private garden with views over fields. There is a driveway with two parking spaces.

The property has oil fired heating and sits beautifully in this small and well maintained site. The site has an age restriction of over 50's.

Ickleford is a beautiful village situated on the outskirts of Hitchin town centre and provides its residents with a local shop, highly rated primary school, community centre and a pleasant local community. Just a short distance from Ickleford is Hitchin town centre which offers a further host of popular shops, restaurants, bars and leisure facilities along with convenient access into London, Cambridge and Peterborough via both direct rail link and the A1(m).

£225,000 Freehold (to be confirmed)





Floor Plan

Approx. 64.8 sq. metres (697.4 sq. feet)

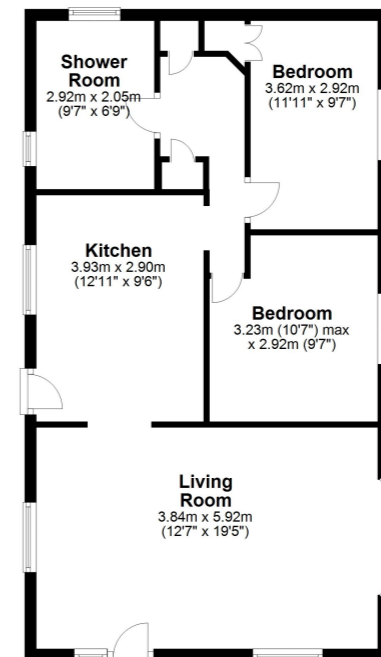

Total area: approx. 64.8 sq. metres (697.4 sq. feet)

All measurements shown are approximate and for guidance only. Garages and workshops are not included in any gross floor areas unless integral to the main building where they will be included.
Plan produced using PlanUp.



- Village Location
- Over 50's
- Mobile Home
- Two Bedrooms
- Double Glazing
- Views to Rear
- Off Road Parking
- Quiet Setting

EPC Rating:

Stonegate Estate Agents

01462 438979

sales@stonegate-estates.co.uk | www.stonegate-estates.co.uk

