

Farriers Road, Stowmarket

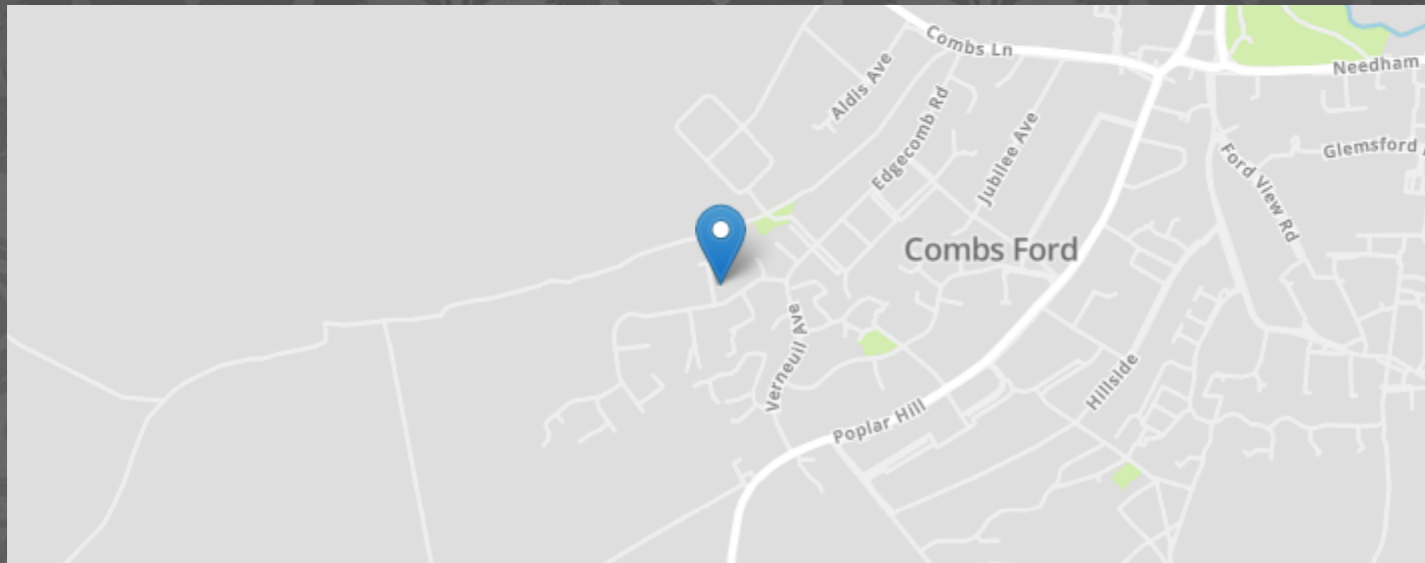

- THREE BEDROOM
- GAS CENTRAL HEATING
- CLOAKROOM
- AIRING CUPBOARD
- GARAGE
- END TERRACE
- FAMILY BATHROOM
- LOUNGE/DINER
- ENCLOSED REAR GARDEN
- OFF ROAD PARKING

MARKS & MANN



Farriers Road, Stowmarket

Marks & Mann Estate Agents are delighted to offer for sale this THREE BEDROOM END TERRACE HOUSE located in Stowmarket. The property benefits from gas central heating, downstairs cloakroom, family bathroom, three bedrooms, lounge/diner, single garage and a driveway which provides off road parking.

MARKS & MANN

7 The Square, Martlesham Heath, Ipswich, Suffolk, IP5 3SL.

01473 396 007

contactipswich@marksandmann.co.uk

Website www.marksandmann.co.uk

£280,000

Farriers Road, Stowmarket

Farriers Road, Stowmarket

Front Garden

Laid to lawn. Path leading to front door.

Hallway

Plastered ceiling, overhead lighting, radiator and carpeted flooring.

Cloakroom

W/C with plastered ceiling, overhead lighting, heated towel rack and carpeted flooring.

Lounge/Diner

6.75m x 2.33m (22' 2" x 7' 8")
Plastered ceiling, overhead lighting, front aspect UPVC double glazed window, rear aspect UPVC double glazed sliding doors, two radiators, a fireplace and carpeted flooring.

Kitchen

2.52m x 2.20m (8' 3" x 7' 3")
Plastered ceiling, overhead lighting, rear aspect UPVC double glazed window, radiator and laminate flooring. Kitchen consists of a range of base and eye level units with integrated sink-drainer and space for a washing machine dishwasher, under counter fridge & freezer and oven.

Landing

Coved and textured ceiling. Loft access. Airing cupboard with wall mounted boiler in.

Bedroom One

3.89m x 2.69m (12' 9" x 8' 10")
Plastered ceiling, overhead lighting, rear aspect UPVC double glazed window, radiator, built in wardrobes and carpeted flooring.

Bedroom Two

2.91m x 2.61m (9' 7" x 8' 7")
Plastered ceiling, overhead lighting, rear aspect UPVC double glazed window radiator and carpeted flooring.

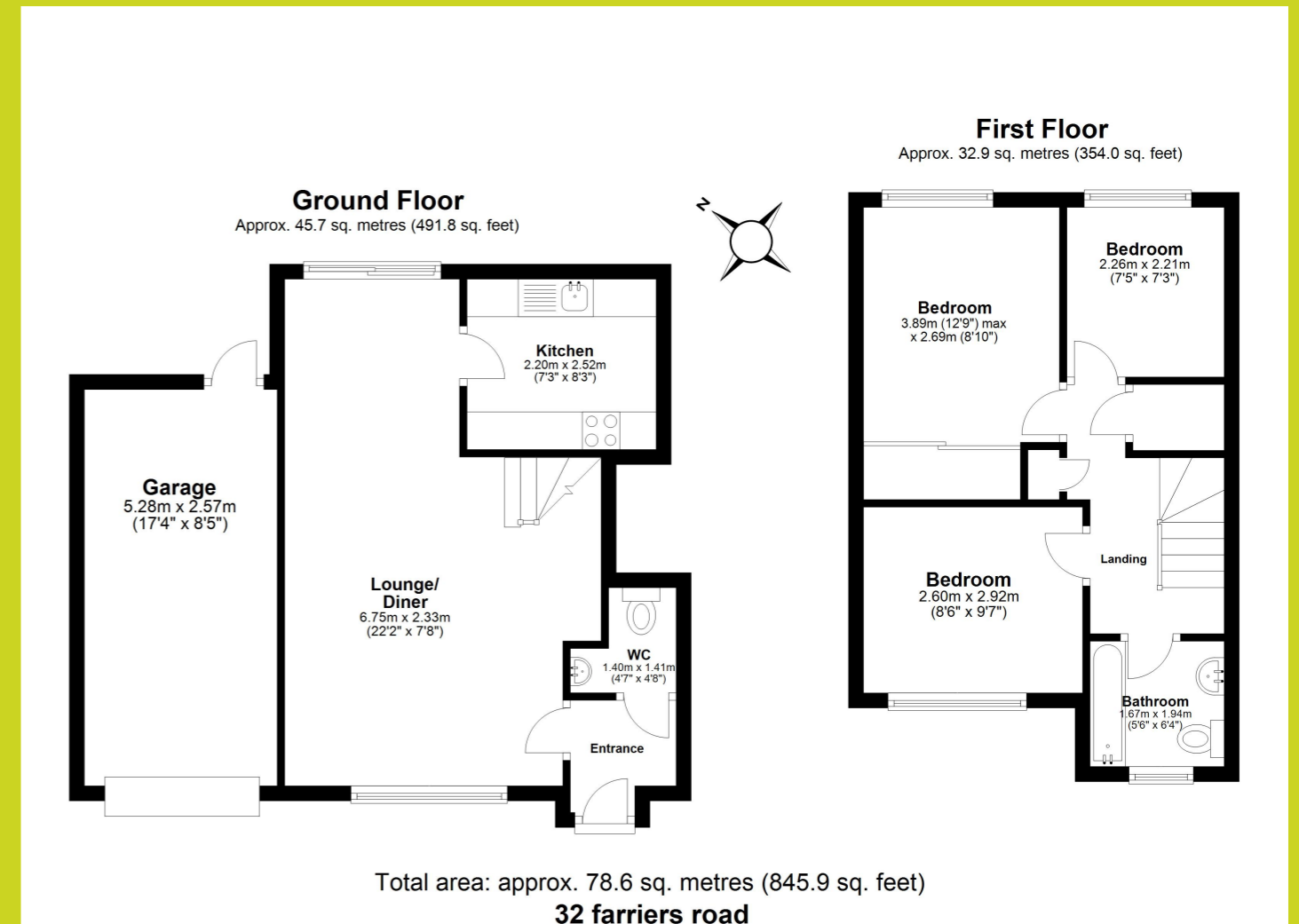

The above floor plans are not to scale and are shown for indication purposes only.

