



10 Watkin Walk, Biggleswade, Bedfordshire, SG18 0BA

£315,000

CLOSE TO TOWN CENTRE AND RAILWAY STATION Three-bedroom terraced property situated in a quiet courtyard cul-de-sac, Offered with a downstairs cloakroom, good sized lounge, kitchen/diner with casement doors overlooking rear garden, three bedrooms all with built in wardrobes and a family bathroom plus EN-SUITE to bedroom 1. Outside is a maintenance free rear garden (artificial grass) and off-road parking is provided by a GARAGE and parking space to the front



# 10 Watkins Walk Biggleswade Beds SG18 0BA

Approximate Gross Internal Area  
721 sq ft - 67 sq m

- THREE BEDROOM TERRACED HOME IN COURTYARD SETTING
- SHORT WALK TO TOWN + RAILWAY STATION
- CLOAKROOM
- GOOD SIZED LOUNGE
- KITCHEN/DINER WITH CASEMENT DOORS TO GARDEN
- FITTED WARDROBES IN ALL BEDROOMS
- EN-SUITE + BATHROOM
- MAINTENANCE FREE GARDEN
- GARAGE + PARKING SPACE

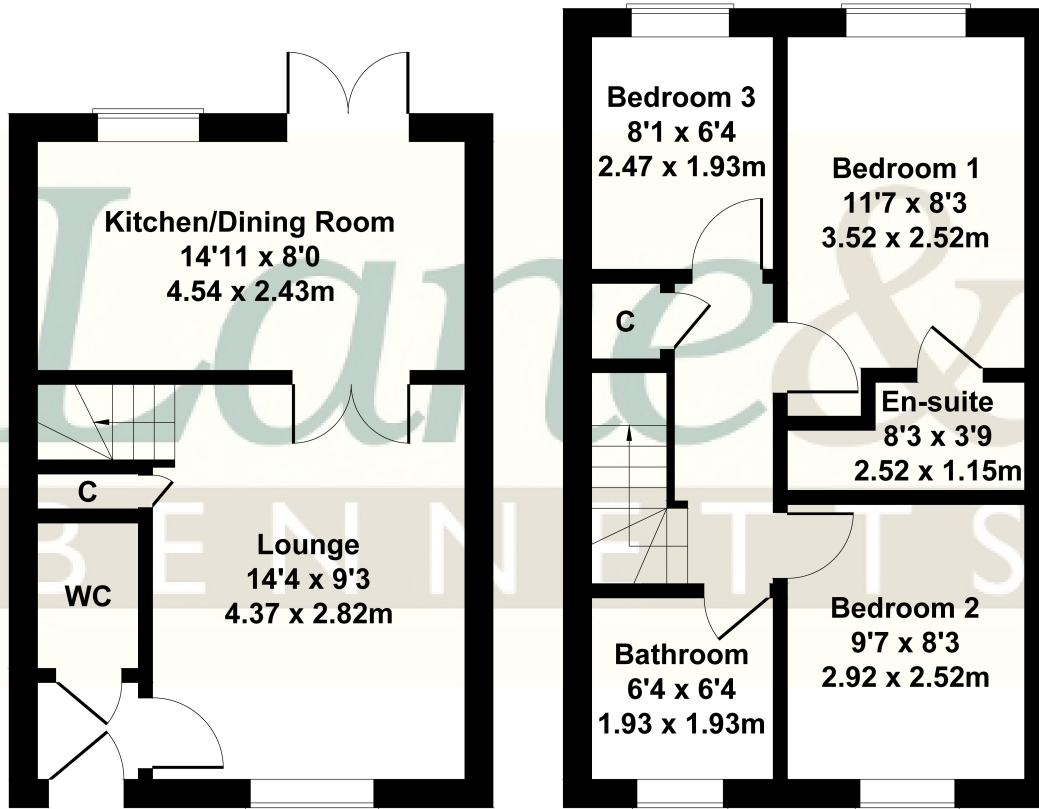

GROUND FLOOR

FIRST FLOOR

Not to Scale. Produced by The Plan Portal 2023  
For Illustrative Purposes Only.

