



*47 Clock Face Road, Clock Face, St Helens,
Merseyside. WA9 4JZ.*

£155,000

Semi Detached Bungalow | Three Bedrooms | Close to all amenities; shops, schools, transport including rail | Gardens front and rear | No Chain | Early Viewing Advised | Tenure TBC | EPC - D |



GROUND FLOOR
778 sq.ft. (72.3 sq.m.) approx.

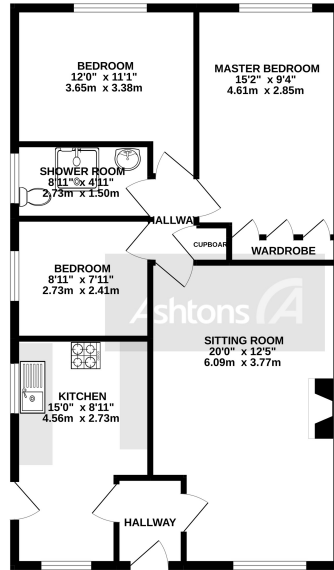

TOTAL FLOOR AREA: 778 sq.ft. (72.3 sq.m.) approx.
While every effort has been made to ensure the accuracy of the floorplan contained here, measurements of plots, windows, rooms and any other areas are approximate and no responsibility is taken for any error, omission or mis-statement. This plan is for illustrative purposes only and should be used as such by any prospective purchaser. The service, quality and specification shown here has not been tested and no guarantee is to be made. Availability of elements can be checked.
Made with Metapic CS22

New to the market is this spacious true bungalow situated on the main Clockface Road.

The property benefits from easy access to a range of amenities including shops, bus routes and major rail networks with the local station just minutes away.

The layout features, entrance to the hallway, spacious sitting room, a fitted kitchen three bedrooms and a three-piece shower room.

Externally the property benefits from gardens to the front and rear. Please contact us for more information, or to secure an essential early viewing call us on 01744 754120.



Contact your local office
to arrange a viewing:

Padgate: 01925 479334
Great Sankey: 01925 454300
Winwick: 01925 232146
Stockton Heath: 01925 453400
St.Helens: 01744 754120
Wigan: 01942 498862
Culcheth: 01925 764744
Ashton-In-Makerfield: 01942 364446
Newton-Le-Willows: 01925 907770
Commercial Office: 01925 907709
Lettings Head Office: 01925 873533
Financial Services: 01925 221234

Ashtons.net rightmove

PrimeLocation.com Zoopla.co.uk

Viewing Arrangements

Viewing is strictly by appointment only through
Ashtons Estate Agency.

Disclaimer Property Details

These particulars, whilst being believed to be accurate are set out as a general outline only for guidance and do not constitute any part of an offer or contract. Intending purchasers should not rely on them as statements of representation of fact, but must satisfy themselves by inspection or otherwise as to their accuracy. We have not carried out a detailed survey nor tested the services, appliances and specific furnishings. The measurements given are approximate.

No person in this firm's employment has the authority to make or give any representation or warranty in respect of the property.

All details, photographs and floorplans are the copyright of Ashtons Estate Agency.

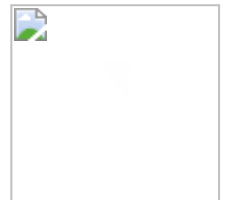

How much you can borrow?
Speak to a mortgage expert in your local office.

Ashtons Financial Services

Ashtons