

Truuli



Bensham Grove, Thornton Heath, Surrey, CR7

£250,000 Leasehold

- Private rear garden
- Large kitchen breakfast room
- Close to local bus stops to get to Crystal Palace
- Easy commute to Brixton underground
- Modern bathroom
- Close to Thornton Heath High Street

2, Lansdowne Road, Croydon, Surrey, CR9 2ER

Tel: 0330 043 0002

Email: save@truuli.co.uk Web: www.truuli.co.uk

Bensham Grove, Thornton Heath, Surrey, CR7

£250,000 Leasehold

A bright spacious first floor flat on Bensham Grove, Thornton Heath with a private garden. The property has been updated in places by the current owner.

Ground Floor Entrance
65 sq. ft. (6.0 m²) approx.

First Floor
520 sq. ft. (47.9 m²) approx.

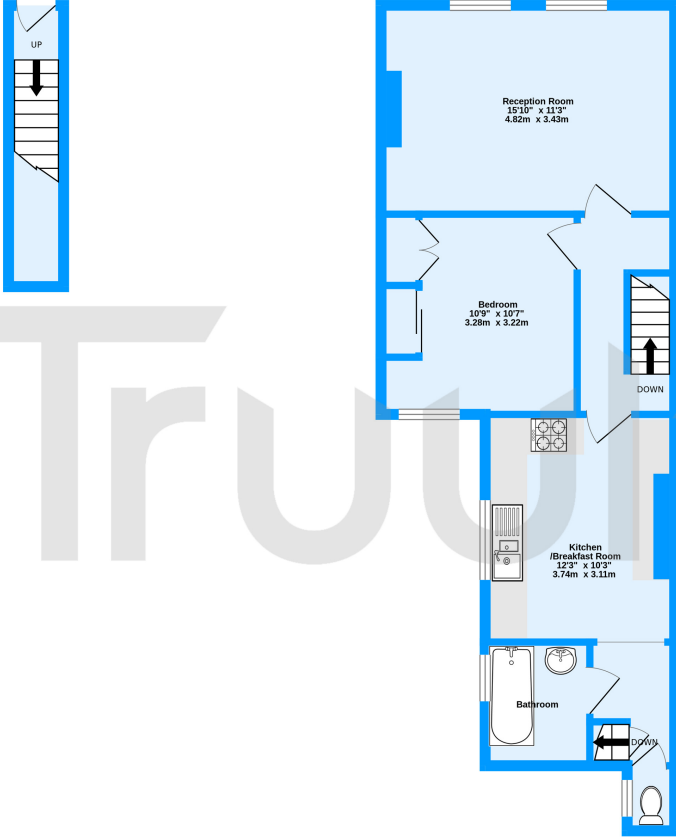

Bensham Grove, Thornton Heath, CR7

TOTAL FLOOR AREA: 587 sq. ft. (54.6 sq. m.) approx.
Measurements are approximate. Not to scale. Illustrative purposes only
Made with Metropix ©2023

