

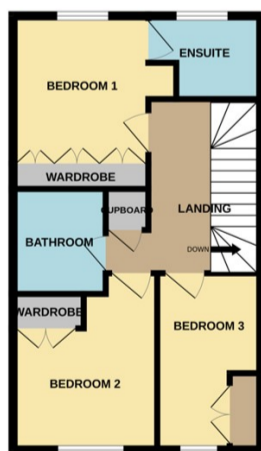

Bourne

£245,000

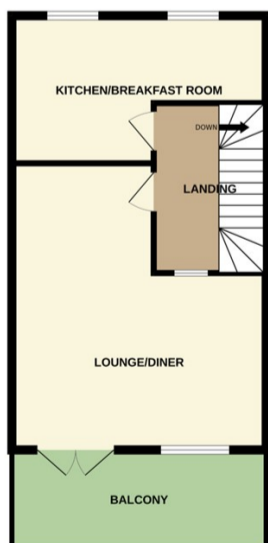
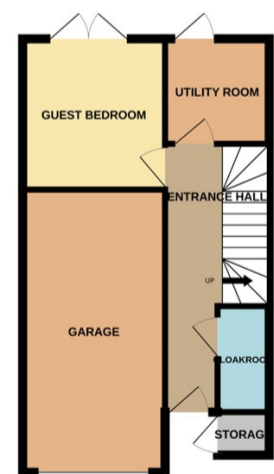

VERY POPULAR LOCATION Rosedale are pleased to offer this three storey town house located within walking distance to Sainsburys and Bourne town centre. This spacious family home has flexibility as well as a fully enclosed rear garden and a garage. The property is spread over three floors with three/four bedrooms main with ensuite, and a family bathroom, there is a good size lounge/diner and kitchen/breakfast. On the ground floor there is a cloakroom, utility, and bedroom 4/study. To fully appreciate this family home viewings are highly recommended. EPC Energy Rating C/Council Tax Band D.