



## Verndale, Glen Road, Laxey, Isle of Man. IM4 7AN

A spacious sympathetically extended and renovated traditional Manx stone cottage located close to harbour and beach.



**£499,000 Freehold**

## PROPERTY DESCRIPTION

---

**ACCOMMODATION** Charming 4-Bedroom Manx Stone Cottage – Nestled in the heart of Laxey on the picturesque Glen Road, this beautifully presented traditional Manx stone cottage blends timeless character with modern comfort. Set within private, mature gardens and just a short stroll from the river, beach, and historic harbour, this unique property offers an exceptional lifestyle opportunity on the Isle of Man. This home offers the perfect balance of countryside charm and coastal living, with easy access to Douglas, excellent local schools, and public transport.

On the ground floor the accommodation briefly comprises of generous open plan lounge/diner, impressive modern dining kitchen/diner. utility room plus family room/snug.

Upstairs there are 3/4 generous bedrooms (two of which are en-suite) plus family bathroom.

The property has been recently renovated and modernised to include a new roof.

## FEATURES

---

- Spacious Renovated Detached Manx Cottage
- Excellent Location close to Harbour and Beach
- Sympathetically Extended to the Rear
- Recently Re Roofed
- Generous Open Plan Lounge/Diner
- Superb Modern Dining Kitchen
- Additional Family Room/Snug
- 3/4 Bedrooms (2 En Suite) plus Family Bathroom
- Mature Private Rear Garden with Decking Area
- Ample Off Road Parking to Front





## Property Images

---



# FLOORPLAN

GROUND FLOOR  
943 sq.ft. (87.6 sq.m.) approx.

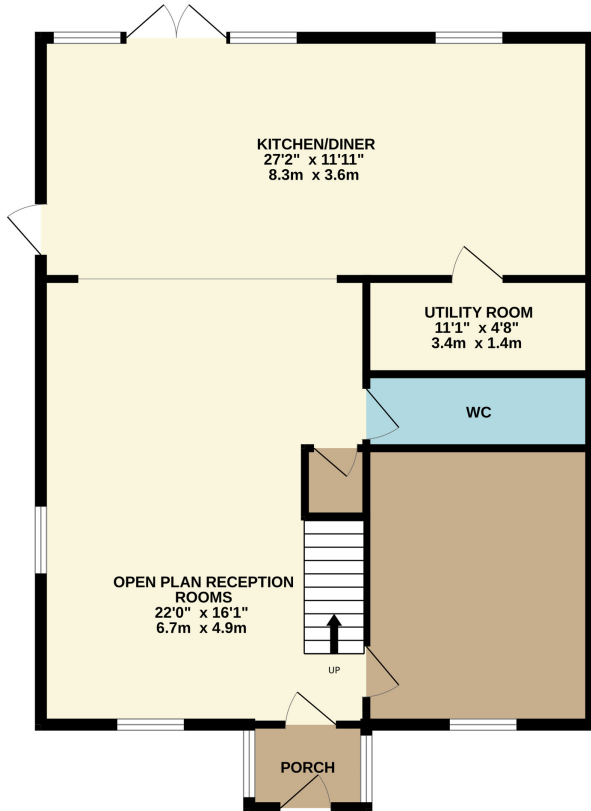

1ST FLOOR  
840 sq.ft. (78.0 sq.m.) approx.

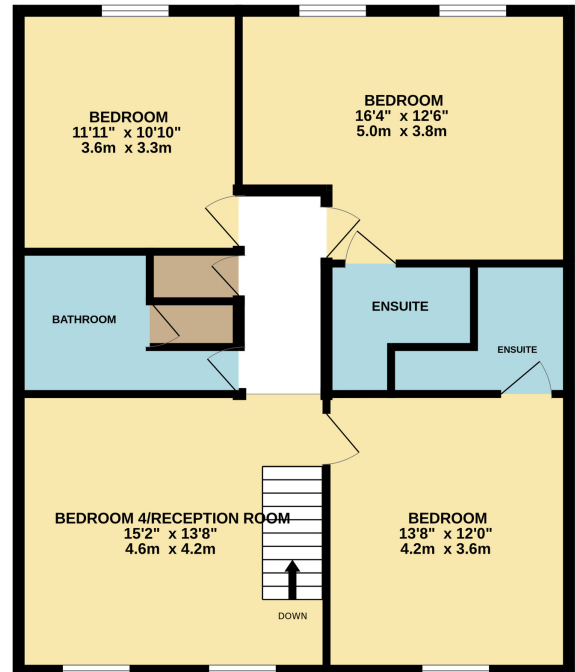

TOTAL FLOOR AREA : 1783 sq.ft. (165.6 sq.m.) approx.

Whilst every attempt has been made to ensure the accuracy of the floorplan contained here, measurements of doors, windows, rooms and any other items are approximate and no responsibility is taken for any error, omission or mis-statement. This plan is for illustrative purposes only and should be used as such by any prospective purchaser. The services, systems and appliances shown have not been tested and no guarantee as to their operability or efficiency can be given.  
Made with Metropix ©2025

**DISCLAIMER:** Whilst Manxmove Ltd believe that these details are correct, neither Manxmove Ltd or their clients guarantee their accuracy in any way. Consequently, these details are not to be used to form part of any legally binding contract. Prospective purchasers or tenants are advised to visit this property to satisfy themselves as to the correctness of these details. Please note, we use wide angle camera lenses in order to show as much of each room as possible. This is not intended to mislead any prospective purchasers or tenants in any way and an honest verbal description is always available prior to viewing if required.