



**Claridge House, Upper Grosvenor Road, Tunbridge Wells,**

**Guide Price £140,000 Leasehold**

- Spacious first floor apartment
- Walking distance to town centre and train station.
- Entryphone security system
- Double glazing
- Electric heating
- EPC:C





A spacious first floor purpose built studio apartment located in a great location ideal for the town centre and mainline railway station. Accommodation comprises of a communal hallway which takes you through to the apartment and its own entrance hallway, living room/bedroom, separate kitchen and bathroom. The property is ideal for first time buyers and investors alike. EPC:C

## Viewing Information

To view this property please contact David Waight at Mother Goose Estate Agency Ltd

## Location

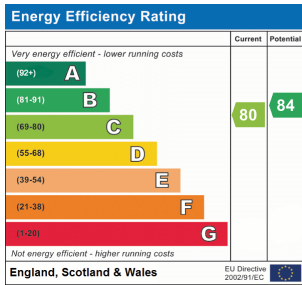

# Upper Grosvenor Road, Tunbridge Wells, TN1

Approximate Area = 355 sq ft / 33 sq m

For identification only - Not to scale

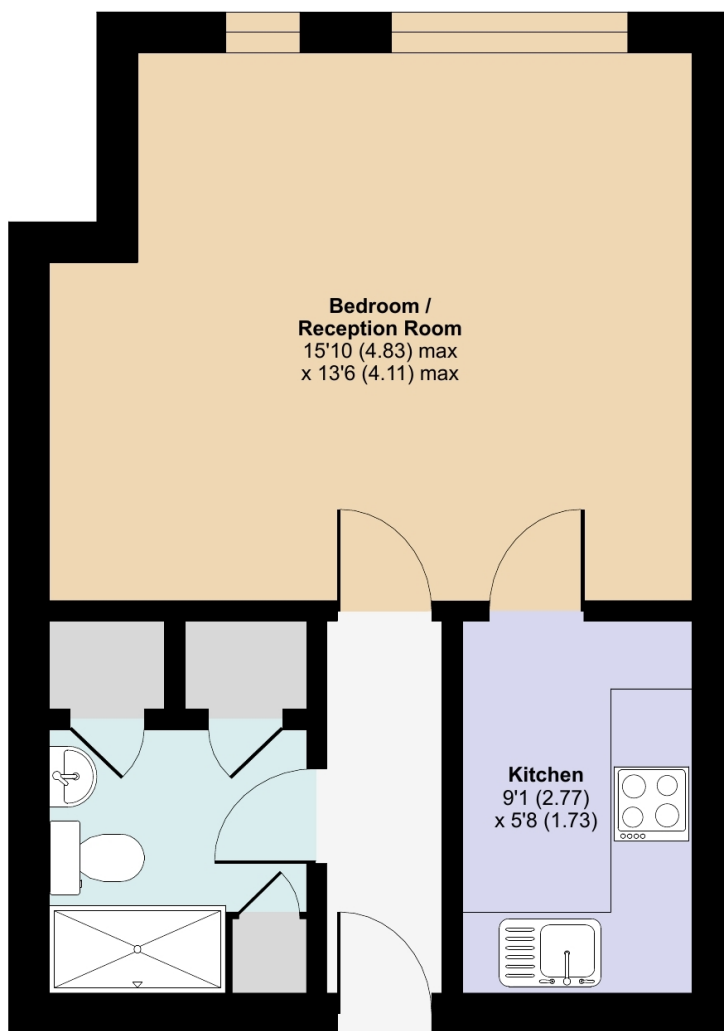

FIRST FLOOR



Floor plan produced in accordance with RICS Property Measurement Standards incorporating International Property Measurement Standards (IPMS2 Residential). © nchecon 2024. Produced for Mother Goose Estate Agency Ltd. REF: 1101913