



- Offered with No Onward Chain
- Well Presented Two Bedroom Terraced House
- Living Room
- Kitchen
- First Floor Shower Room
- Private Rear Garden
- Close To Shops And Amenities
- Walking To Town & Railway Station
- Viewing Advised

136 Magdalen Street, Colchester, Essex. CO1 2LF.

Located within close proximity to Colchester town centre & mainline railway station with direct links to London Liverpool Street is this very well presented terraced house offering living room, modern fitted kitchen, two sizeable bedrooms and newly fitted first floor shower room. To the rear there is private garden and the parking is located on the road with bays in front of the property. Offered with no onward chain internal inspection is essential.



Property Details.

Ground Floor

Entrance Porch

Door leading to living room.

Living Room



11' 6" x 11' 9" (3.51m x 3.58m) Double glazed window to front aspect, T.V & phone points, radiator.

Kitchen



7' 5" x 11' 7" (2.26m x 3.53m) Double glazed window to rear aspect, door leading to garden, a range of wall and base units over an area of roll edge work tops, inset stainless steel sink & drainer unit, electric oven with electric hob over, plumbing for a washing machine, space for fridge freezer, radiator, stairs leading to first floor.

First Floor

Landing

Loft access, doors leading to;

Property Details.

Bedroom One



10' 4" x 8' 7" (3.15m x 2.62m) Double glazed window to front aspect, built in wardrobe, radiator.

Bedroom Two



7' 6" x 8' 9" (2.29m x 2.67m) Double glazed window to rear aspect, radiator, built in wardrobe.

Shower Room



Low level WC, wash hand basin, fully tiled shower cubical with electric power shower, ceiling light tunnel, chrome heated towel rail.

Garden



The rear garden comprises of shingled areas, patio area and enclosed by panel fencing.

Property Details.

Floorplans

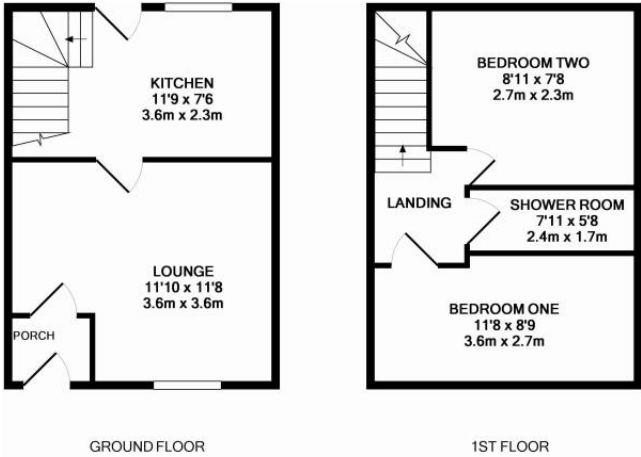

Whilst every attempt has been made to ensure the accuracy of the floor plan contained here, measurements of doors, windows, rooms and any other items are approximate and no responsibility is taken for any error, omission, or mis-statement. This plan is for illustrative purposes only and should be used as such by any prospective purchaser. The services, systems and appliances shown have not been tested and no guarantee as to their operability or efficiency can be given.
Made with Metropix ©2015

Location



Energy Ratings

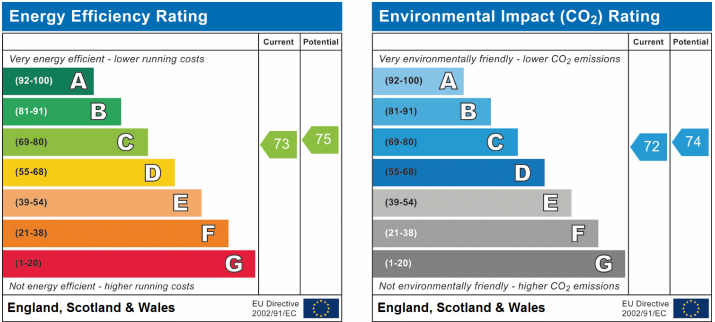

We have not carried out a structural survey and the services, appliances and specific fittings have not been tested. All photographs, measurements, floor plans and distances referred to are given as a guide only and should not be relied upon for the purchase of carpets or any other fixtures or fittings. Gardens, roof terraces, balconies and communal gardens as well as tenure and lease details cannot have their accuracy guaranteed for intending purchasers. Lease details, service ground rent (where applicable) are given as a guide only and should be checked and confirmed by your solicitor prior to exchange of contracts.