



## Powis Court, Potters Bar, Hertfordshire, EN6

**£549,950**

- **FOUR BEDROOMS**
- **OPEN PLAN KITCHEN / DINING ROOM**
- **DOWNSTAIRS CLOAKROOM**
- **STUNNING SOUTH EASTERLY VIEWS TO THE REAR**
- **CLOSE TO M25 AND A1(M)**
- **OFF STREET PARKING**
- **SPACIOUS LOUNGE**
- **GOOD SIZE BEDROOMS**
- **QUIET CUL-DE-SAC**

# Powis Court, Potters Bar, Hertfordshire, . EN6

## £549,950 Freehold

This EXTENDED THREE / FOUR BEDROOM Mid terraced family home with off street parking is located on this quiet cul-de-sac off Barnet Road, moments from shops, and the M25. The property benefits from a rear extension with modern fitted kitchen diner, spacious lounge and a converted garage currently used as guest bedroom, and downstairs guest cloakroom. The first floor consists of three bedrooms, and a bathroom, whilst externally the property has a private rear garden, lawn and stunning south easterly views over fields.

Powis Court is a quiet cul-de-sac located off Byers Close, which leads off Barnet Road (A1000)

Walking distance to local shops and Potters Bar High Street

1 mile to Potters Bar Mainline station which provides a fast and frequent service to Kings Cross ( 17 minutes )and Moorgate.

GROUND FLOOR  
685 sq.ft. (63.6 sq.m.) approx.

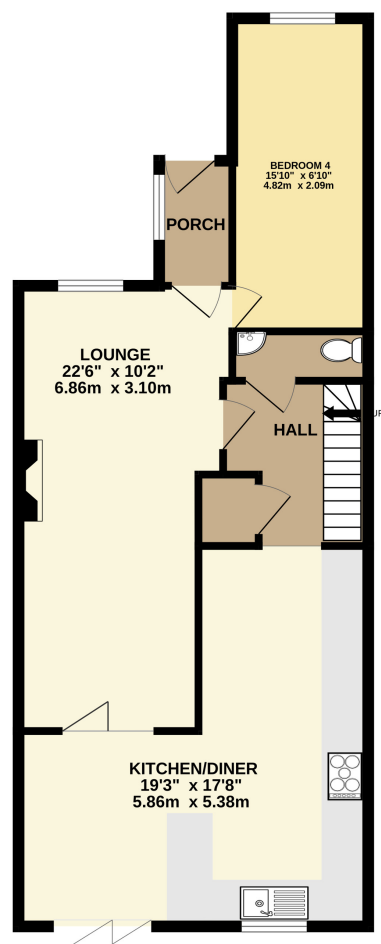

1ST FLOOR  
432 sq.ft. (40.1 sq.m.) approx.

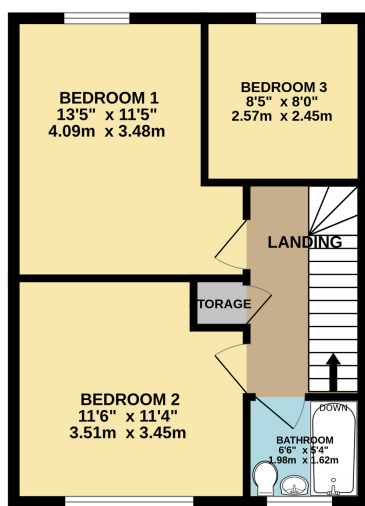

TOTAL FLOOR AREA : 1117 sq.ft. (103.7 sq.m.) approx.

Whilst every attempt has been made to ensure the accuracy of the floorplan contained here, measurements of doors, windows, rooms and any other items are approximate and no responsibility is taken for any error, omission or mis-statement. This plan is for illustrative purposes only and should be used as such by any prospective purchaser. The services, systems and appliances shown have not been tested and no guarantee as to their operability or efficiency can be given.  
Made with Metropix ©2023

